

Sealed Bid Auction

Jasper County, Indiana



137.5 +/- ACRES TOTAL

JASPER COUNTY, INDIANA

Listing # CS2137137AU

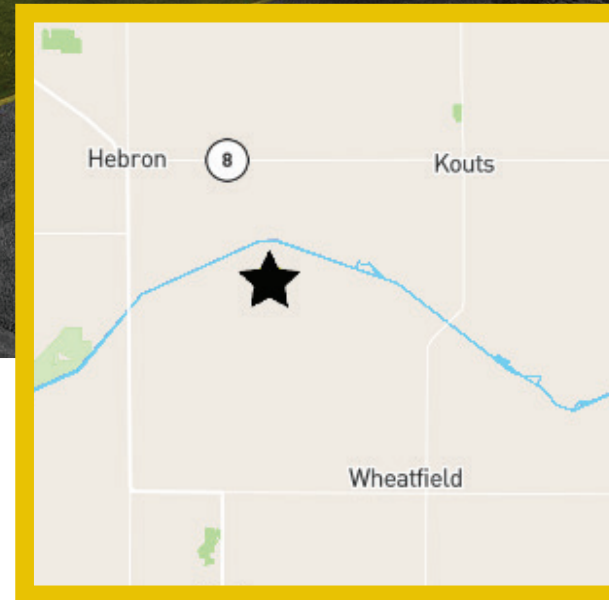

137.5+ / - ACRES

JASPER COUNTY, INDIANA

121.71 FSA Cropland Acres

Surety WAPI 129.3

Lease Open for 2022

Excellent Frontage on 1800 N & 400 W

Excellent Investment Opportunity

FOR MORE INFORMATION CONTACT:

Craig Stevenson

(574) 870-4383

Craig@Gfarmland.com



Stay up to date with local land sales & auctions
Download our app today!
Search "Geswein Auctions"

GESWEIN

FARM & LAND

Indiana
 Jasper
 Report ID: FSA-156EZ

U.S. Department of Agriculture
 Farm Service Agency
 Abbreviated 156 Farm Record

FARM: 4106
 Prepared: 6/28/21 10:10 AM
 Crop Year: 2021
 Page: 1 of 2

DISCLAIMER: This is data extracted from the web farm database. Because of potential messaging failures in MIDAS, this data is not guaranteed to be an accurate and complete representation of data contained in the MIDAS system, which is the system of record for Farm Records.

Operator Name: J & J AG INC
 Farm Identifier: RE98 DIV 1239 INTO 4106/4107

Farms Associated with Operator:
 None

ARC/PLC G/IF Eligibility: Eligible

CRP Contract Number(s): None

Farmland	Cropland	DCP Cropland	WBP	WRP	EWP	CRP Cropland	GRP	Farm Status	Number of Tracts
126.7	121.71	121.71	0.0	0.0	0.0	0.0	0.0	Active	1
State Conservation	Other Conservation	Effective DCP Cropland	Double Cropped	MPL/FWP					
0.0	0.0	121.71	0.0	0.0					

ARC/PLC					
PLC	ARC-CO	ARC-IC	PLC-Default	ARC-CO-Default	ARC-IC-Default
NONE	CORN , SOYBN	NONE	NONE	NONE	NONE

Crop	Base Acreage	PLC Yield	CCC-505 CRP Reduction	HIP
CORN	90.0	183	0.00	0
SOYBEANS	30.0	53	0.00	0
Total Base Acres:	120.0			

Tract Number: 16923 Description: S32 T33N R6W
 FSA Physical Location: Jasper, IN ANSI Physical Location: Jasper, IN
 BIA Range Unit Number:
 HEL Status: NHEL: no agricultural commodity planted on undetermined fields
 Wetland Status: Wetland determinations not complete
 WL Violations: None

Farmland	Cropland	DCP Cropland	WBP	WRP	EWP	CRP Cropland	GRP
126.7	121.71	121.71	0.0	0.0	0.0	0.0	0.0
State Conservation	Other Conservation	Effective DCP Cropland	Double Cropped	MPL/FWP			
0.0	0.0	121.71	0.0	0.0			

Crop	Base Acreage	PLC Yield	CCC-505 CRP Reduction
CORN	90.0	183	0.00
SOYBEANS	30.0	53	0.00
Total Base Acres:	120.0		

Owners: JABAAY FAMILY FARMS LLC

Indiana
Jasper

U.S. Department of Agriculture
Farm Service Agency
Abbreviated 156 Farm Record

FARM: 4106
Prepared: 6/28/21 10:10 AM
Crop Year: 2021
Page: 2 of 2

Report ID: FSA-156EZ

DISCLAIMER: This is data extracted from the web farm database. Because of potential messaging failures in MIDAS, this data is not guaranteed to be an accurate and complete representation of data contained in the MIDAS system, which is the system of record for Farm Records.

Other Producers: None

USDA Farm 4106 Tract 16923

Administered by: Jasper County, Indiana

OP: J & J AG INC

OW: JABAAY FAMILY FARMS LLC

Source: Primarily USDA NAIP 2020 imagery; IDHS or Dynamap roads; FSA data 2021-04-20 07:06:50

2021 Certification map prepared on: 4/20/2021

126.7 Tract acres

121.71 Cropland acres

0 CRP acres

Shares:

CRP

CLU

Wetland Determination Identifiers:

● Restricted Use

TRS: 33N6W32

▼ Limited Restrictions

Jasper Co., IN

■ Exempt from Conservation Compliance Provisions

Provisions

Crops are non-irrigated, intended use is grain, and types are YEL (corn), COM (soybeans), and SRW (wheat) unless noted.

COUNTY RD 1800 N

COUNTY RD 400 W

CLU	Acres	HEL	LC	Contract	Prac	Yr	C I
1	121.71	N	2				Y

Crop:

Date:



USDA FSA maps are for FSA program administration only. This map does not represent a legal survey or reflect actual ownership; rather it depicts information provided directly from the producer and/or NAIP imagery. The producer accepts the data 'as is' and assumes all risks associated with its use. The USDA Farm Service Agency assumes no responsibility for actual or consequential damage incurred as a result of any user's reliance on this data outside FSA programs. Wetland identifiers do not represent the size, shape, or specific determination of the area. Refer to your original determination (CPA-026 and attached maps) for exact boundaries and determinations or contact NRCS

Soils Map

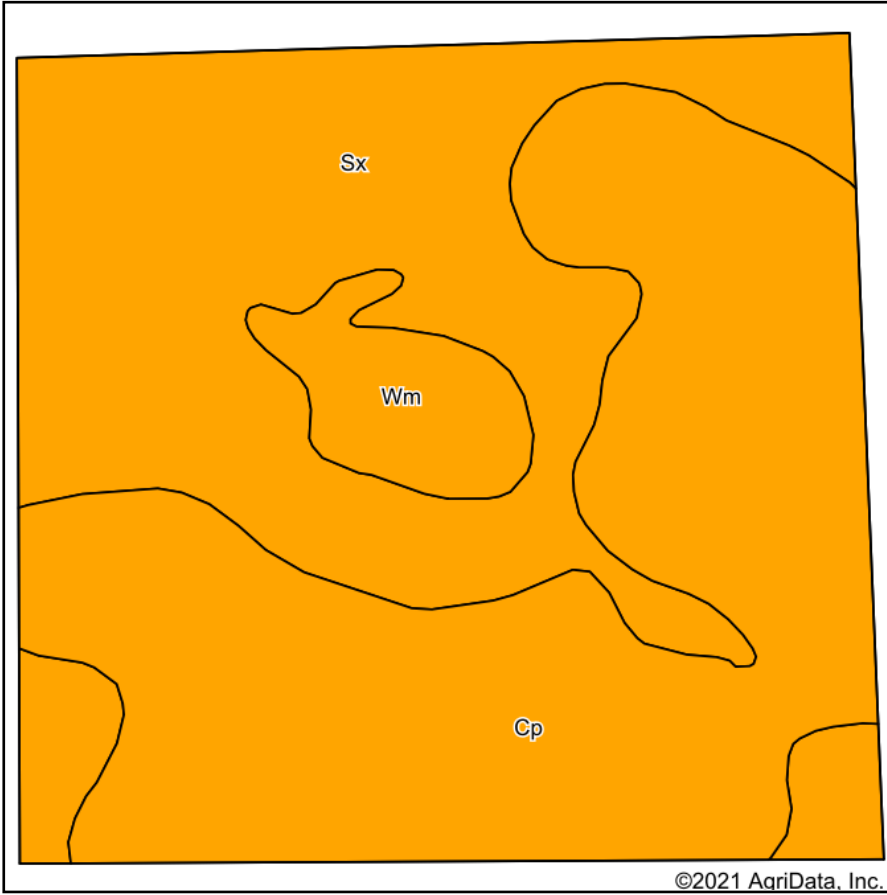

Soils data provided by USDA and NRCS.

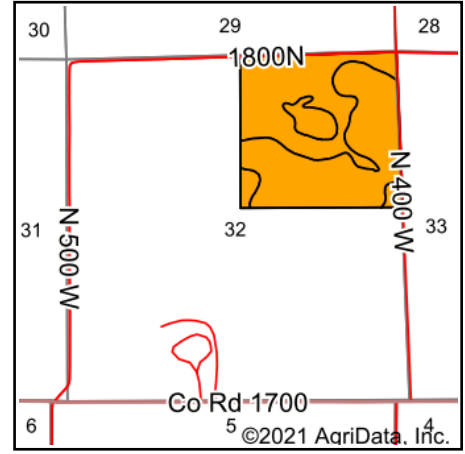

State: **Indiana**
 County: **Jasper**
 Location: **32-33N-6W**
 Township: **Wheatfield**
 Acres: **134.48**
 Date: **9/10/2021**

GESWEIN
FARM & LAND

Maps Provided By:



Area Symbol: IN073, Soil Area Version: 21

Code	Soil Description	Acres	Percent of field	Non-Irr Class Legend	Water Table	Non-Irr Class *c	Corn	Grass legume hay	Pasture	Soybeans	Winter wheat	*n NCCPI Overall	*n NCCPI Corn	*n NCCPI Soybeans
Cp	Craigmile sandy loam, frequently flooded	68.78	51.1%		0.2ft.	Illw	125			25		47	31	47
Sx	Suman loam, frequently flooded	58.41	43.4%		0ft.	Illw	135			35		61	34	61
Wm	Watseka-Maumee loamy sands	7.29	5.4%		0.5ft.	Ills	125	4	8	29	53	53	53	37
Weighted Average							129.3	0.2	0.4	29.6	2.9	*n 53.4	*n 33.5	*n 52.5

*n: The aggregation method is "Weighted Average using all components"

*c: Using Capabilities Class Dominant Condition Aggregation Method

Soils data provided by USDA and NRCS.

Topography Contours



©2021 AgriData, Inc.

GESWEIN
FARM & LAND

Maps Provided By:
surety
CUSTOMIZED ONLINE MAPPING
© AgriData, Inc. 2021 www.AgriDataInc.com

Source: USGS 10 meter dem
Interval(ft): 3.0
Min: 642.9
Max: 653.5
Range: 10.6
Average: 649.7
Standard Deviation: 1.02 ft

0ft 412ft 824ft



9/10/2021

32-33N-6W
Jasper County
Indiana

Map Center: 41° 16' 16.58, -87° 7' 34.27

Field borders provided by Farm Service Agency as of 5/21/2008.

4 Year Crop History



Owner/Operator:

Address:

Address:

Phone:

Date:

Farm Name:

Field ID:

Acct. #:

Crop Year:

Crop Year:

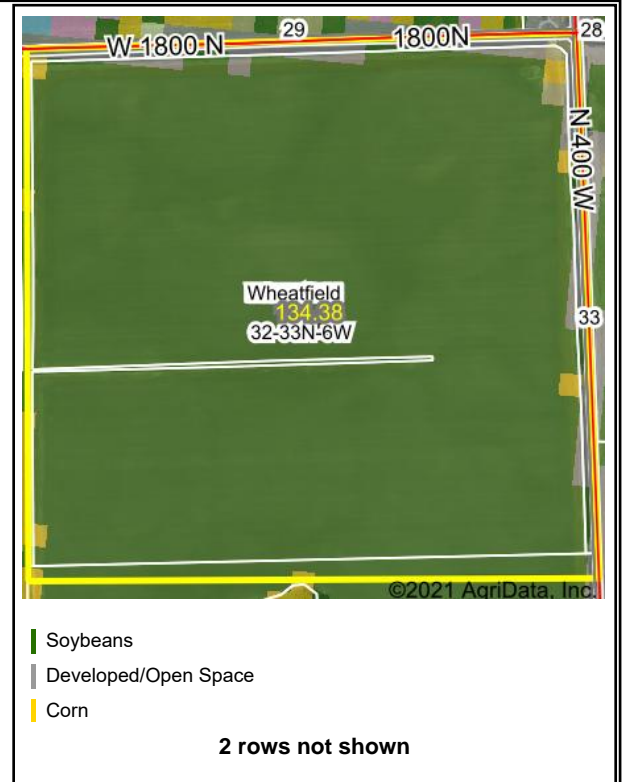

Crop Year:

Crop Year:

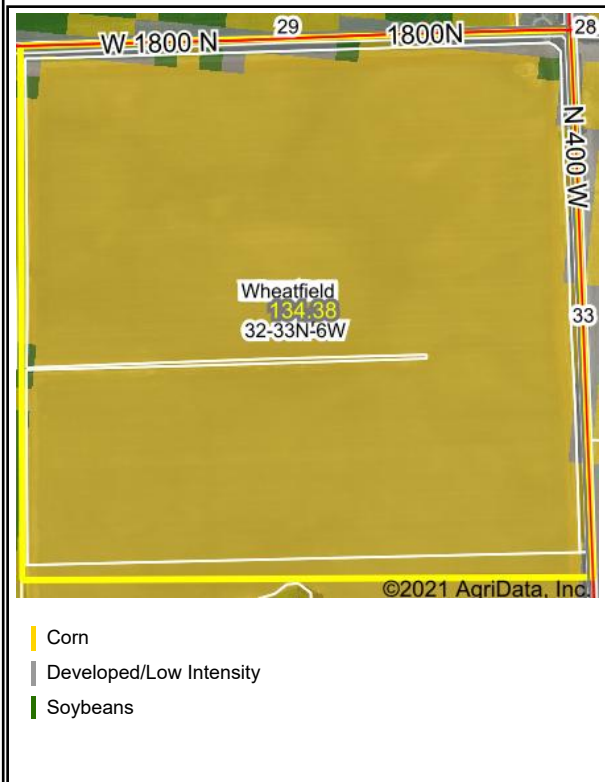

Map Center: 41° 16' 16.58, -87° 7' 34.27

State: IN

County: Jasper

Legal: 32-33N-6W

Twnshp: Wheatfield

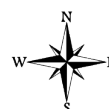

Maps Provided By:



© AgriData, Inc. 2021

www.AgriDataInc.com