

Soils Map

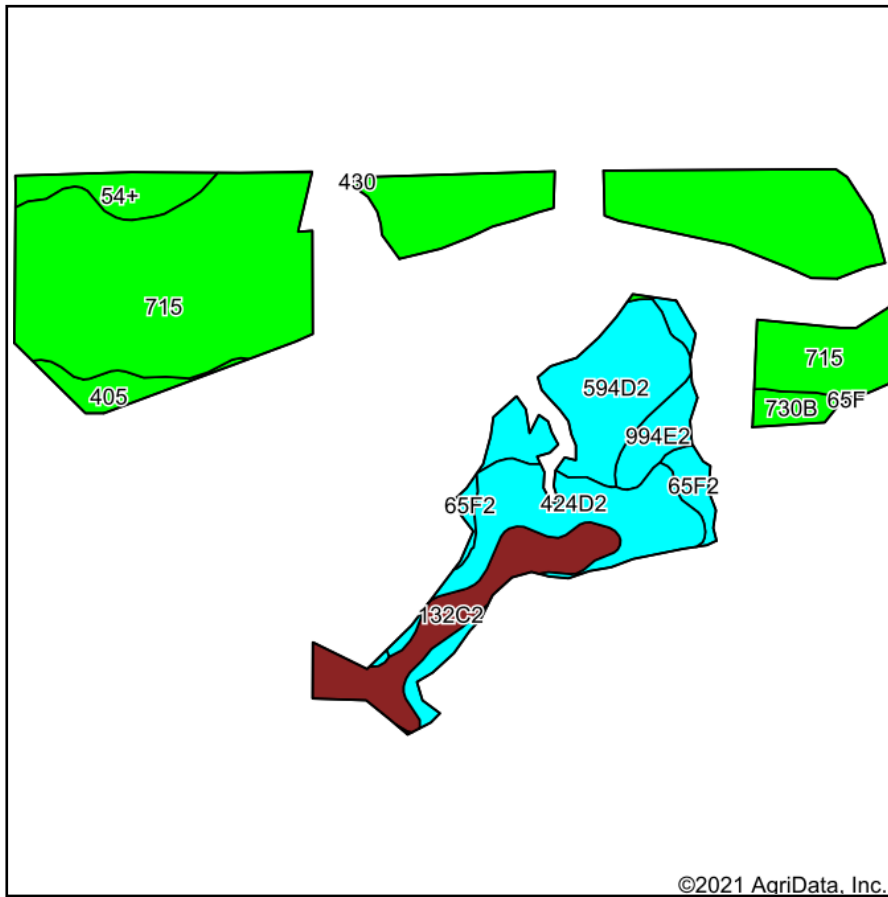

Soils data provided by USDA and NRCS.

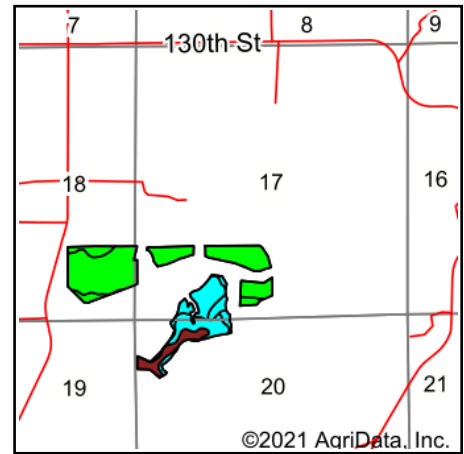

State: **Iowa**
 County: **Davis**
 Location: **17-70N-14W**
 Township: **Soap Creek**
 Acres: **76.43**
 Date: **7/12/2021**

Hawkeye Farm Mgmt & Real Estate



22 N Main, Albia IA Phone: 641-932-7796
 Email: hawkeye@uciowa.com
 On the web: www.uciowa.com
www.iowawhitetailfarms.com

Maps Provided By:



Area Symbol: IA051, Soil Area Version: 27

Code	Soil Description	Acres	Percent of field	CSR2 Legend	Non-Irr Class *c	CSR2**	CSR	*n NCCPI Soybeans
715	Nodaway-Amana silt loams, 0 to 2 percent slopes	43.29	56.6%		IIw	81	85	82
424D2	Lindley-Keswick loams, 9 to 14 percent slopes, moderately eroded	8.57	11.2%		IVe	27	15	50
594D2	Galland loam, heavy loess, 9 to 14 percent slopes, moderately eroded	8.39	11.0%		IVe	19	5	51
132C2	Weller silty clay loam, 5 to 9 percent slopes, moderately eroded	6.29	8.2%		IIIe	59	40	69
54+	Zook silt loam, heavy till, 0 to 2 percent slopes, occasionally flooded, overwash	2.78	3.6%		IIw	68	75	73
994E2	Douds-Galland loams, 14 to 18 percent slopes, moderately eroded	2.48	3.2%		VIe	22	5	44
405	Floris silt loam, 0 to 2 percent slopes	1.77	2.3%		IIw	66	55	69
65F2	Lindley loam, 18 to 25 percent slopes, moderately eroded	1.63	2.1%		VIIe	10	8	38
730B	Nodaway-Cantril complex, 0 to 5 percent slopes	1.23	1.6%		IIw	77	61	84
Weighted Average						62	59	*n 71.2

**IA has updated the CSR values for each county to CSR2.

*n: The aggregation method is "Weighted Average using all components"

*c: Using Capabilities Class Dominant Condition Aggregation Method

Soils data provided by USDA and NRCS.