

# Soils Map

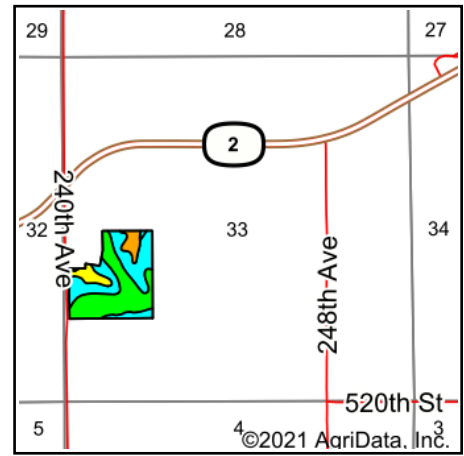

State: **Iowa**  
 County: **Appanoose**  
 Location: **33-69N-17W**  
 Township: **Sharon**  
 Acres: **32.62**  
 Date: **9/23/2021**

**Hawkeye Farm Mgmt & Real Estate**

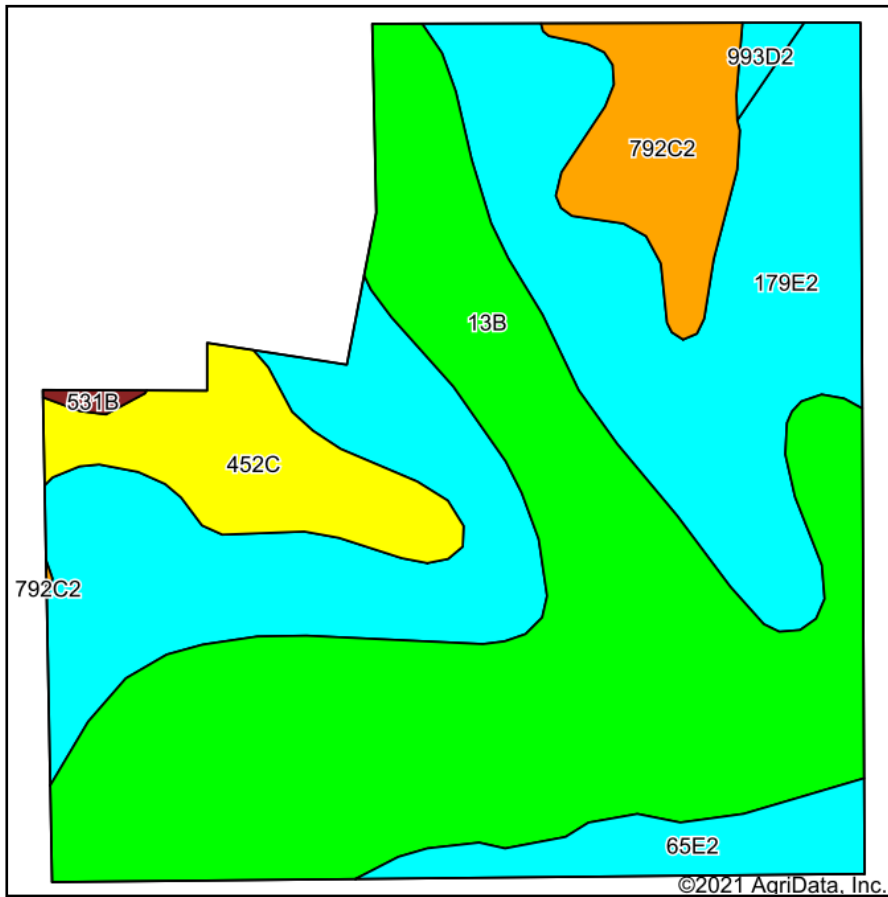

22 N Main, Albion IA Phone: 641-932-7796  
 Email: hawkeye@uciowa.com  
 On the web: www.uciowa.com;  
 www.iowawhitetailfarms.com

Maps Provided By:



Area Symbol: IA007, Soil Area Version: 27

Code	Soil Description	Acres	Percent of field	CSR2 Legend	Non-Irr Class *c	CSR2**	CSR	*n NCCPI Soybeans
13B	Olmitz-Vesser-Colo complex, 2 to 5 percent slopes	14.25	43.7%		IIw	79	68	80
179E2	Gara loam, 14 to 18 percent slopes, moderately eroded	12.32	37.8%		VIe	24	33	45
452C	Lineville silt loam, 5 to 9 percent slopes	2.34	7.2%		IIIe	48	35	60
792C2	Armstrong loam, 5 to 9 percent slopes, moderately eroded	2.04	6.3%		IIIe	31	26	48
65E2	Lindley loam, 14 to 18 percent slopes, moderately eroded	1.41	4.3%		VIe	29	28	55
993D2	Armstrong-Gara loams, 9 to 14 percent slopes, moderately eroded complex	0.17	0.5%		IVe	22	20	47
531B	Kniffin silt loam, 2 to 5 percent slopes	0.09	0.3%		IIIe	55	58	67
Weighted Average						50.5	47.8	*n 62.1

\*\*IA has updated the CSR values for each county to CSR2.

\*n: The aggregation method is "Weighted Average using all components"

\*c: Using Capabilities Class Dominant Condition Aggregation Method

Soils data provided by USDA and NRCS.