

Soils Map

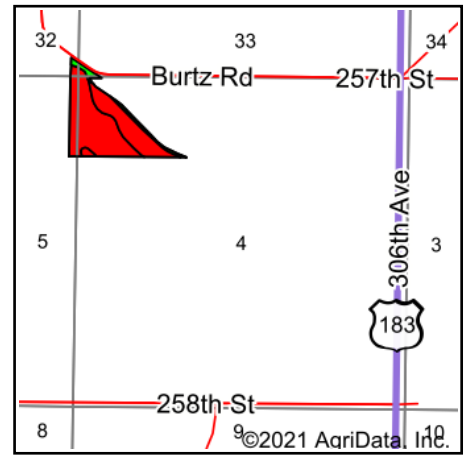

Soils data provided by USDA and NRCS.



State: **South Dakota**
 County: **Tripp**
 Location: **4-102N-77W**
 Township: **Greenwood**
 Acres: **31.14**
 Date: **10/19/2021**



Maps Provided By:



Area Symbol: SD123, Soil Area Version: 21

Code	Soil Description	Acres	Percent of field	PI Legend	Non-Irr Class *c	Irr Class *c	Productivity Index	Grain sorghum Bu
S502E	Sansarc-Opal clays, 9 to 25 percent slopes	18.95	60.9%		VIIe	VIIe	21	
OsE	Opal-Sansarc clays, 6 to 15% slopes	9.50	30.5%		VIe	VIe	38	
LoA	Lowry silt loam, 0 to 3 percent slopes	2.17	7.0%		IIc	IIc	91	
WeE	Westover loam, 9 to 25 percent slopes	0.52	1.7%		VIe		20	1
Weighted Average					6.33	6.23	31	*-

*c: Using Capabilities Class Dominant Condition Aggregation Method
 Soils data provided by USDA and NRCS.