

# Soils Map

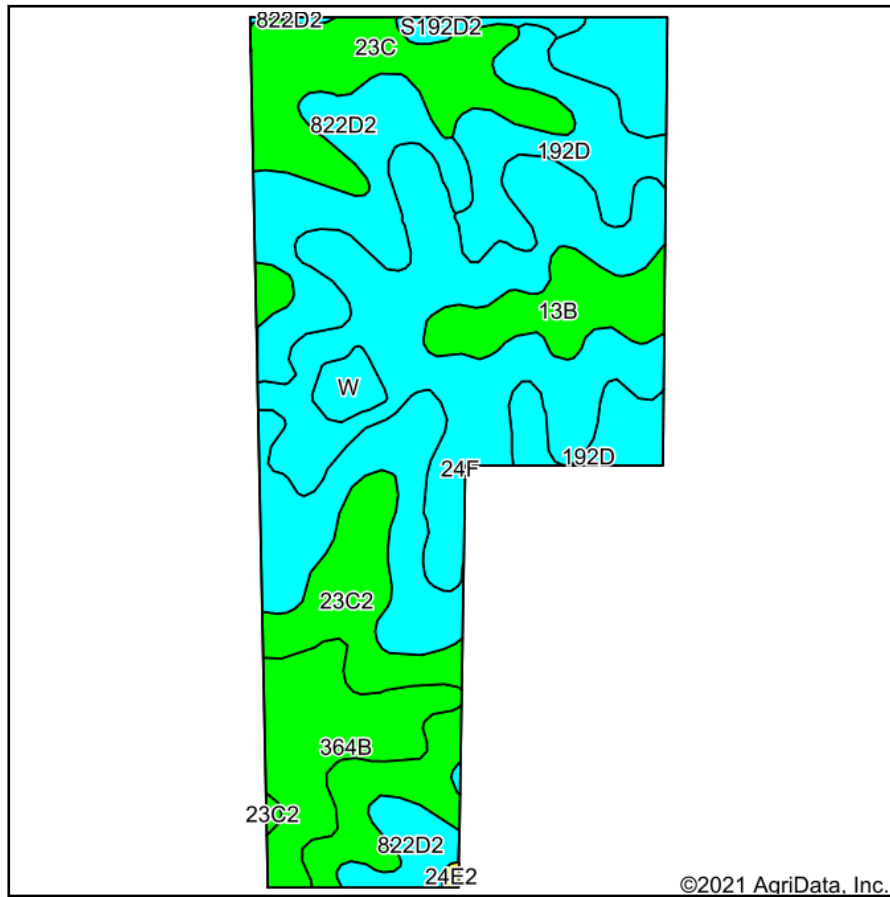

Soils data provided by USDA and NRCS.

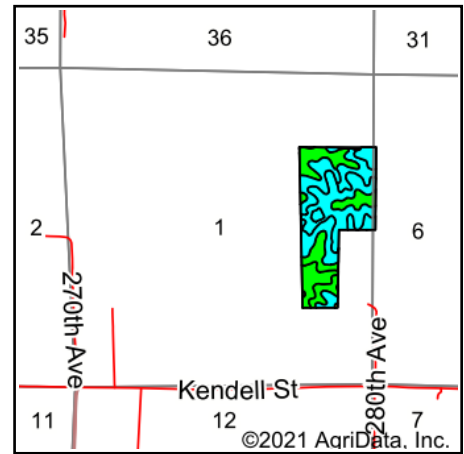

State: **Iowa**  
 County: **Clarke**  
 Location: **1-72N-25W**  
 Township: **Osceola**  
 Acres: **60**  
 Date: **12/1/2021**

**Hawkeye Farm Mgmt & Real Estate**



22 N Main, Albion IA Phone: 641-932-7796  
 Email: hawkeye@uciowa.com  
 On the web: www.uciowa.com  
 www.iowawhitetailfarms.com

Maps Provided By:



© AgriData, Inc. 2021

www.AgriDataInc.com



Area Symbol: IA039, Soil Area Version: 27

Code	Soil Description	Acres	Percent of field	CSR2 Legend	Non-Irr Class *c	CSR2**	CSR	*n NCCPI Soybeans
24F	Shelby loam, 18 to 25 percent slopes	17.34	28.9%		Vle	23	15	46
822D2	Lamoni clay loam, 9 to 14 percent slopes, moderately eroded	12.98	21.6%		IVe	11	15	45
23C2	Arispe silty clay loam, 5 to 9 percent slopes, moderately eroded	6.75	11.2%		IIIe	62	50	69
192D	Adair loam, heavy till, 9 to 14 percent slopes	6.53	10.9%		IVe	16	20	49
23C	Arispe silty clay loam, 5 to 9 percent slopes	6.49	10.8%		IIIe	66	55	72
364B	Grundy silty clay loam, 2 to 5 percent slopes	5.00	8.3%		Ile	72	75	69
13B	Olmitz-Zook-Colo complex, 0 to 5 percent slopes	3.39	5.6%		IIw	77	60	73
W	Water	0.82	1.4%			0	0	
S192D2	Adair clay loam, heavy till, 9 to 14 percent slopes, moderately eroded	0.62	1.0%		IVe	9		45
24E2	Shelby clay loam, 14 to 18 percent slopes, moderately eroded	0.08	0.1%		IVe	40	33	51
<b>Weighted Average</b>					<b>4.02</b>	<b>35.4</b>	<b>*-</b>	<b>*n 54.3</b>

\*\*IA has updated the CSR values for each county to CSR2.

\*- CSR weighted average cannot be calculated on the current soils data, use prior data version for csr values.

\*n: The aggregation method is "Weighted Average using all components"

\*c: Using Capabilities Class Dominant Condition Aggregation Method

Soils data provided by USDA and NRCS.