

# Soils Map

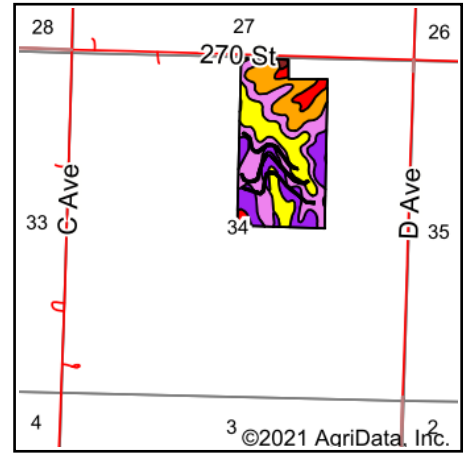

State: **Iowa**  
 County: **Montgomery**  
 Location: **34-71N-39W**  
 Township: **West**  
 Acres: **75.84**  
 Date: **12/22/2021**

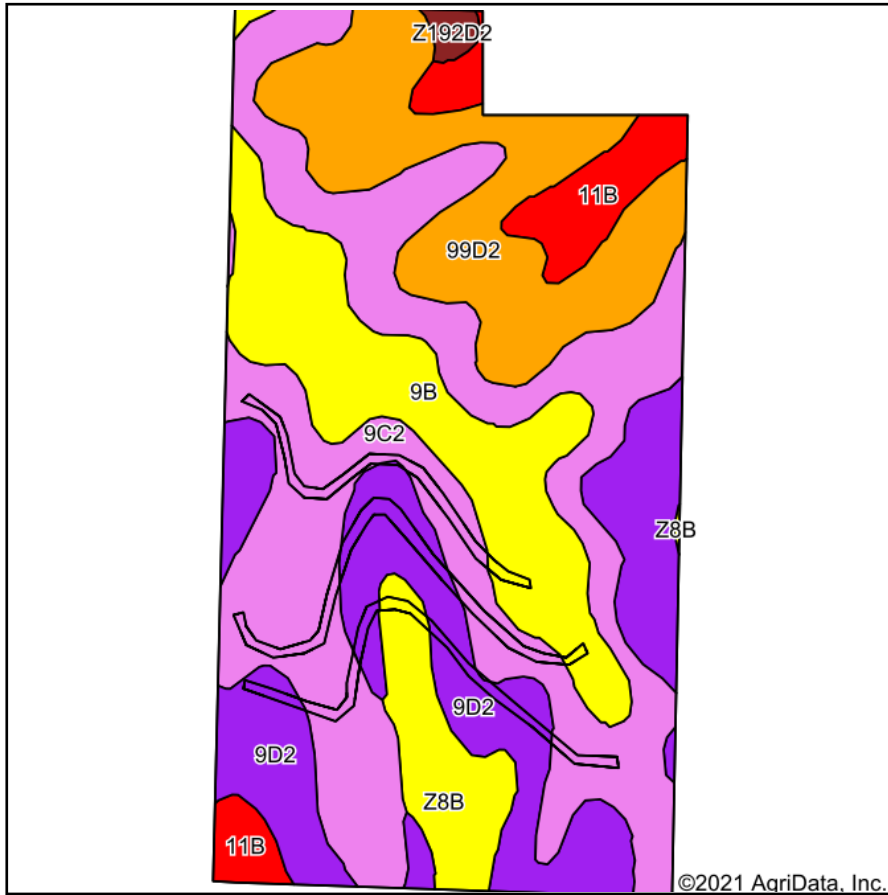

Maps Provided By:



Area Symbol: IA137, Soil Area Version: 29

Code	Soil Description	Acres	Percent of field	CSR2 Legend	Non-Irr Class *c	CSR2**	CSR	*n NCCPI Soybeans
9C2	Marshall silty clay loam, 5 to 9 percent slopes, eroded	26.90	35.5%		IIIe	87	68	70
9D2	Marshall silty clay loam, 9 to 14 percent slopes, eroded	15.67	20.7%		IIIe	61	58	65
99D2	Exira silty clay loam, 9 to 14 percent slopes, eroded	12.65	16.7%		IIIe	59	55	67
9B	Marshall silty clay loam, 2 to 5 percent slopes	11.71	15.4%		Ile	95	85	77
11B	Ackmore-Colo-Judson complex, 2 to 5 percent slopes	4.31	5.7%		IIw	79	68	82
Z8B	Judson silty clay loam, deep loess, 2 to 5 percent slopes	4.16	5.5%		Ile	92		81
Z192D2	Adair clay loam, deep loess, 9 to 14 percent slopes, eroded	0.44	0.6%		IVe	14		45
Weighted Average					2.74	77.6	*-	*n 70.7

\*\*IA has updated the CSR values for each county to CSR2.

\*- CSR weighted average cannot be calculated on the current soils data, use prior data version for csr values.

\*n: The aggregation method is "Weighted Average using all components"

\*c: Using Capabilities Class Dominant Condition Aggregation Method

Soils data provided by USDA and NRCS.