

Soils Map

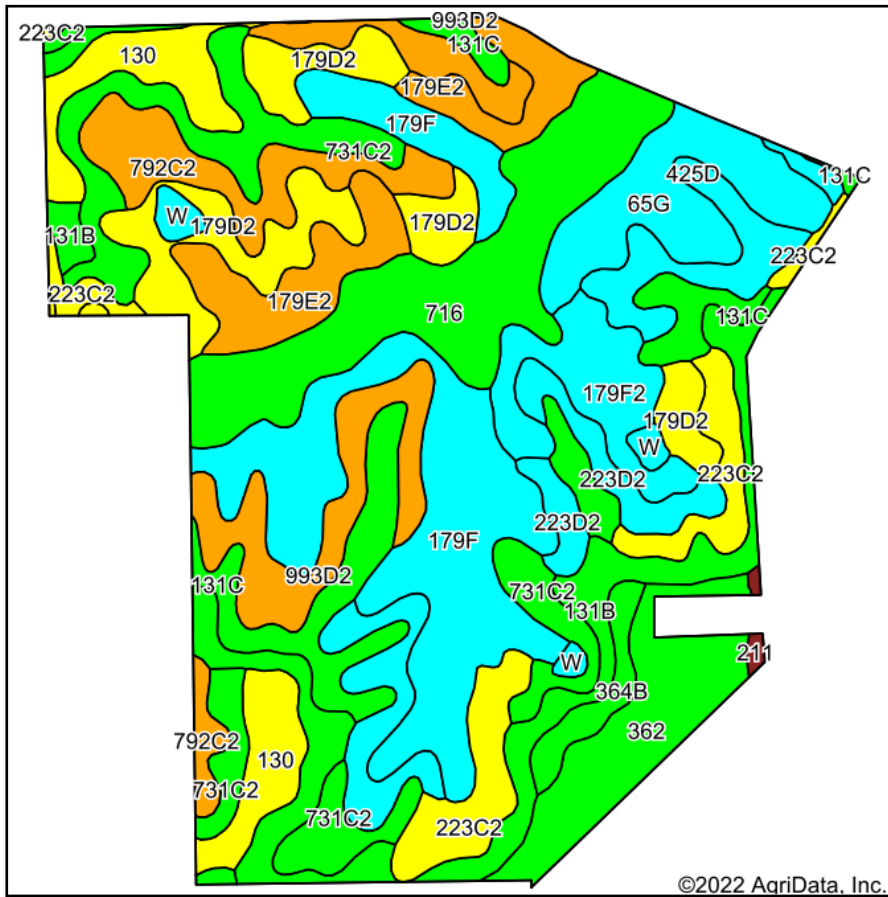

Soils data provided by USDA and NRCS.

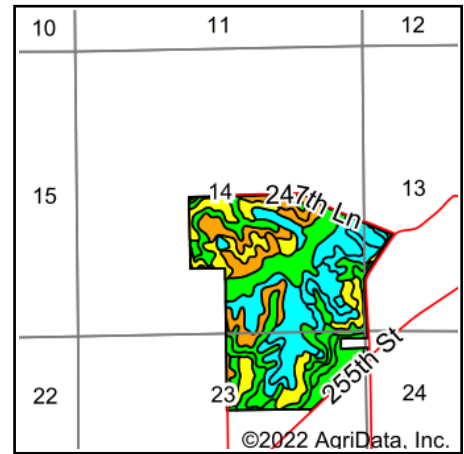

State: **Iowa**
 County: **Monroe**
 Location: **14-71N-16W**
 Township: **Urbana**
 Acres: **235.53**
 Date: **1/24/2022**

Hawkeye Farm Mgmt & Real Estate

United Country Real Estate
 22 N Main, Albion IA Phone: 641-932-7796
 Email: hawkeye@uciowa.com
 On the web: www.uciowa.com
 www.iowawhitehallfarms.com

Maps Provided By:

surety
 CUSTOMIZED ONLINE MAPPING
 © AgriData, Inc. 2021 www.AgriDataInc.com



Area Symbol: IA135, Soil Area Version: 29

Code	Soil Description	Acres	Percent of field	CSR2 Legend	Non-Irr Class *c	CSR2**	CSR	*n NCCPI Soybeans
179F	Gara loam, 18 to 25 percent slopes	32.58	13.8%		VIe	19	15	42
716	Lawson-Quiver-Nodaway complex, 0 to 2 percent slopes, occasionally flooded	22.43	9.5%		IIW	78		87
731C2	Pershing silty clay loam, 5 to 9 percent slopes, moderately eroded	18.65	7.9%		IIIe	62	45	57
131B	Pershing silt loam, 2 to 5 percent slopes	17.30	7.3%		IIIe	70	67	60
179D2	Gara loam, 9 to 14 percent slopes, moderately eroded	15.98	6.8%		IVe	43	43	53
131C	Pershing silt loam, 5 to 9 percent slopes	14.63	6.2%		IIIe	65	49	59
792C2	Armstrong loam, 5 to 9 percent slopes, moderately eroded	14.03	6.0%		IIIe	31	27	48
179E2	Gara loam, 14 to 18 percent slopes, moderately eroded	12.18	5.2%		VIe	35	33	52
223C2	Rinda silty clay loam, 5 to 9 percent slopes, moderately eroded	11.85	5.0%		IVW	45	22	48
65G	Lindley loam, 18 to 40 percent slopes	11.77	5.0%		VIIe	6	5	12
362	Haig silty clay loam, 0 to 2 percent slopes	11.73	5.0%		IIW	83	70	64
223D2	Rinda silty clay loam, 9 to 14 percent slopes, moderately eroded	11.42	4.8%		IVe	19	9	45
130	Belinda silt loam, 0 to 2 percent slopes	10.74	4.6%		IIIW	47	63	58
993D2	Gara-Armstrong loams, 9 to 14 percent slopes, moderately eroded	9.49	4.0%		IVe	35	20	49
179F2	Gara loam, 18 to 24 percent slopes, moderately eroded	8.70	3.7%		VIe	12	13	38
425D	Keswick loam, 9 to 14 percent slopes	6.13	2.6%		IVe	8	16	45
364B	Grundy silty clay loam, 2 to 5 percent slopes	2.84	1.2%		Ile	72	75	69
W	Water	1.95	0.8%			0	0	
792D2	Armstrong loam, 9 to 14 percent slopes, moderately eroded	0.70	0.3%		IVe	9	13	44
211	Edina silt loam, 0 to 1 percent slopes	0.43	0.2%		IIIW	59	60	65
Weighted Average					3.93	43.5	*-	*n 52.5

**IA has updated the CSR values for each county to CSR2.

*- CSR weighted average cannot be calculated on the current soils data, use prior data version for csr values.

*n: The aggregation method is "Weighted Average using all components"

*c: Using Capabilities Class Dominant Condition Aggregation Method

Soils data provided by USDA and NRCS.