

Soils Map

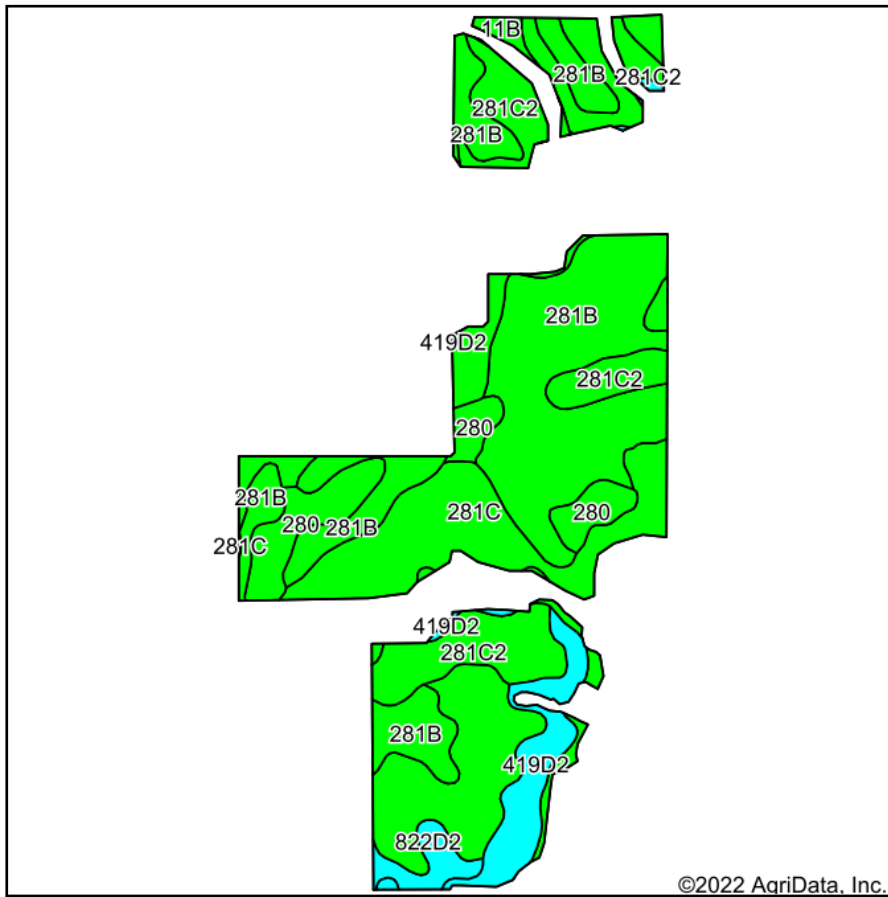

Soils data provided by USDA and NRCS.

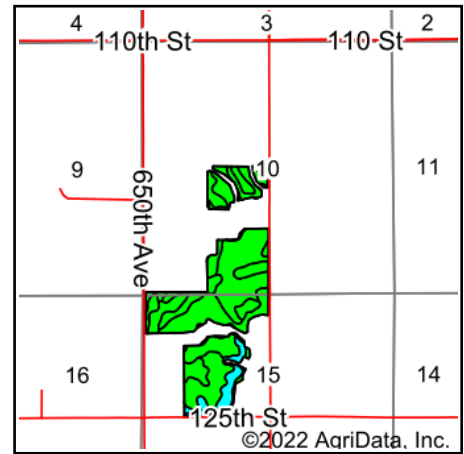

State: **Iowa**
 County: **Monroe**
 Location: **10-73N-17W**
 Township: **Bluff Creek**
 Acres: **138**
 Date: **2/9/2022**

Hawkeye Farm Mgmt & Real Estate

United Country Real Estate
 22 N Main, Albion IA Phone: 641-932-7796
 Email: hawkeye@uciowa.com
 On the web: www.uciowa.com; www.iowawhitetailfarms.com

Maps Provided By:

surety
 CUSTOMIZED ONLINE MAPPING
 © AgriData, Inc. 2021 www.AgriDataInc.com



Area Symbol: IA135, Soil Area Version: 29

Code	Soil Description	Acres	Percent of field	CSR2 Legend	Non-Irr Class *c	CSR2**	CSR	*n NCCPI Soybeans
281B	Otley silty clay loam, 2 to 5 percent slopes	49.75	36.1%		Ile	91	90	77
281C	Otley silty clay loam, 5 to 9 percent slopes	34.70	25.1%		IIle	85	75	74
281C2	Otley silty clay loam, 5 to 9 percent slopes, eroded	28.09	20.4%		IIle	82	70	66
280	Mahaska silty clay loam, 0 to 2 percent slopes	10.51	7.6%		Iw	94	95	77
419D2	Vanmeter silty clay loam, 9 to 14 percent slopes, moderately eroded	8.67	6.3%		VIle	5	15	30
11B	Colo-Ely complex, 0 to 5 percent slopes	3.09	2.2%		IIw	86	63	76
822D2	Lamoni clay loam, 9 to 14 percent slopes, moderately eroded	2.96	2.1%		IVe	11	15	45
478G	Munterville-Rock outcrop complex, 14 to 40 percent slopes	0.23	0.2%		VIIe	5	5	6
Weighted Average						2.68	80.5	75.5
								*n 70.2

**IA has updated the CSR values for each county to CSR2.

*n: The aggregation method is "Weighted Average using all components"

*c: Using Capabilities Class Dominant Condition Aggregation Method

Soils data provided by USDA and NRCS.