

Soils Map

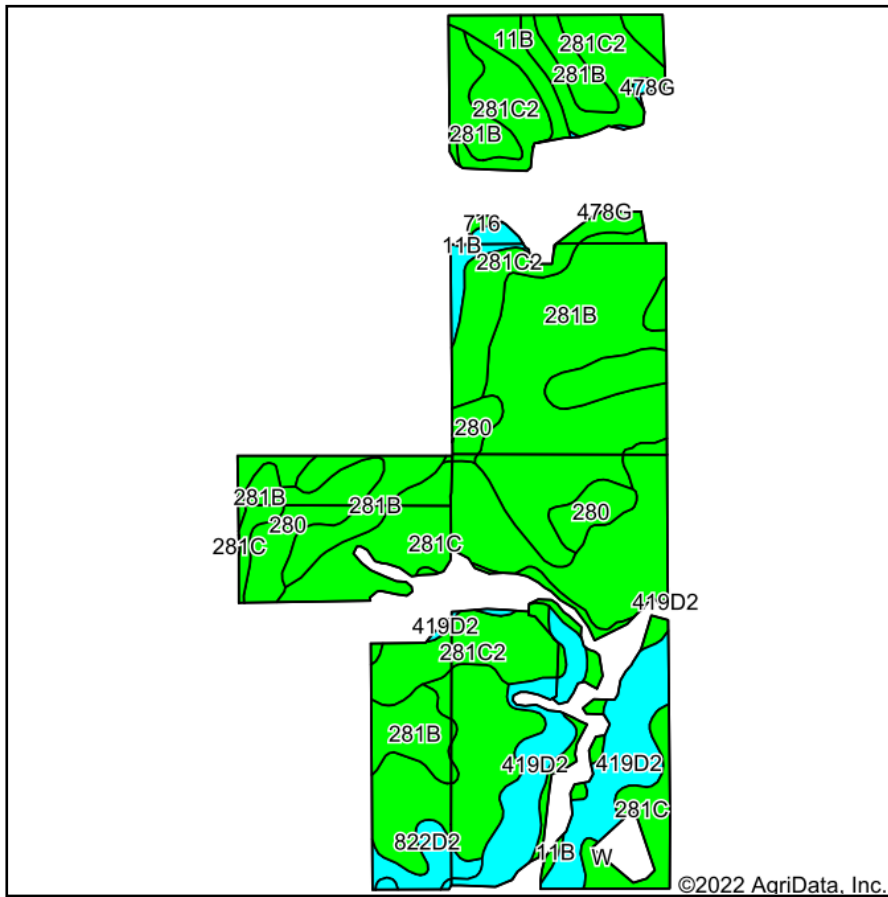

Soils data provided by USDA and NRCS.

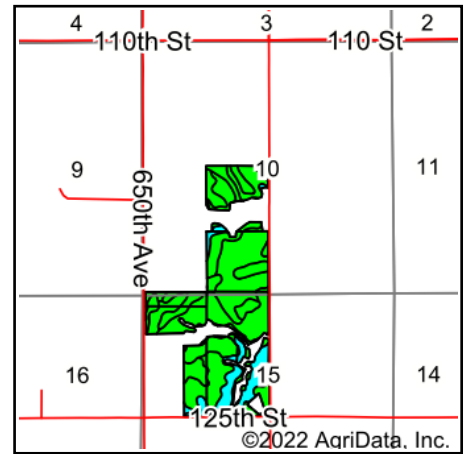

State: **Iowa**
 County: **Monroe**
 Location: **10-73N-17W**
 Township: **Bluff Creek**
 Acres: **169.42**
 Date: **2/9/2022**

Hawkeye Farm Mgmt & Real Estate

United Country Real Estate
 22 N Main, Albion IA Phone: 641-932-7796
 Email: hawkeye@uciowa.com
 On the web: www.uciowa.com
 www.iowawhitetailfarms.com

Maps Provided By:

surety
 CUSTOMIZED ONLINE MAPPING
 © AgriData, Inc. 2021 www.AgriDataInc.com



Area Symbol: IA135, Soil Area Version: 29

Code	Soil Description	Acres	Percent of field	CSR2 Legend	Non-Irr Class *c	CSR2**	CSR	*n NCCPI Soybeans
281B	Otley silty clay loam, 2 to 5 percent slopes	50.23	29.6%		Ile	91	90	77
281C	Otley silty clay loam, 5 to 9 percent slopes	44.21	26.1%		IIle	85	75	74
281C2	Otley silty clay loam, 5 to 9 percent slopes, eroded	33.62	19.8%		IIIle	82	70	66
419D2	Vanmeter silty clay loam, 9 to 14 percent slopes, moderately eroded	19.87	11.7%		VIle	5	15	30
280	Mahaska silty clay loam, 0 to 2 percent slopes	10.60	6.3%		Iw	94	95	77
11B	Colo-Ely complex, 0 to 5 percent slopes	7.26	4.3%		IIw	86	63	76
822D2	Lamoni clay loam, 9 to 14 percent slopes, moderately eroded	2.96	1.7%		IVe	11	15	45
478G	Munterville-Rock outcrop complex, 14 to 40 percent slopes	0.40	0.2%		VIIle	5	5	6
716	Lawson-Quiver-Nodaway complex, 0 to 2 percent slopes, occasionally flooded	0.27	0.2%		IIw	78		87
Weighted Average						2.91	75.9	*- *n 67.8

**IA has updated the CSR values for each county to CSR2.

*- CSR weighted average cannot be calculated on the current soils data, use prior data version for csr values.

*n: The aggregation method is "Weighted Average using all components"

*c: Using Capabilities Class Dominant Condition Aggregation Method

Soils data provided by USDA and NRCS.