

# Soils Map

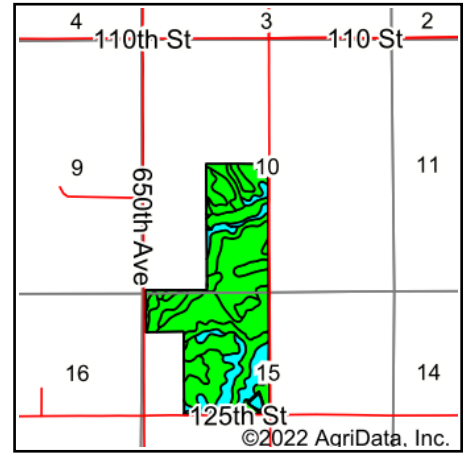

State: **Iowa**  
 County: **Monroe**  
 Location: **10-73N-17W**  
 Township: **Bluff Creek**  
 Acres: **201.81**  
 Date: **2/9/2022**

**Hawkeye Farm Mgmt & Real Estate**

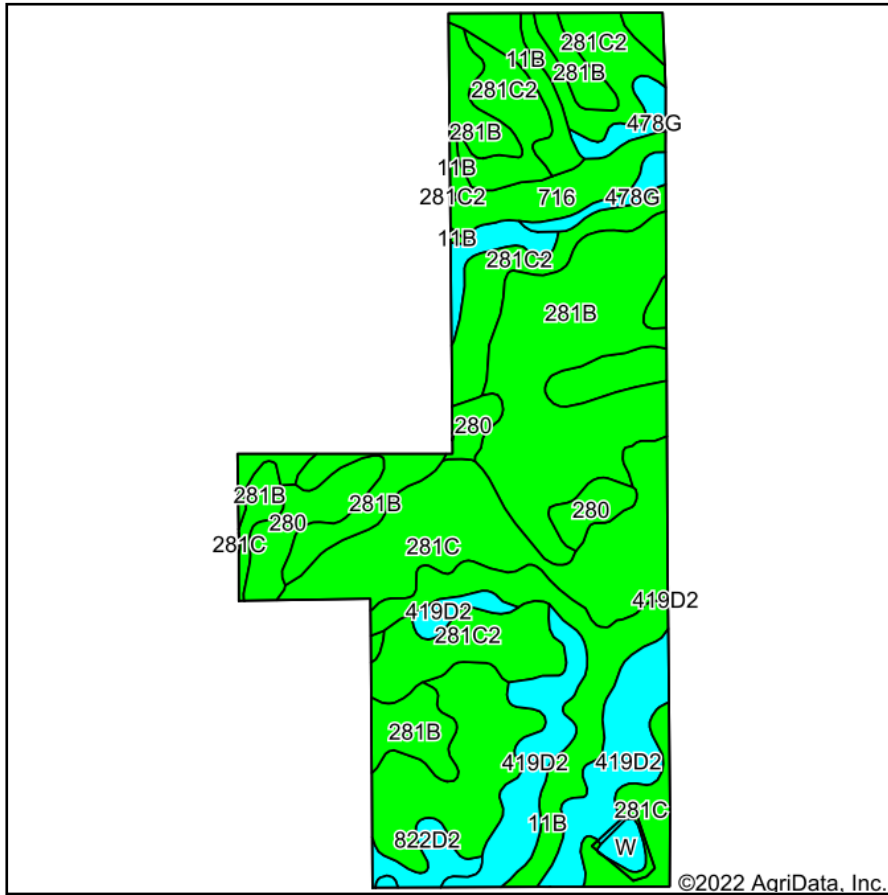

22 N Main, Albion IA Phone: 641-932-7796  
 Email: hawkeye@uciowa.com  
 On the web: www.uciowa.com  
 www.iowawhitetailfarms.com

Maps Provided By:



Area Symbol: IA135, Soil Area Version: 29

Code	Soil Description	Acres	Percent of field	CSR2 Legend	Non-Irr Class *c	CSR2**	CSR	*n NCCPI Soybeans
281B	Otley silty clay loam, 2 to 5 percent slopes	50.67	25.1%		Ile	91	90	77
281C	Otley silty clay loam, 5 to 9 percent slopes	46.10	22.8%		IIle	85	75	74
281C2	Otley silty clay loam, 5 to 9 percent slopes, eroded	36.62	18.1%		IIIle	82	70	66
419D2	Vanmeter silty clay loam, 9 to 14 percent slopes, moderately eroded	23.45	11.6%		VIle	5	15	30
11B	Colo-Ely complex, 0 to 5 percent slopes	18.78	9.3%		IIlw	86	63	76
280	Mahaska silty clay loam, 0 to 2 percent slopes	10.60	5.3%		Iw	94	95	77
716	Lawson-Quiver-Nodaway complex, 0 to 2 percent slopes, occasionally flooded	7.04	3.5%		IIlw	78		87
478G	Munterville-Rock outcrop complex, 14 to 40 percent slopes	4.22	2.1%		VIIle	5	5	6
822D2	Lamoni clay loam, 9 to 14 percent slopes, moderately eroded	2.96	1.5%		IVle	11	15	45
W	Water	1.37	0.7%			0	0	
<b>Weighted Average</b>						<b>2.94</b>	<b>73.7</b>	<b>*n 66.6</b>

\*\*IA has updated the CSR values for each county to CSR2.

\*- CSR weighted average cannot be calculated on the current soils data, use prior data version for csr values.

\*n: The aggregation method is "Weighted Average using all components"

\*c: Using Capabilities Class Dominant Condition Aggregation Method

Soils data provided by USDA and NRCS.