

Soils Map

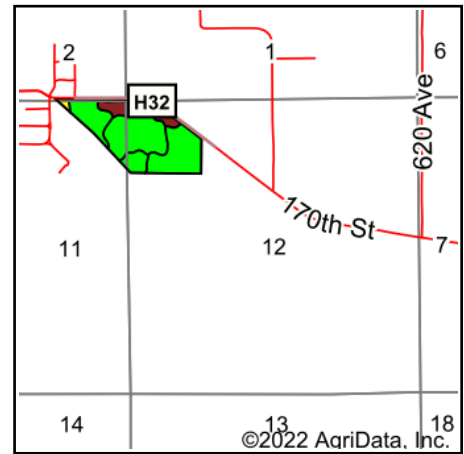

State: **Iowa**
 County: **Monroe**
 Location: **12-72N-18W**
 Township: **Guilford**
 Acres: **50.09**
 Date: **3/23/2022**

Hawkeye Farm Mgmt & Real Estate

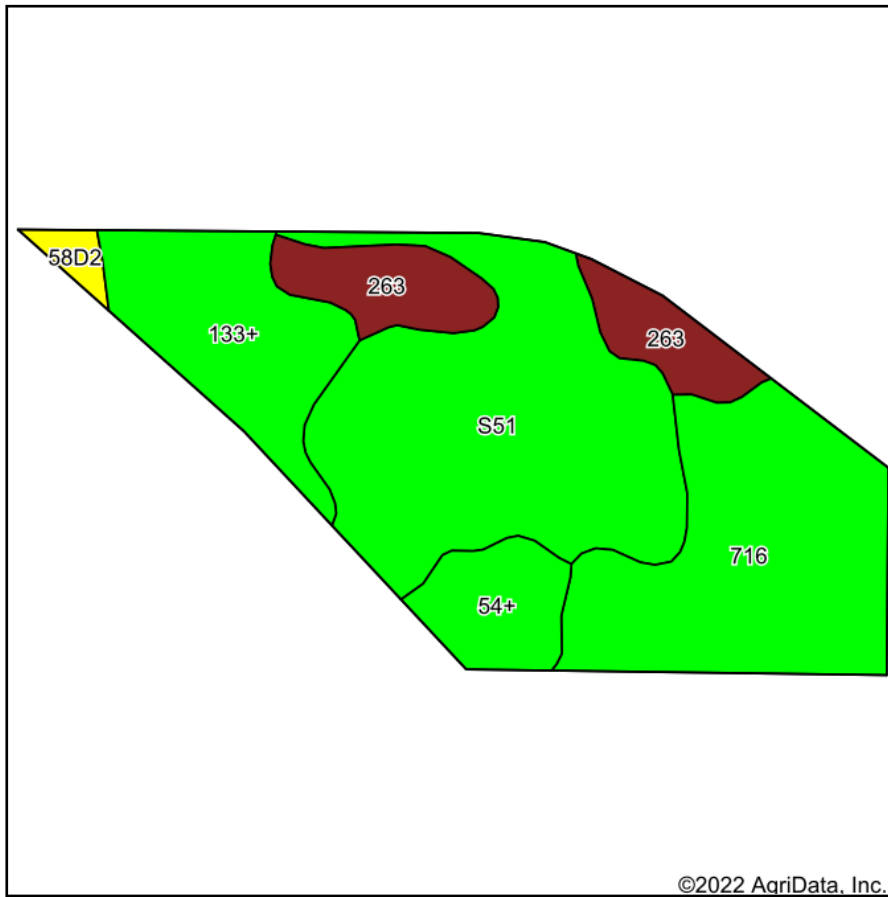

22 N Main, Albion IA Phone: 641-932-7796
 Email: hawkeye@uciowa.com
 On the web: www.uciowa.com
 www.iowawhitetailfarms.com

Maps Provided By:



© AgriData, Inc. 2021

www.AgriDataInc.com



Area Symbol: IA135, Soil Area Version: 29

Code	Soil Description	Acres	Percent of field	CSR2 Legend	Non-Irr Class *c	CSR2**	CSR	*n NCCPI Soybeans
S51	Vesser silt loam, 0 to 2 percent slopes, occasionally flooded	18.71	37.4%		Ilw	75		95
716	Lawson-Quiver-Nodaway complex, 0 to 2 percent slopes, occasionally flooded	14.08	28.1%		Ilw	78		87
133+	Colo silt loam, overwash, 0 to 2 percent slopes	7.62	15.2%		Ilw	78	80	87
263	Okaw silt loam, heavy till, 0 to 2 percent slopes, rarely flooded	5.62	11.2%		Illw	52	53	55
54+	Zook silt loam, heavy till, 0 to 2 percent slopes, occasionally flooded, overwash	3.39	6.8%		Ilw	68	70	73
58D2	Douds loam, heavy loess, 9 to 14 percent slopes, moderately eroded	0.67	1.3%		IVe	44	28	64
Weighted Average					2.14	72.8	*-	*n 85.1

**IA has updated the CSR values for each county to CSR2.

*- CSR weighted average cannot be calculated on the current soils data, use prior data version for csr values.

*n: The aggregation method is "Weighted Average using all components"

*c: Using Capabilities Class Dominant Condition Aggregation Method

Soils data provided by USDA and NRCS.