

# Soils Map

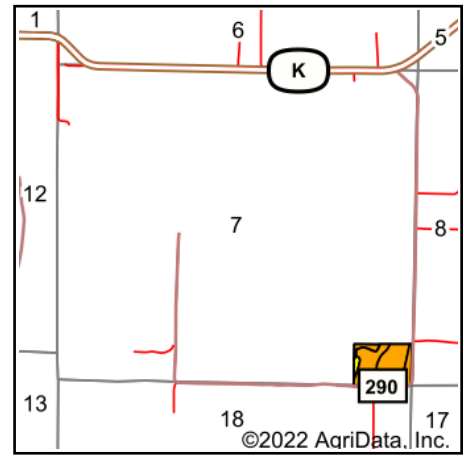

State: **Missouri**  
 County: **Montgomery**  
 Location: **7-46N-6W**  
 Township: **Loutre**  
 Acres: **15.89**  
 Date: **2/8/2022**

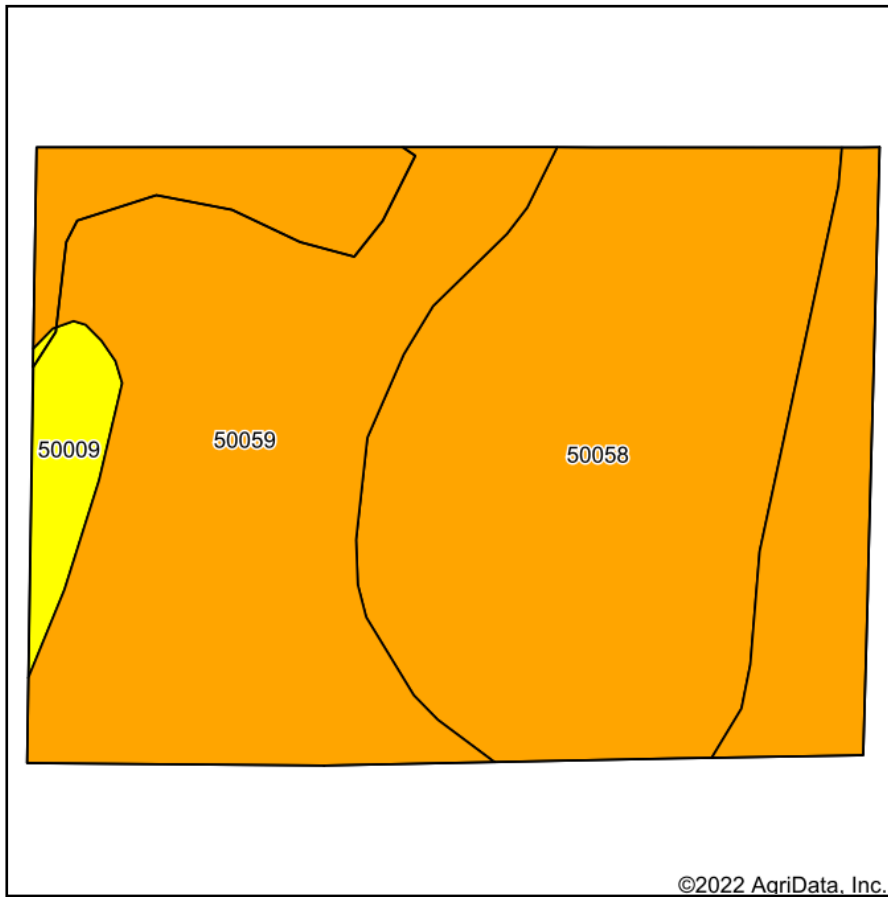

Maps Provided By:  
  
 © AgriData, Inc. 2021 [www.AgriDataInc.com](http://www.AgriDataInc.com)



Area Symbol: MO139, Soil Area Version: 21									
Code	Soil Description	Acres	Percent of field	Non-Irr Class Legend	Non-Irr Class *c	*n NCCPI Overall	*n NCCPI Corn	*n NCCPI Small Grains	*n NCCPI Soybeans
50059	Mexico silt loam, 1 to 4 percent slopes, eroded	8.44	53.1%		IIIe	72	72	62	54
50058	Mexico silt loam, 0 to 2 percent slopes	6.87	43.2%		IIIw	75	75	67	60
50009	Keswick silt loam, 9 to 14 percent slopes, eroded	0.58	3.7%		IVe	53	53	53	41
Weighted Average					3.04	*n 72.6	*n 72.6	*n 63.8	*n 56.1

\*n: The aggregation method is "Weighted Average using all components"

\*c: Using Capabilities Class Dominant Condition Aggregation Method

Soils data provided by USDA and NRCS.