

NEW LISTING

See more information at www.hciutah.com

Northwest Grantsville 20 Acres

±20 acres in Grantsville City, Tooele County, Utah

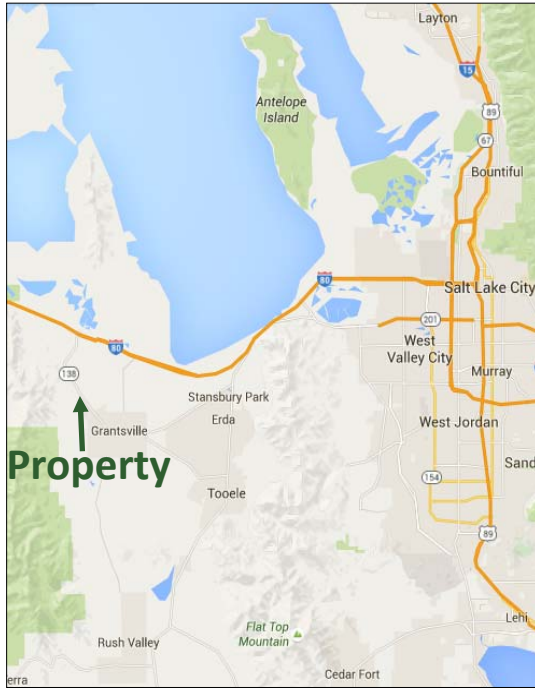

EXECUTIVE SUMMARY:

List Price: \$1,400,000

Mike Nelson | Joe Nelson

801-482-7565 | mike@hciutah.com

Notice: This information is believed to be accurate, but no warranty is expressed or implied. Highland Commercial insists that interested parties conduct their own research and investigations. The property is offered subject to prior sale, price change, and withdrawal without notice. No obligations will be created unless a purchase contract is signed by both buyer and seller. We welcome the cooperation of participating brokers; please contact us for our commission-sharing policies. All images and materials are copyright protected and are the

- ±20 acres in Grantsville City, Tooele County, Utah
- 2021 Taxes: \$7.51 (Greenbelt)
- Zoned MG (General Manufacturing District for larger and more intensive industrial uses) in Grantsville City
- Access and exposure along Highway 138 less than one mile northwest of the Walmart Distribution Center
- Acreage to be split out of parcel 01-118-0-0024
- Four miles from I-80
- 13 miles from Tooele City, Utah
- 35 miles from Salt Lake City, Utah



2733 East Parley's Way, Suite 208

Salt Lake City, UT 84109

801-487-6100

www.hciutah.com



Property



Highway 138

Walmart
Distribution
Center

138

Grantsville

N