



County of Nevada

Nevada County, CA Parcel Report
Data current as of: 3/14/2022

Description: The Parcel Report displays information from a variety of sources – Assessor, Building, Code Enforcement, Environmental Health, and Planning departments to list a few. The report is maintained by the County GIS Division.

Search by Assessor's Parcel Number (APN): **050-210-018-000**

Search

Print this report

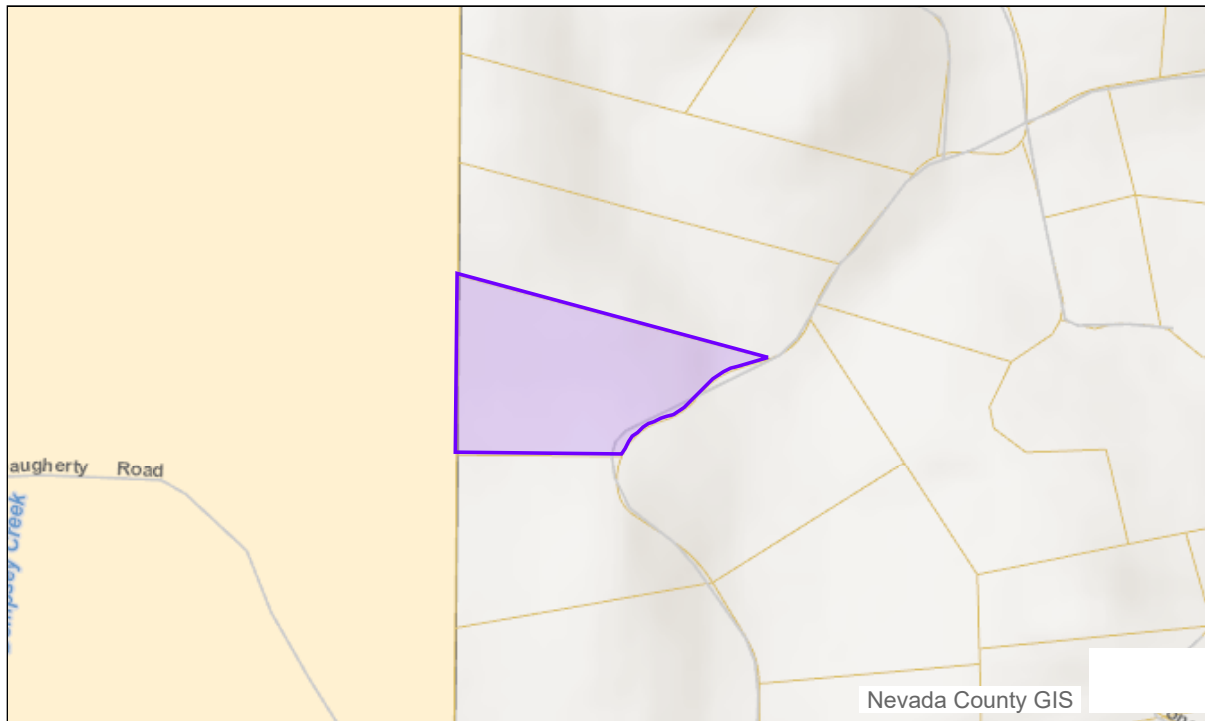

View Assessor's Parcel Map PDF

Site Information

Property Details

Districts

Permits

Unrecorded Maps

Structures

| Year Built | # Buildings | # Units | # Stories | # Bedrooms | # Baths | # Rooms |
|------------|-------------|---------|-----------|------------|---------|---------|
| 2003 | 1 | No Data | 1 | 3 | 2 | 8 |

Layout Details

| Square Feet | Garage or Carport | Has Deck/Porch? |
|-------------|-------------------|-----------------|
| On record | -- | No |
| 2570 | -- | -- |

Amenities

| # Fireplaces | Temperature Control | Pool or Spa |
|--------------|---------------------|-------------|
| No Data | heat code: B | No Data |

Infrastructure

| Physical Access | Road Surface | Connected to Sewer? | Water Source |
|-----------------|--------------|---------------------|--------------|
| R | G | No Data | W |

Land Characteristics

| Topography | Area View | Frontage | Ground Cover |
|------------|-----------|----------|--------------|
| R | A | R | O |