

Soils Map

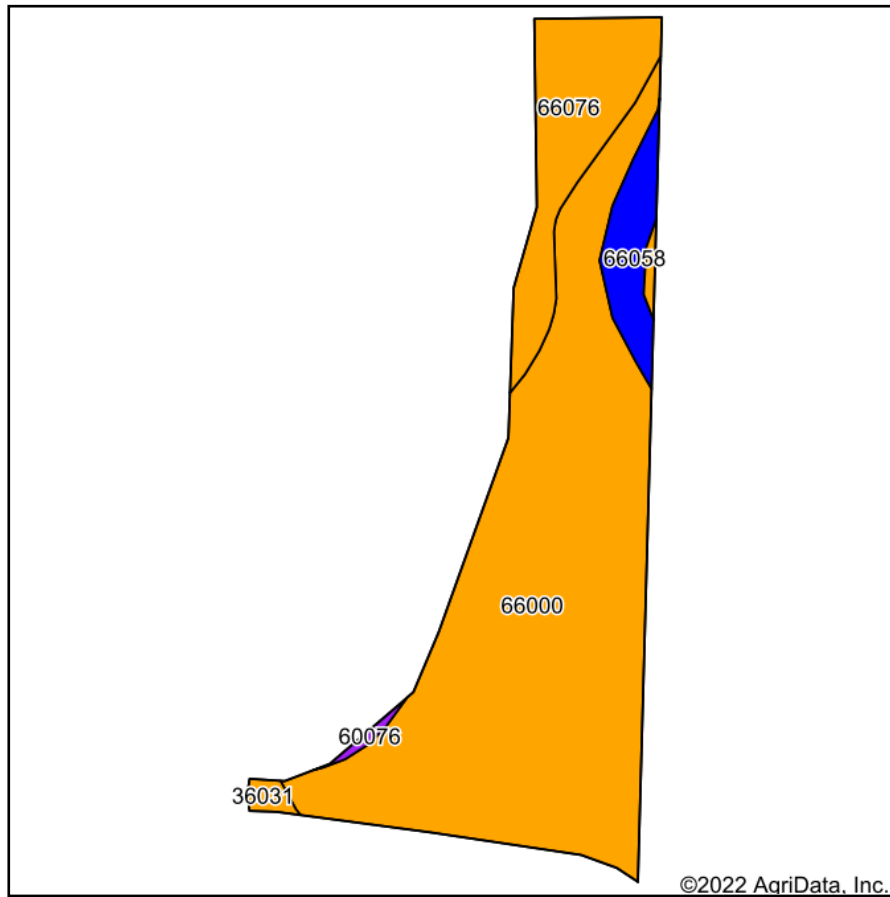

Soils data provided by USDA and NRCS.

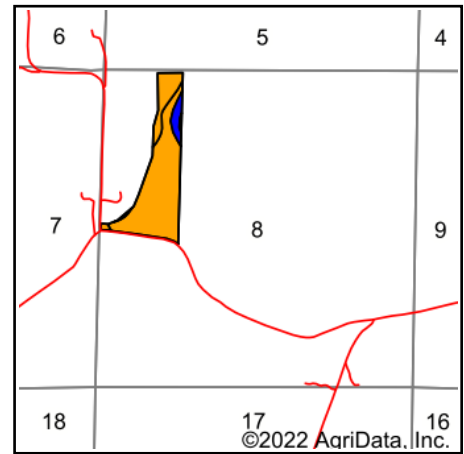

State: **Missouri**
 County: **Montgomery**
 Location: **8-48N-6W**
 Township: **Danville**
 Acres: **38**
 Date: **5/26/2022**



Maps Provided By:



© AgriData, Inc. 2021

www.AgriDataInc.com



Area Symbol: MO139, Soil Area Version: 21

Code	Soil Description	Acres	Percent of field	Non-Irr Class Legend	Non-Irr Class *c	Alfalfa hay Tons	Caucasian bluestem Tons	Common bermudagrass Tons	Orchardgrass red clover Tons	Tall fescue AUM	Tall fescue Tons	Warm season grasses Tons	*n NCCPI Soybeans
66000	Moniteau silt loam, 0 to 2 percent slopes, occasionally flooded	29.52	77.7%		IIIw								76
66076	Coland clay loam, 0 to 2 percent slopes, occasionally flooded	5.61	14.8%		IIIw			8	7	8	8	10	60
66058	Belknap silt loam, 0 to 2 percent slopes, occasionally flooded	2.18	5.7%		IIw								69
36031	Nodaway silt loam, 0 to 2 percent slopes, frequently flooded	0.52	1.4%		IIIw			7	9	8	8	10	49
60076	Chilhowie, Gasconade, and Crider soils, 14 to 35 percent slopes	0.17	0.4%		VIe	4	6	4	5	4	4	6	11
Weighted Average					2.96	*-	*-	1.3	1.2	1.3	1.3	1.6	*n 72.6

*n: The aggregation method is "Weighted Average using all components"

*c: Using Capabilities Class Dominant Condition Aggregation Method

Soils data provided by USDA and NRCS.