

Soils Map

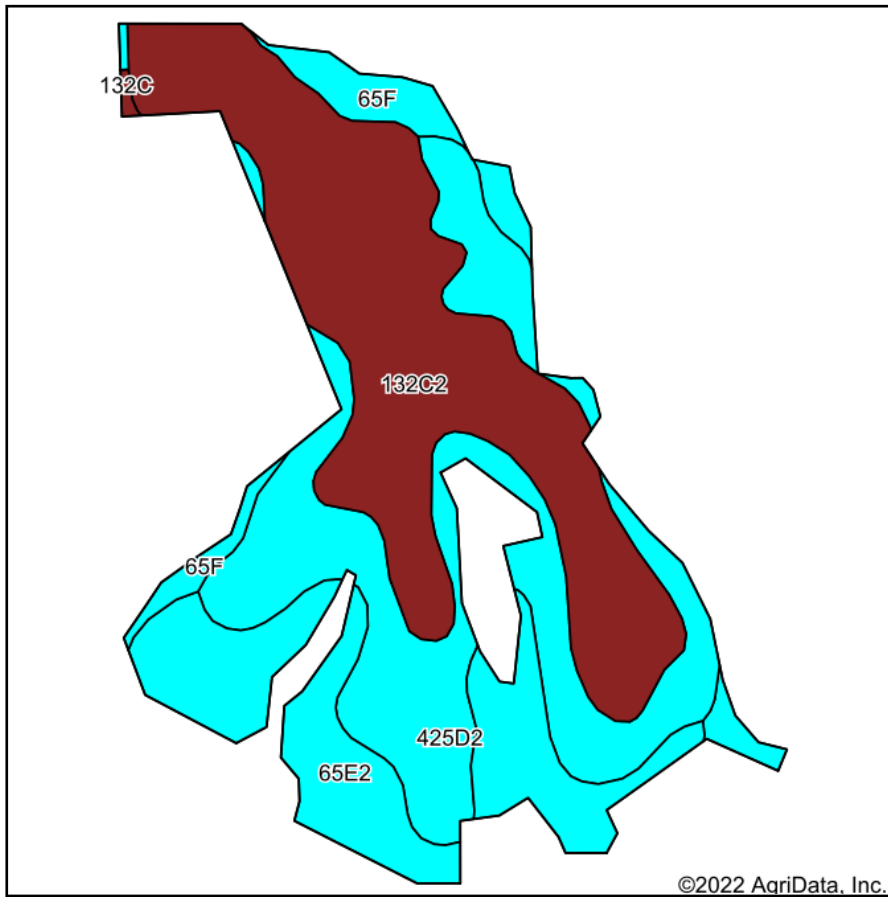

Soils data provided by USDA and NRCS.

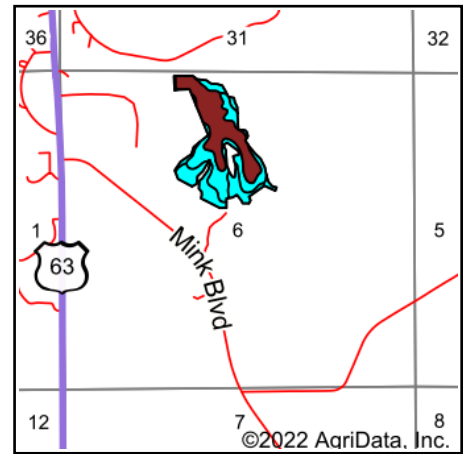

State: **Iowa**
 County: **Davis**
 Location: **6-70N-13W**
 Township: **Lick Creek**
 Acres: **33.75**
 Date: **1/23/2022**

Hawkeye Farm Mgmt & Real Estate



22 N Main, Albion IA Phone: 641-932-7796
 Email: hawkeye@uciowa.com
 On the web: www.uciowa.com
www.iowawhitetailfarms.com

Maps Provided By:



© AgriData, Inc. 2021

www.AgriDataInc.com



Area Symbol: IA051, Soil Area Version: 28

Code	Soil Description	Acres	Percent of field	CSR2 Legend	Non-Irr Class *c	CSR2**	CSR	*n NCCPI Soybeans
132C2	Weller silty clay loam, 5 to 9 percent slopes, moderately eroded	13.89	41.2%		IIIe	59	40	71
425D2	Keswick loam, 9 to 14 percent slopes, moderately eroded	10.73	31.8%		IVe	9	12	38
65E2	Lindley loam, 14 to 18 percent slopes, moderately eroded	6.90	20.4%		VIe	29	28	55
65F	Lindley loam, 18 to 40 percent slopes	2.16	6.4%		VIIe	6	10	12
132C	Weller silt loam, 5 to 9 percent slopes	0.07	0.2%		IIIe	59	44	77
Weighted Average					4.19	33.6	26.7	*n 53.5

**IA has updated the CSR values for each county to CSR2.

*n: The aggregation method is "Weighted Average using all components"

*c: Using Capabilities Class Dominant Condition Aggregation Method

Soils data provided by USDA and NRCS.