

# Soils Map

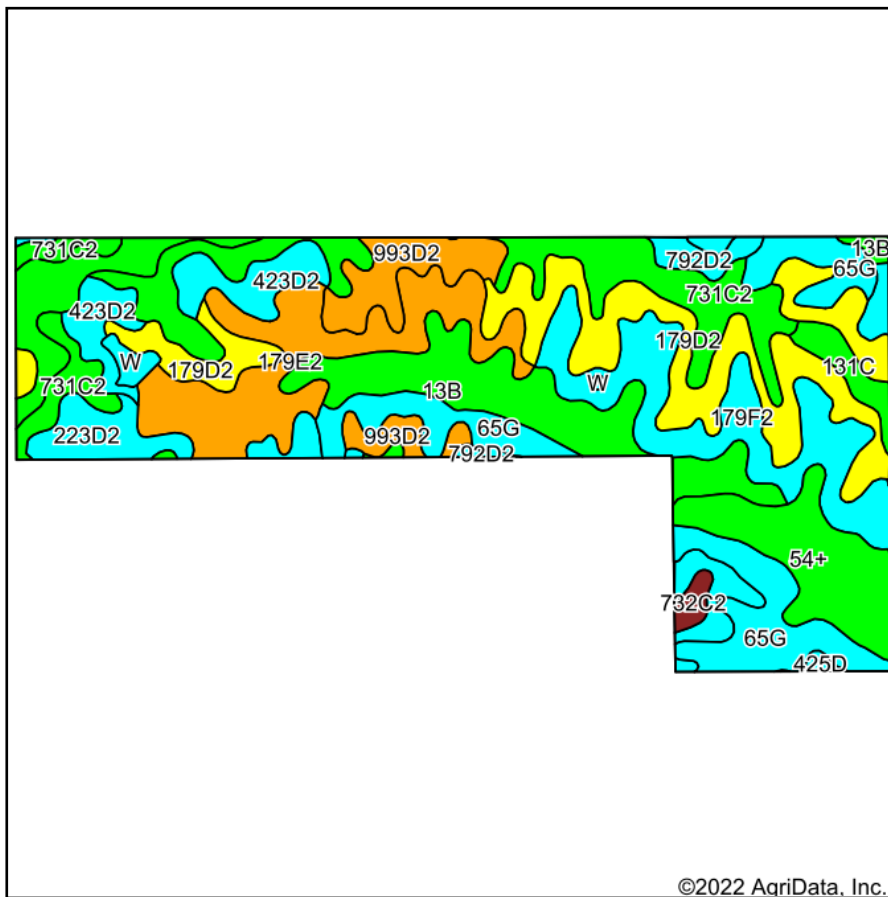

Soils data provided by USDA and NRCS.

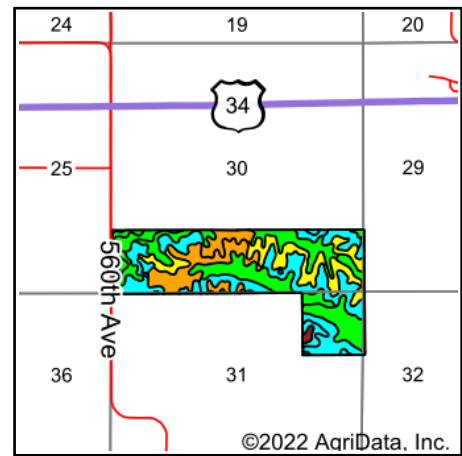

State: **Iowa**  
 County: **Monroe**  
 Location: **30-72N-18W**  
 Township: **Guilford**  
 Acres: **202.89**  
 Date: **7/6/2022**

**Hawkeye Farm Mgmt & Real Estate**

22 N Main, Albion IA Phone: 641-932-7796  
 Email: [hawkeye@uciowa.com](mailto:hawkeye@uciowa.com)  
 On the web: [www.uciowa.com](http://www.uciowa.com)  
[www.iowawhitetailfarms.com](http://www.iowawhitetailfarms.com)

Maps Provided By:

**surety**  
 CUSTOMIZED ONLINE MAPPING  
 © AgriData, Inc. 2021 [www.AgriDataInc.com](http://www.AgriDataInc.com)



Area Symbol: IA135, Soil Area Version: 29

Code	Soil Description	Acres	Percent of field	CSR2 Legend	Non-Irr Class *c	CSR2**	CSR	*n NCCPI Soybeans
179D2	Gara loam, 9 to 14 percent slopes, moderately eroded	28.98	14.3%		IVe	43	43	53
731C2	Pershing silty clay loam, 5 to 9 percent slopes, moderately eroded	25.57	12.6%		IIIe	62	45	57
65G	Lindley loam, 18 to 40 percent slopes	22.53	11.1%		VIIe	6	5	12
179E2	Gara loam, 14 to 18 percent slopes, moderately eroded	22.17	10.9%		VIe	35	33	52
179F2	Gara loam, 18 to 24 percent slopes, moderately eroded	21.69	10.7%		VIe	12	13	38
13B	Olmitz-Colo-Vesser complex, 2 to 5 percent slopes	19.95	9.8%		IIw	82	60	72
54+	Zook silt loam, heavy till, 0 to 2 percent slopes, occasionally flooded, overwash	14.15	7.0%		IIw	68	70	73
993D2	Gara-Armstrong loams, 9 to 14 percent slopes, moderately eroded	10.00	4.9%		IVe	35	20	49
423D2	Bucknell silty clay loam, 9 to 14 percent slopes, moderately eroded	9.60	4.7%		IVe	6	13	44
131B	Pershing silt loam, 2 to 5 percent slopes	7.70	3.8%		IIIe	70	67	60
223D2	Rinda silty clay loam, 9 to 14 percent slopes, moderately eroded	7.23	3.6%		IVe	19	9	45
424E2	Lindley-Keswick loams, 14 to 18 percent slopes, moderately eroded	3.54	1.7%		VIe	24	5	47
131C	Pershing silt loam, 5 to 9 percent slopes	3.28	1.6%		IIIe	65	49	59
792D2	Armstrong loam, 9 to 14 percent slopes, moderately eroded	2.72	1.3%		IVe	9	13	44
W	Water	1.38	0.7%			0	0	
732C2	Weller silty clay loam, 5 to 9 percent slopes, moderately eroded	1.24	0.6%		IIIe	59	40	71
130	Belinda silt loam, 0 to 2 percent slopes	0.72	0.4%		IIIw	47	63	58
425D	Keswick loam, 9 to 14 percent slopes	0.44	0.2%		IVe	8	16	45
<b>Weighted Average</b>					<b>*-</b>	<b>40</b>	<b>34.2</b>	<b>*n 49.5</b>

\*\*IA has updated the CSR values for each county to CSR2.

\*n: The aggregation method is "Weighted Average using all components"

\*c: Using Capabilities Class Dominant Condition Aggregation Method

\*- Non Irr Class weighted average cannot be calculated on the current soils data due to missing data.

Soils data provided by USDA and NRCS.