

Soils Map

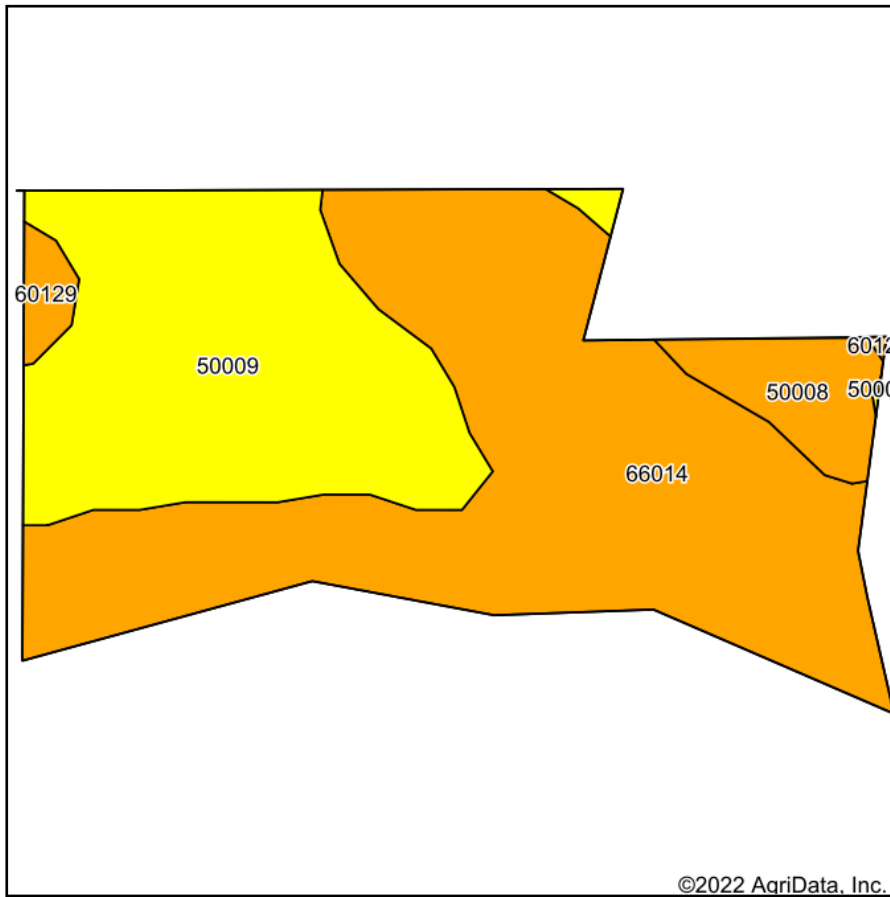

Soils data provided by USDA and NRCS.

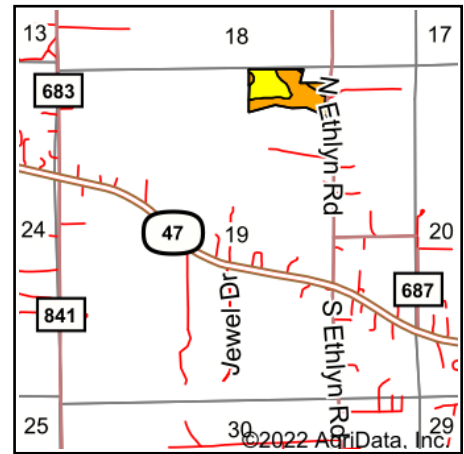

State: **Missouri**
 County: **Lincoln**
 Location: **19-49N-2E**
 Township: **Monroe**
 Acres: **16.32**
 Date: **7/12/2022**



Maps Provided By:



© AgriData, Inc. 2021

www.AgriDataInc.com



Area Symbol: MO113, Soil Area Version: 23

| Code | Soil Description | Acres | Percent of field | Non-Irr Class Legend | Non-Irr Class *c | Alfalfa hay Tons | Caucasian bluestem Tons | Common bermudagrass Tons | Orchardgrass red clover Tons | Tall fescue Tons | Warm season grasses Tons | *n NCCPI Overall | *n NCCPI Corn | *n NCCPI Small Grains | *n NCCPI Soybean |
|------------------|--|-------|------------------|----------------------|------------------|------------------|-------------------------|--------------------------|------------------------------|------------------|--------------------------|------------------|---------------|-----------------------|------------------|
| 66014 | Haymond silt loam, 0 to 3 percent slopes, frequently flooded | 9.23 | 56.6% | | IIIw | | | | | | | 70 | 70 | 58 | |
| 50009 | Keswick silt loam, 9 to 14 percent slopes, eroded | 5.88 | 36.0% | | IVe | | | | | | | 53 | 53 | 53 | |
| 50008 | Keswick silt loam, 5 to 9 percent slopes, eroded | 0.93 | 5.7% | | IIIe | | | | | | | 61 | 61 | 56 | |
| 60129 | Hatton silt loam, 5 to 9 percent slopes | 0.28 | 1.7% | | IIIe | 3 | 6 | 4 | 5 | 5 | 6 | 62 | 59 | 62 | |
| Weighted Average | | | | | 3.36 | 0.1 | 0.1 | 0.1 | 0.1 | 0.1 | 0.1 | *n 63.2 | *n 63.2 | *n 56.2 | *n 5 |

*n: The aggregation method is "Weighted Average using all components"

*c: Using Capabilities Class Dominant Condition Aggregation Method

Soils data provided by USDA and NRCS.