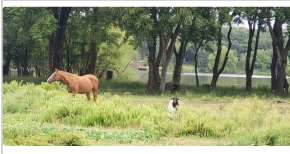

MULTIPLE BUILDING PROPERTY SUMMARY

	Beds N/A	Full Baths N/A	Half Baths N/A	Sale Price N/A	Sale Date N/A
	Bldg Sq Ft 1,768	Lot Sq Ft 153,462	Yr Built 2008	Type MBL HM	

OWNER INFORMATION			
Owner Name	Rodriguez Consuelo	Owner Vesting	
Owner Name 2		Owner Occupied	Yes
Tax Billing Address	693 Old Lake Rd	Land Tenure Code	
Tax Billing City & State	Smithville, TX	Ownership Right Vesting	
Tax Billing Zip	78957	DMA No Mail Flag	
Tax Billing Zip+4	2065		

LOCATION INFORMATION			
School District	S03	Mapsco	50-J
School District Name	Smithville ISD	MLS Area	SV
Census Tract	9506.01	Zip Code	78957
Subdivision	Lomas, L	Zip + 4	2065
6th Grade School District/School Name		Flood Zone Date	01/19/2006
Elementary School District		Flood Zone Code	A
Middle School District/School Name		Flood Zone Panel	48021C0510E
Neighborhood Code	1905-1905	Carrier Route	R003
Waterfront Influence		Neighborhood Name	
High School District/School Name			

TAX INFORMATION			
Property ID 1	95779	Tax Area (113)	G01
Property ID 2	R95779	Tax Appraisal Area	G01
Property ID 3	000000095779	% Improved	53%
Legal Description	A46 - LOMAS, L, TRACT 1, ACRES 3.523, S/N AL2903R971659A/B, L/N NTA0689349/50		
Actual Tax Year		Block	
Actual Tax		Lot	1
Exemption(s)	Homestead		

ASSESSMENT & TAX				
Assessment Year	2022 - Preliminary	2021	2020	2019
Market Value - Total	\$128,087	\$88,368	\$92,136	\$76,358
Market Value - Land	\$68,194	\$41,730	\$48,620	\$33,845
Market Value - Improved	\$59,893	\$46,638	\$43,516	\$42,513
Assessed Value - Total	\$97,205	\$88,368	\$83,994	\$76,358
Assessed Value - Land		\$41,730		\$33,845
Assessed Value - Improved		\$46,638		\$42,513
YOY Assessed Change (\$)	\$8,837	\$4,374	\$7,636	
YOY Assessed Change (%)	10%	5.21%	10%	
Exempt Building Value				
Exempt Land Value				
Exempt Total Value				
Gross Tax (2013/2014 School; 2014 County & Village)				
Tax Amount - Estimated	Tax Year	Change (\$)	Change (%)	
\$1,571	2020			
\$1,522	2021	-\$49	-3.11%	
\$1,674	2022	\$152	10%	
Jurisdiction	Tax Type	Tax Amount	Tax Rate	

Bastrop County	Estimated	\$413.32	.4252
County Rd	Estimated	\$94.09	.0968
Smithville ISD	Estimated	\$1,166.75	1.2003
Total Estimated Tax Rate			1.7223

CHARACTERISTICS			
County Use Code		Pool	
State Use	Mobile Home W/Land	Foundation	
Land Use	Mobile Home	Other Impvs	
Land Use Category		Other Rooms	
Lot Acres	3.523	# of Buildings	2
Lot Shape		3/4 Baths	
Basement Type		Area of Recreation Room	
Total Adj Bldg Area		Attic Type	
Gross Area	1,768	Bsmt Finish	
Building Sq Ft	1,768	Building Type	Mobile Home
Above Gnd Sq Ft		Carport Area	
Basement Sq Feet		3rd Floor Area	
Ground Floor Area	1,768	Additions Made	
Main Area		Area of Attic	
2nd Floor Area		Area Under Canopy	
Area Above 3rd Floor		Basement Rooms	
Finished Basement Area		Bldg Frame Material	
Unfinished Basement Area		Building Comments	
Heated Area		Ceiling Height	
Garage Type		Dining Rooms	
Garage Sq Ft		Elec Svs Type	
Garage Capacity		Elevator	
Garage 2 Sq Ft		Electric Service Type	
Style		Equipment	
Building Width		Family Rooms	
Building Depth		Fireplace	
Stories		Heat Fuel Type	
Condition		Lot Depth	
Quality		Flooring Material	
Bldg Class		Fuel Type	
Total Units		Location Type	
Total Rooms		Lot Area	153,462
Bedrooms		Lot Frontage	
Total Baths		No. Of Passenger Elevator	
Full Baths		No. of Porches	
Half Baths		No. Parking Spaces	
Bath Fixtures		Parking Type	
Fireplaces		Patio/Deck 1 Area	120
Condo Amenities		Paved Parking Area	
Water		Plumbing	
Sewer		Porch 1 Area	
Cooling Type		Primary Addition Area	
Heat Type		Railroad Spur	
Porch		No. of Dormer Windows	
Patio Type	Deck	No. of Patios	2
Roof Type		No. of Vacant Units	
Roof Material		Num Stories	
Roof Frame		Patio/Deck 2 Area	
Roof Shape		Perimeter of Building	
Construction		Porch Type	
Interior Wall		Rental Area	
Exterior		Sec Patio Area	128
Floor Cover		Sprinkler Type	
Year Built	2008	Utilities	
Building Remodel Year		Lower Level Area	
Effective Year Built		County Use Description	
Pool Size			

FEATURES					
Feature Type	Unit	Size/Qty	Width	Depth	Year Built

Main Area	S	1,768	2008
Deck	S	120	2008
Deck	S	128	2008
Storage Building	S	192	2008

Feature Type	Value
Main Area	\$33,041
Deck	\$358
Deck	\$801
Storage Building	\$1,059

Building Description	Building Size
----------------------	---------------

SELL SCORE			
Rating	Low	Value As Of	2022-07-10 07:14:01
Sell Score	470		

ESTIMATED VALUE			
RealAVM™		Confidence Score	
RealAVM™ Range		Forecast Standard Deviation	
Value As Of			

(1) RealAVM™ is a CoreLogic® derived value and should not be used in lieu of an appraisal. This represents an estimated sale price for this property. It is not the same as the opinion of value in an appraisal developed by a licensed appraiser under the Uniform Standards of Professional Appraisal Practice.

(2) The Confidence Score is a measure of the extent to which sales data, property information, and comparable sales support the property valuation analysis process. The confidence score range is 50 - 100. Clear and consistent quality and quantity of data drive higher confidence scores while lower confidence scores indicate diversity in data, lower quality and quantity of data, and/or limited similarity of the subject property to comparable sales.

(3) The FSD denotes confidence in an AVM estimate and uses a consistent scale and meaning to generate a standardized confidence metric. The FSD is a statistic that measures the likely range or dispersion an AVM estimate will fall within, based on the consistency of the information available to the AVM at the time of estimation. The FSD can be used to create confidence that the true value has a statistical degree of certainty.

LISTING INFORMATION			
MLS Listing Number	6629460	Listing Date	10/08/2021
MLS Area	SV	MLS Status Change Date	12/01/2021
MLS Status	Withdrawn	Listing Agent Name	604572-Rene Gonzalez
Current Listing Price	\$300,000	Listing Broker Name	JBGODWIN REALTORS WL
Original Listing Price	\$300,000		

MLS Listing #	3781135	8018813	8713465
MLS Status	Withdrawn	Withdrawn	Closed
MLS Listing Date	10/05/2021	08/23/2019	02/23/2015
MLS Orig Listing Price	\$475,000	\$239,000	\$89,900
MLS Listing Price	\$395,000	\$229,000	\$89,900
MLS Close Date			03/27/2015
MLS Listing Close Price			\$60,000
MLS Listing Expiration Date		04/30/2020	01/31/2016
MLS Withdrawn Date			

LAST MARKET SALE & SALES HISTORY	
Recording Date	02/05/2004
Sale/Settlement Date	01/27/2004
Document Number	1407-407
Document Type	Gift Deed
Buyer Name	Gann Paul
Seller Name	Gann Elzie A & Doris J S
Multi/Split Sale Type	Multi

MORTGAGE HISTORY	
Mortgage Date	01/06/2014
Mortgage Amount	\$4,502
Mortgage Lender	Private Individual
Mortgage Type	Private Party Lender
Mortgage Code	Refi

FORECLOSURE HISTORY	
---------------------	--

Document Type

Default Date

Foreclosure Filing Date

Recording Date

Document Number

Book Number

Page Number

Default Amount

Final Judgment Amount

Original Doc Date

Original Document Number

Original Book Page

Buyer 2

Buyer Ownership Rights

Buyer 4

Seller 2

Trustee Name

Trustee Sale Order Number

Buyer 1

Buyer 3

Buyer Etal

Buyer Relationship Type

Lender Name

Lien Type

Mortgage Amount

Seller 1

Title Company

Trustee Phone

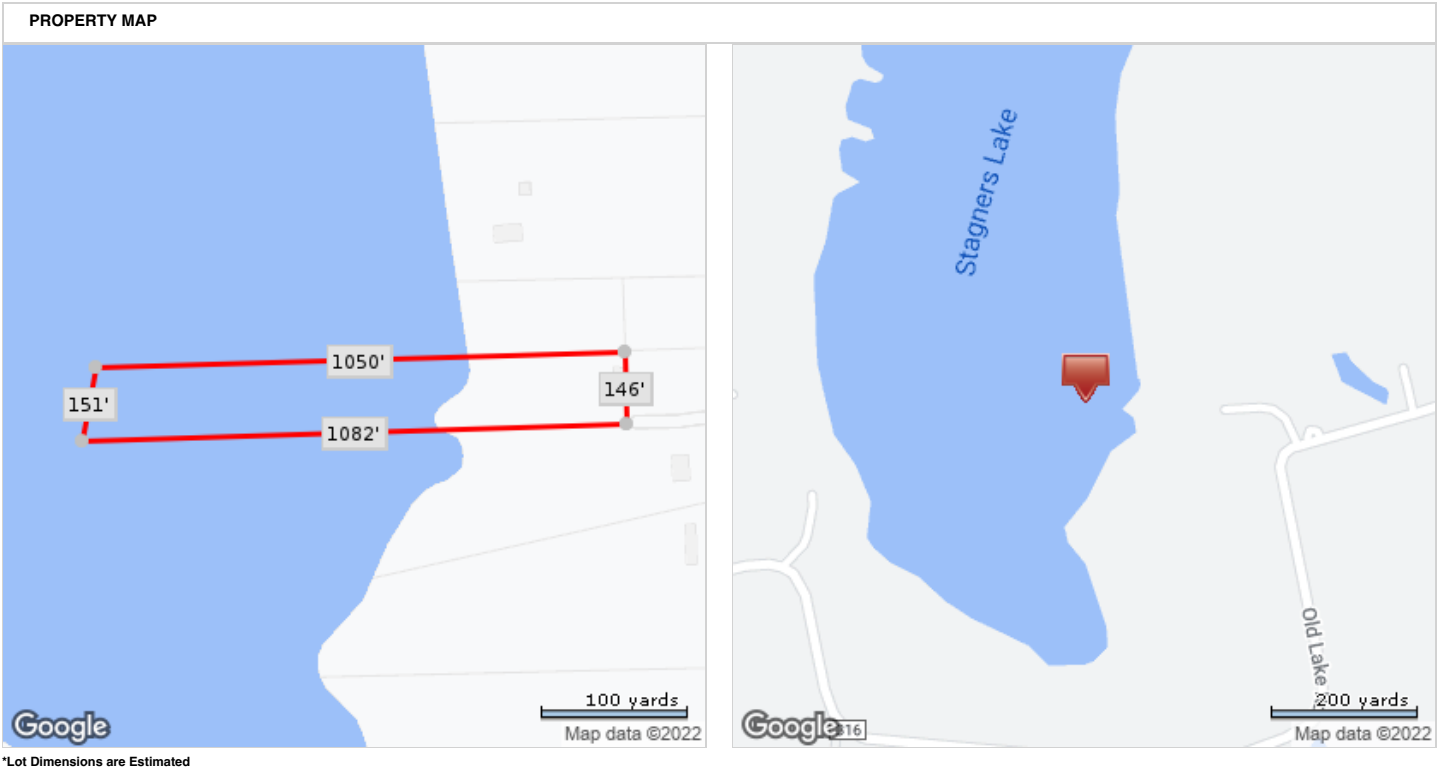

BUILDING 1 OF 2			
CHARACTERISTICS			
County Use Code	Mobile Home W/Land Mobile Home	Pool	
State Use		Foundation	
Land Use		Other Impvs	
Land Use Category		Other Rooms	
Lot Acres	3.523	# of Buildings	
Lot Shape		3/4 Baths	

Basement Type	
Total Adj Bldg Area	
Gross Area	1,768
Building Sq Ft	1,768
Above Gnd Sq Ft	
Basement Sq Feet	
Ground Floor Area	1,768
Main Area	
2nd Floor Area	
Area Above 3rd Floor	
Finished Basement Area	
Unfinished Basement Area	
Heated Area	
Garage Type	
Garage Sq Ft	
Garage Capacity	
Garage 2 Sq Ft	
Style	
Building Width	
Building Depth	
Stories	
Condition	
Quality	
Bldg Class	
Total Units	
Total Rooms	
Bedrooms	
Total Baths	
Full Baths	
Half Baths	
Bath Fixtures	
Fireplaces	
Condo Amenities	
Water	
Sewer	
Cooling Type	
Heat Type	
Porch	
Patio Type	Deck
Roof Type	
Roof Material	
Roof Frame	
Roof Shape	
Construction	
Interior Wall	
Exterior	
Floor Cover	
Year Built	2008
Building Remodel Year	
Effective Year Built	
Pool Size	

Area of Recreation Room	
Attic Type	
Bsmt Finish	
Building Type	Mobile Home
Carport Area	
3rd Floor Area	
Additions Made	
Area of Attic	
Area Under Canopy	
Basement Rooms	
Bldg Frame Material	
Building Comments	
Ceiling Height	
Dining Rooms	
Elec Svs Type	
Elevator	
Electric Service Type	
Equipment	
Family Rooms	
Fireplace	
Heat Fuel Type	
Lot Depth	
Flooring Material	
Fuel Type	
Location Type	
Lot Area	153,462
Lot Frontage	
No. Of Passenger Elevator	
No. of Porches	
No. Parking Spaces	
Parking Type	
Patio/Deck 1 Area	120
Paved Parking Area	
Plumbing	
Porch 1 Area	
Primary Addition Area	
Railroad Spur	
No. of Dormer Windows	
No. of Patios	2
No. of Vacant Units	
Num Stories	
Patio/Deck 2 Area	
Perimeter of Building	
Porch Type	
Rental Area	
Sec Patio Area	128
Sprinkler Type	
Utilities	
Lower Level Area	
County Use Description	

FEATURES					
Feature Type	Unit	Size/Qty	Width	Depth	Year Built
Main Area	S	1,768			2008
Deck	S	120			2008
Deck	S	128			2008
Storage Building	S	192			2008
Feature Type	Value				
Main Area	\$33,041				
Deck	\$358				
Deck	\$801				
Storage Building	\$1,059				

BUILDING 2 OF 2

CHARACTERISTICS					
County Use Code			Pool		
State Use	Mobile Home W/Land		Foundation		
Land Use	Mobile Home		Other Impvs		
Land Use Category			Other Rooms		
Lot Acres	3.523		# of Buildings		
Lot Shape			3/4 Baths		
Basement Type			Area of Recreation Room		
Total Adj Bldg Area			Attic Type		
Gross Area	1,768		Bsmt Finish		
Building Sq Ft			Building Type	Utility	
Above Gnd Sq Ft			Carport Area		
Basement Sq Feet			3rd Floor Area		
Ground Floor Area			Additions Made		
Main Area			Area of Attic		
2nd Floor Area			Area Under Canopy		
Area Above 3rd Floor			Basement Rooms		
Finished Basement Area			Bldg Frame Material		
Unfinished Basement Area			Building Comments		
Heated Area			Ceiling Height		
Garage Type			Dining Rooms		
Garage Sq Ft			Elec Svs Type		
Garage Capacity			Elevator		
Garage 2 Sq Ft			Electric Service Type		
Style			Equipment		
Building Width			Family Rooms		
Building Depth			Fireplace		
Stories			Heat Fuel Type		
Condition			Lot Depth		
Quality			Flooring Material		
Bldg Class			Fuel Type		
Total Units			Location Type		
Total Rooms			Lot Area	153,462	
Bedrooms			Lot Frontage		
Total Baths			No. Of Passenger Elevator		
Full Baths			No. of Porches		
Half Baths			No. Parking Spaces		
Bath Fixtures			Parking Type		
Fireplaces			Patio/Deck 1 Area		
Condo Amenities			Paved Parking Area		
Water			Plumbing		
Sewer			Porch 1 Area		
Cooling Type			Primary Addition Area		
Heat Type			Railroad Spur		
Porch			No. of Dormer Windows		
Patio Type			No. of Patios		
Roof Type			No. of Vacant Units		
Roof Material			Num Stories		
Roof Frame			Patio/Deck 2 Area		
Roof Shape			Perimeter of Building		
Construction			Porch Type		
Interior Wall			Rental Area		
Exterior			Sec Patio Area		
Floor Cover			Sprinkler Type		
Year Built	2012		Utilities		
Building Remodel Year			Lower Level Area		
Effective Year Built			County Use Description		
Pool Size					

FEATURES					
Feature Type	Unit	Size/Qty	Width	Depth	Year Built
Utility Package	U	1			2012

Feature Type	Value
Utility Package	\$11,379
Building Description	Building Size