

# Soils Map

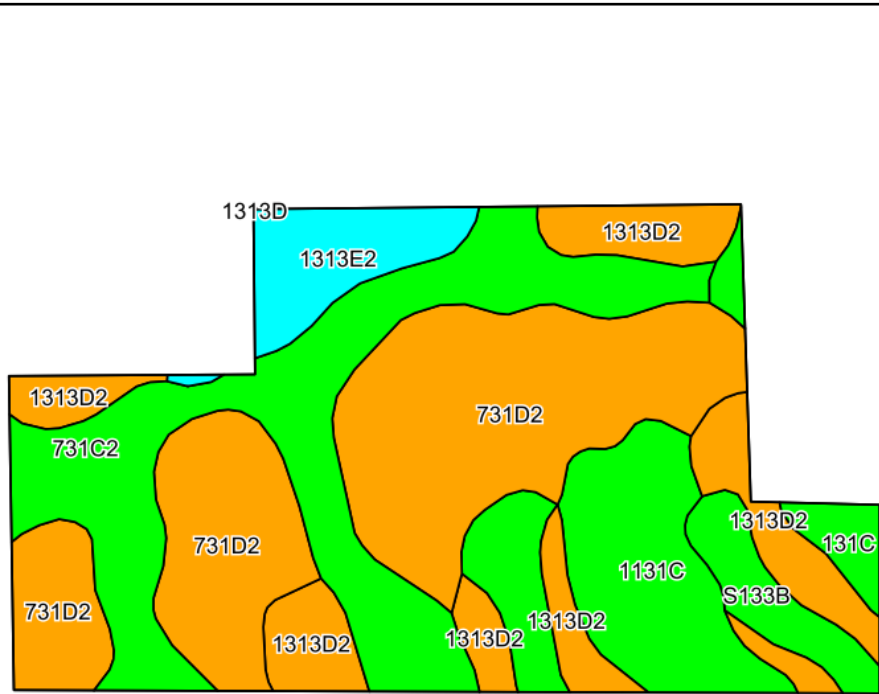

©2022 AgriData, Inc.

Soils data provided by USDA and NRCS.

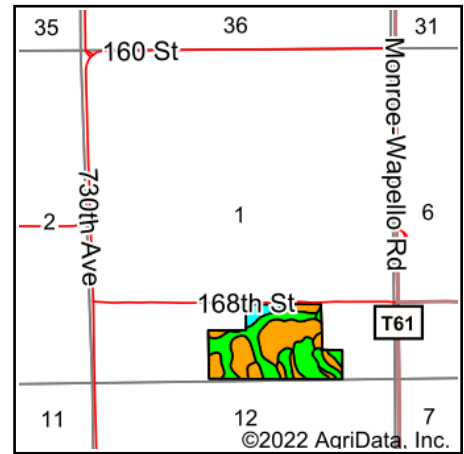

State: **Iowa**  
 County: **Monroe**  
 Location: **1-72N-16W**  
 Township: **Mantua**  
 Acres: **54**  
 Date: **7/13/2022**

**Hawkeye Farm Mgmt & Real Estate**

United Country Real Estate  
 22 N Main, Albion IA Phone: 641-932-7796  
 Email: hawkeye@uciowa.com  
 On the web: www.uciowa.com; www.iowawhitetailfarms.com

Maps Provided By:

**surety**  
 CUSTOMIZED ONLINE MAPPING  
 © AgriData, Inc. 2021 www.AgriDataInc.com



Area Symbol: IA135, Soil Area Version: 29

Code	Soil Description	Acres	Percent of field	CSR2 Legend	Non-Irr Class *c	CSR2**	CSR	*n NCCPI Soybeans
731D2	Pershing silty clay loam, 9 to 14 percent slopes, moderately eroded	18.66	34.6%		IVe	38	31	54
731C2	Pershing silty clay loam, 5 to 9 percent slopes, moderately eroded	13.30	24.6%		IIIe	62	45	57
1313D2	Munterville silt loam, 9 to 14 percent slopes, moderately eroded	8.07	14.9%		VIe	34	10	43
1131C	Pershing silt loam, terrace, 5 to 9 percent slopes	5.67	10.5%		IIIe	67	49	69
S133B	Colo silty clay loam, heavy till, 2 to 5 percent slopes, rarely flooded	3.96	7.3%		IIw	80		83
1313E2	Munterville silt loam, 14 to 18 percent slopes, moderately eroded	3.04	5.6%		VIe	22	5	40
131C	Pershing silt loam, 5 to 9 percent slopes	1.30	2.4%		IIIe	65	49	59
<b>Weighted Average</b>					<b>3.89</b>	<b>49.2</b>	<b>*-</b>	<b>*n 56.1</b>

\*\*IA has updated the CSR values for each county to CSR2.

\*- CSR weighted average cannot be calculated on the current soils data, use prior data version for csr values.

\*n: The aggregation method is "Weighted Average using all components"

\*c: Using Capabilities Class Dominant Condition Aggregation Method

Soils data provided by USDA and NRCS.