

Tillable Soils Map

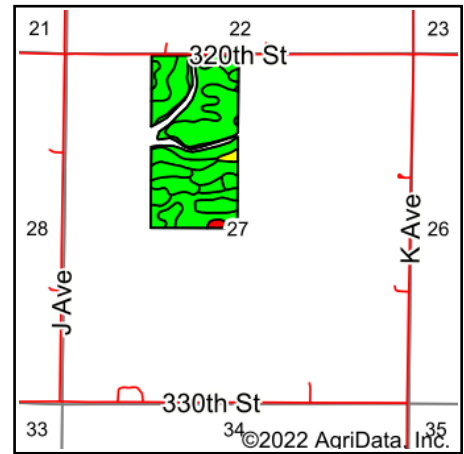

Soils data provided by USDA and NRCS.



State: **Iowa**
 County: **Boone**
 Location: **27-82N-27W**
 Township: **Peoples**
 Acres: **73.82**
 Date: **7/12/2022**

PC PEOPLES
 COMPANY
 INNOVATIVE. REAL ESTATE. SOLUTIONS.

Maps Provided By:

surety
 CUSTOMIZED ONLINE MAPPING
 © AgriData, Inc. 2021 www.AgriDataInc.com



Area Symbol: IA015, Soil Area Version: 29

Code	Soil Description	Acres	Percent of field	CSR2 Legend	Non-Irr Class *c	*i Corn Bu	*i Soybeans Bu	CSR2**	CSR	*n NCCPI Overall
L138C2	Clarion loam, Bemis moraine, 6 to 10 percent slopes, moderately eroded	25.63	34.7%		Ille	0.0	0.0	83		67
585B	Coland-Spillville complex, 2 to 5 percent slopes	16.16	21.9%		Ilw	195.2	56.6	71	70	89
L107	Webster clay loam, Bemis moraine, 0 to 2 percent slopes	13.62	18.5%		Ilw	0.0	0.0	88		84
L138B	Clarion loam, Bemis moraine, 2 to 6 percent slopes	9.67	13.1%		Ile	220.8	64.0	88		80
L55	Nicollet loam, 1 to 3 percent slopes	7.13	9.7%		Ile	0.0	0.0	91		85
L62C2	Storden loam, Bemis moraine, 6 to 10 percent slopes, moderately eroded	0.87	1.2%		Ille	0.0	0.0	64		67
829D2	Zenon-Storden complex, 9 to 14 percent slopes, moderately eroded	0.74	1.0%		IVe	80.0	23.2	20	28	47
Weighted Average					2.28	72.5	21	81.9	*	*n 78.2

**IA has updated the CSR values for each county to CSR2.

*. CSR weighted average cannot be calculated on the current soils data, use prior data version for csr values.

*i Yield data provided by the ISPAID Database version 8.1.1 developed by IA State University.

*n: The aggregation method is "Weighted Average using all components"

*c: Using Capabilities Class Dominant Condition Aggregation Method

Soils data provided by USDA and NRCS.