



**For Sale: 68.25 Taxable Acres, ML
Calhoun Co., near Lake City, Iowa**



Call 641-333-2705 or visit southwestiowaland.com

The information contained in this prospectus was gathered from sources believed to be reliable. We do not guarantee this information and urge the prospective buyer to do further investigation on their own. PPI, Inc. is representing the Seller.



Pudenz 68 Farm – Calhoun Co., IA 68.25 Taxable Acres, ML

Asking Price: \$1,365,000.00

Town: Auburn

County: Sac

State: IA

Taxes: Estimated \$1,788 annually (Sac Co. Treasurer)

Terms: Cash, payable at closing

Land Use: Estimated 68.25 farmland acres, with estimated 65.16 cropland acres (Sac Co. FSA)

Possession: Upon closing

FSA Description: Corn Base 68.09, 117 PLC Yield. (Sac Co. FSA)

CSR Description: CSR2- 87.7 (Surety Maps)

Comments: Brand new listing! Check back for updated comments or contact Listing Agent Tom Miller at 641-333-2705 for more information!

Listing Agent:
Tom Miller
712-621-1281



PPI, Inc. Office Location:
500 W. Temple St
Lenox, IA 50851
Dan Zech, Broker/Owner
Brennan Kester, Broker Assoc./Owner
Mark Pearson, Agent/Owner



Pudenz 68 Farm – Sac County, IA 68.25 Taxable Acres, ML



Tillable



Taxable



Pudenz 68 Farm – Sac County, IA

68.25 Taxable Acres, ML

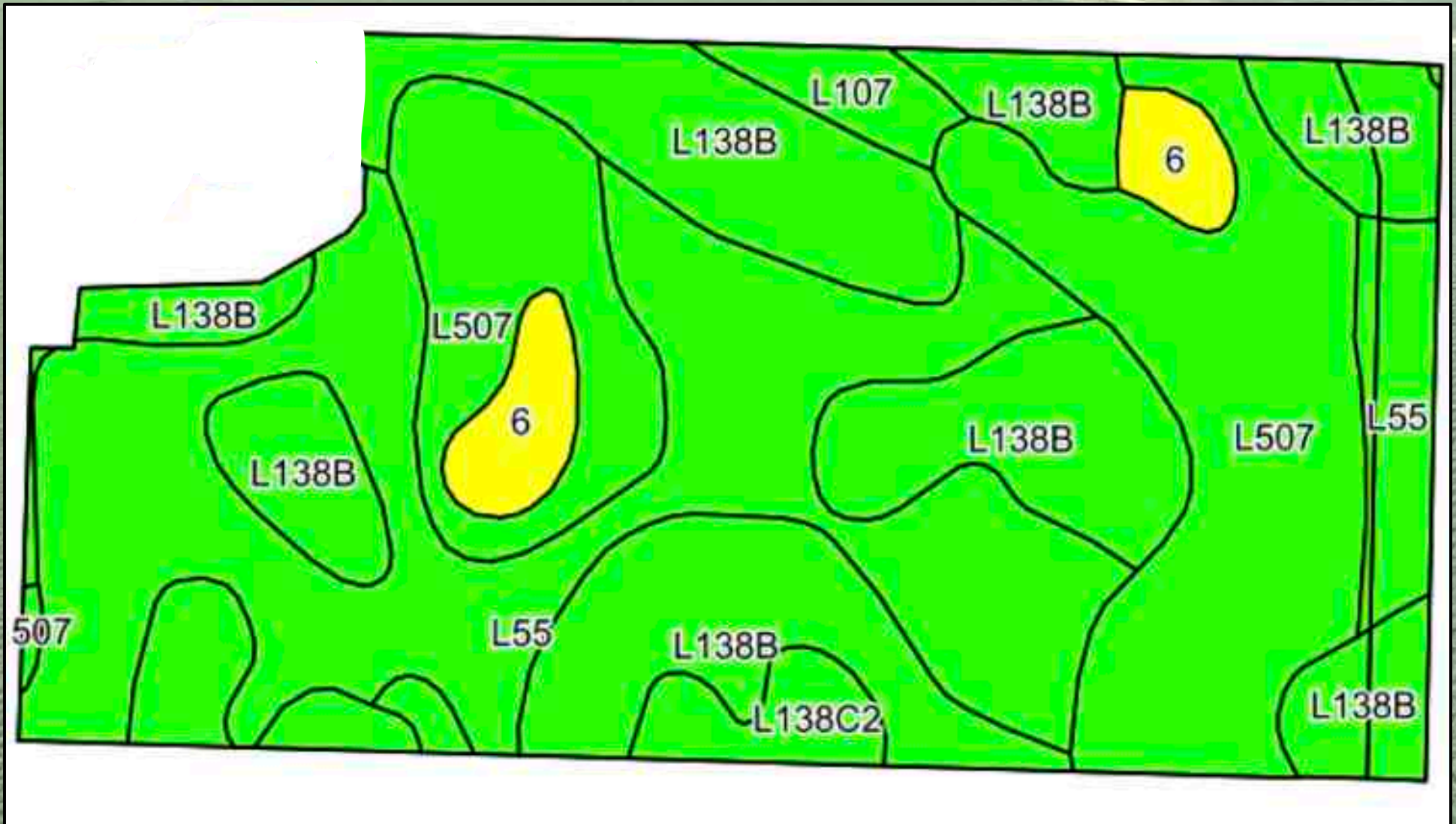



Pudenz 68 Farm – Sac County, IA

68.25 Taxable Acres, ML

Code	Soil Description	Acres	Percent of field	CSR2 Legend	Non-Irr Class *c	*i Corn Bu	*i Alfalfa Tons	*i Soybeans Bu	*i Bluegrass Tons	*i Tall Grasses Tons	CSR2**	CSR
L138B	Clarion loam, Bemis moraine, 2 to 6 percent slopes	25.72	35.8%		lle	80.0	2.2	23.2	1.4	2.4	88	
L55	Nicollet loam, 1 to 3 percent slopes	23.35	32.5%		le	0.0	0.0	0.0	0.0	0.0	91	
L507	Canisteo clay loam, Bemis moraine, 0 to 2 percent slopes	17.38	24.2%		llw	0.0	0.0	0.0	0.0	0.0	87	
6	Okoboji silty clay loam, 0 to 1 percent slopes	2.36	3.3%		lllw	177.6	3.7	51.5	3.2	5.3	59	55
L138C2	Clarion loam, Bemis moraine, 6 to 10 percent slopes, moderately eroded	1.84	2.6%		llle	0.0	0.0	0.0	0.0	0.0	83	
L107	Webster clay loam, Bemis moraine, 0 to 2 percent slopes	1.21	1.7%		llw	0.0	0.0	0.0	0.0	0.0	88	
Weighted Average					1.73	34.5	0.9	10	0.6	1	87.7	*-

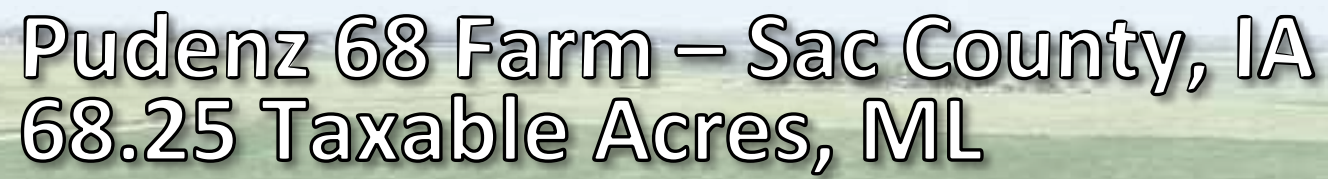



Pudenz 68 Farm – Sac County, IA 68.25 Taxable Acres, ML

Sac County, Iowa

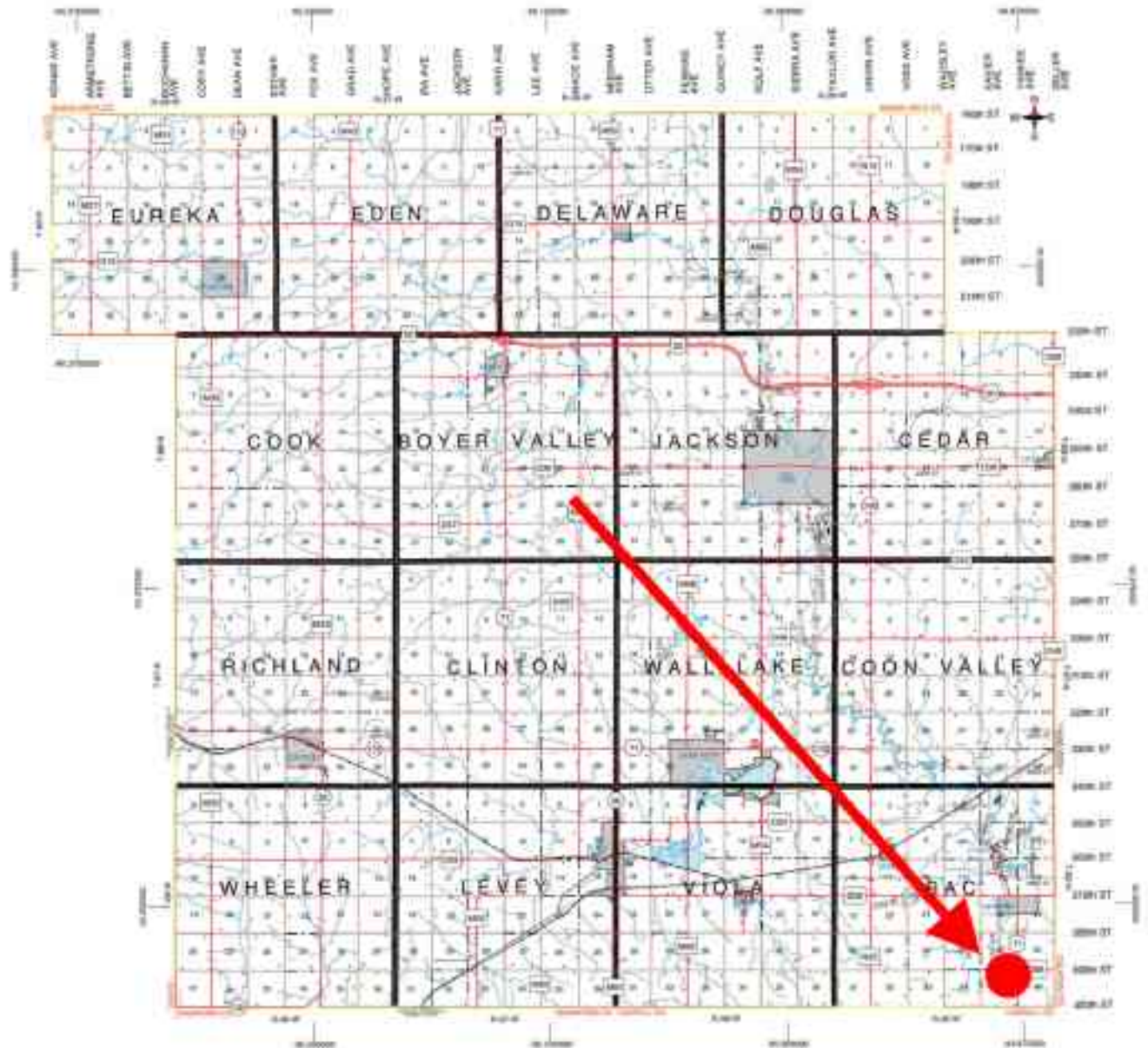



Pudenz 68 Farm – Sac County, IA

68.25 Taxable Acres, ML

