

3296 HWY 93.0  
VERIFIED



# DISTRICT SEVEN HEALTH DEPARTMENT

PROMOTING THE HEALTH OF PEOPLE AND THEIR ENVIRONMENT

## DISTRICT 7 HEALTH DEPT.

104 S. Daisy  
PO Box 280  
Salmon, ID 83467-0280  
Phone: 756-2122  
Fax: 756-6600

June 24, 1998

Gary Goodman  
210 Neyman  
Salmon ID 83467

RE: Clarence Maas sewage permit

The above referenced individual made application for a sewage permit via Michael England. The basis for the permit issuance was the vested rights of the existing structure and the conditions that the original well was to be properly abandoned and replaced with a new well that meets the required setbacks.

The applicant also agreed that the main house would be remodeled for 2 bedrooms and the guest cabin would be limited to one bedroom, no kitchen or clothes washing facilities.

Mike England will be providing an "as-built" drawing that will show system construction and proposed placement of septic tank for guest cabin.

Should you have any questions do not hesitate to contact me at the above telephone number.

Sincerely,

A handwritten signature in cursive script that reads "Steve Adams".

Steve Adams  
Senior EHS

SA/js  
cc: Mike England

## DISTRICT SEVEN HEALTH DEPARTMENT

## SEWER APPLICATION

COUNTY

30

Shaded Area - OFFICE USE ONLY

FEE PAID ☒ Y ☐ N  
CDP #

ON-SITE CONDUCTED ( ) APP ( ) DISAPP

EHS #

DATE

TRAVEL TIME

ON-SITE TIME

NAME

PHONE

MAILING ADDRESS

Clarence W + Shirley Maest

865-2413

Gibbonsville  
STREET/P.O. BOX  
CITY HC 10 BOX 1030 STATE ID. ZIP 83463

PROPERTY ADDRESS

STREET

CITY

Same

ZIP

ORIGINAL OWNER'S NAME

LOT SIZE (ACRES) 1.924

LEGAL DESCRIPTION: TOWNSHIP RANGE SECTION 1/4 SECTION  
SUBDIVISION Parcel No 2 RP 26 N 21 E 146011 A LOT # BLOCK #

BRIEF DIRECTIONS TO PROPERTY: 1 1/2 miles on 93 North of Gibbonsville West side

TYPE OF USE

3 # BEDROOMS

TYPE OF INSTALLATION

WATER SUPPLY

PROPOSED DISPOSAL SYSTEM

( ) SINGLE FAMILY

( ) MULTIPLE FAMILY

( ) COMMERCIAL

( ) OTHER

# EMPLOYEES

( ) NEW

( ) REPLACEMENT

( ) PRIVATE

( ) PUBLIC

SYSTEM NAME

( ) DRAINFIELD ( ) PIT

( ) ABSORPTION BED

( ) BASIC ALTERNATIVE

( ) COMPLEX ALTERNATIVE

\*Additional information may be needed

IF COMMERCIAL/OTHER EXPLAIN

Current Home is 3 Bed. Remodeled one will be 2. Cabin will be 1 Bed.

PLEASE COMPLETE THE GEOLOGICAL INFORMATION (IF KNOWN)

HIGHEST NORMAL GROUNDWATER DEPTH 8' FT. DEPTH TO BEDROCK 8' ROCK OUTCROPS

DESCRIBE SOIL (AT PROPOSED DEPTH OF DRAINFIELD)

( ) HILLSIDE

( ) FLAT

( ) YES

( ) NO

NEAREST: SURFACE WATER WELL 100' SEPTIC

The information provided on this application is accurate to the best of my knowledge. I understand that any false statements may result in disapproval of this permit. If this subsurface sewage disposal installation is constructed by anyone other than the home/landowner or a licensed septic installer, the installation will not be inspected or approved. Section 1-3006.01 - 1-3007.01.

I am the: Landowner

Licensed Septic Installer

Building Contractor

Installer License # 2988

I hereby authorize the health authority to have access to this property for the purpose of performing the requested services and I certify that all the above information is accurate.

APPLICANT SIGNATURE

DATE 5-29-98

well

# DIAGRAM OF PROPERTY

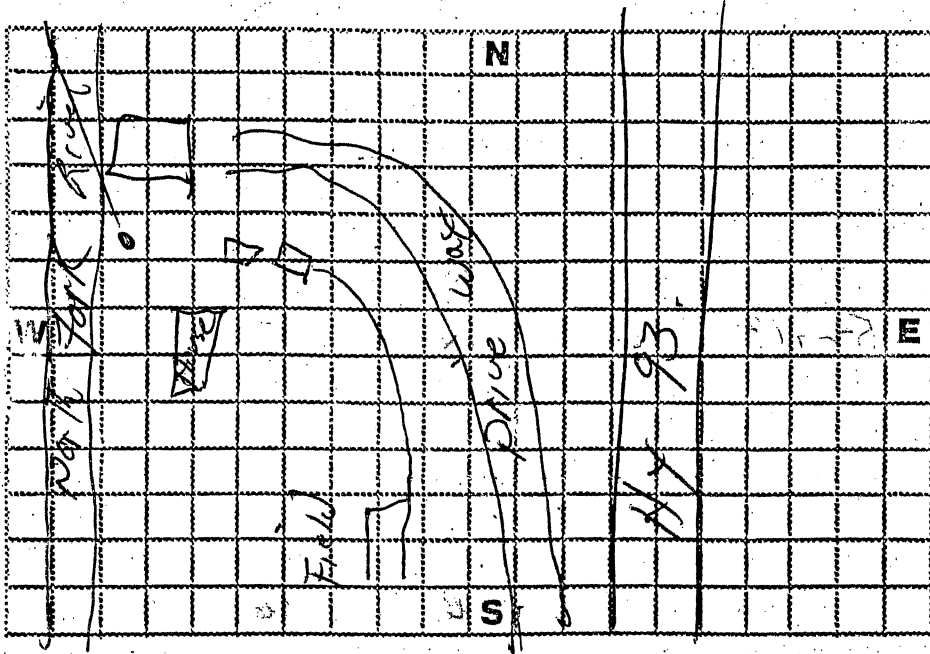

## FURTHER INFORMATION TO BE CONSIDERED:

1. Indicate the distance to adjacent property owner's well and sewage disposal system.
2. Show rock out-crop location.
3. Location of all buildings, corrals, etc. (existing or proposed).
4. Indicate any easements or right of ways if known.
5. Dwelling location from property lines if known.

## SAMPLE PROPERTY DIAGRAM AND SEPARATION DISTANCE REQUIREMENTS:

In addition to requirements shown below:

Wells should be 50'+ from surface water and 10' or more from property lines and basements.

Septic Tanks should be at least 100' from wells used for public drinking water, 50' from others; 25' from public water lines, 10' from others; 25' from canals; and 5' from property lines.

Drainfields should be at least 100' from all wells; 25' from pressure water lines; 100' from suction water lines; 10' from building crawl space or slab; 20' from basement; and 25'-75' from downslope cut, depending on soil type and strata

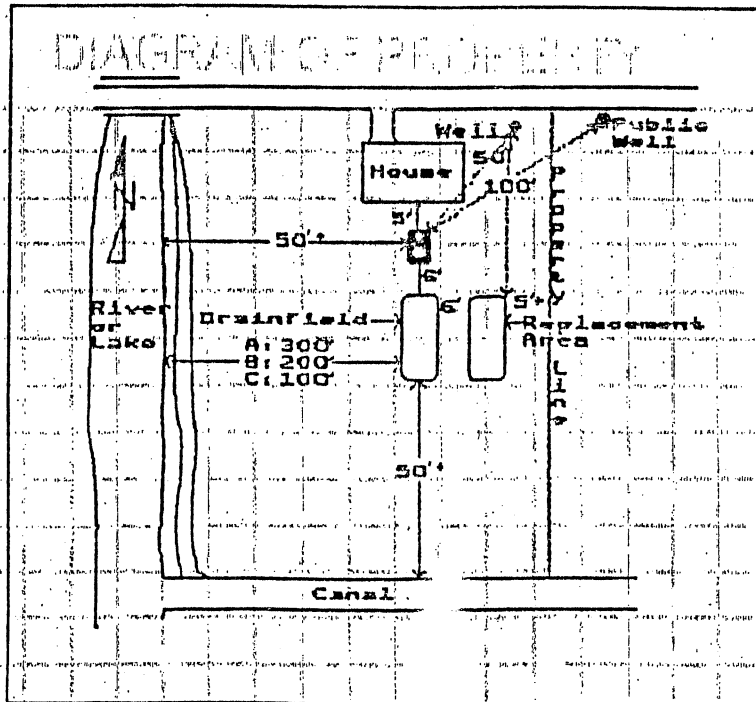

## See separate requirements for large system of 2500 gallons or more per day

## FURTHER INFORMATION TO BE CONSIDERED:

1. Indicate the distance to adjacent property owner's well and sewage disposal system.

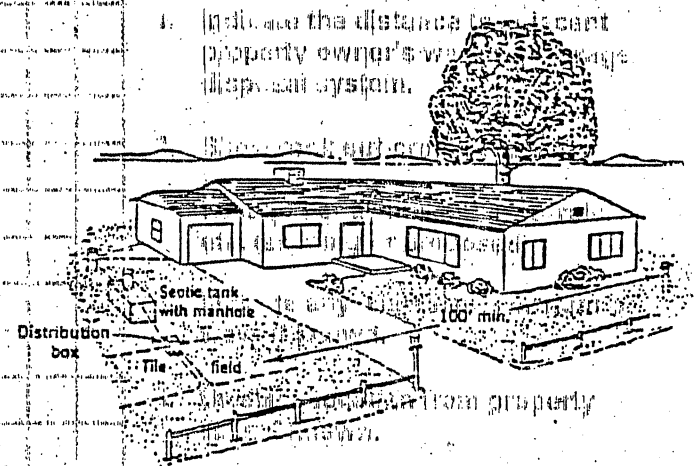

# DISTRICT SEVEN HEALTH DEPARTMENT SEPTIC PERMIT

\*NOTE\* THIS PERMIT IS ONLY VALID FOR ONE YEAR FROM DATE OF ISSUE

7/96

Installation shall comply with all the requirements of the Health District and Idaho's Individual Subsurface Sewage Disposal Regulations as stated below. Failure to install system in compliance with permit will cause disapproval by District 7 and possible legal action.

CDP No. 129546 T-Code: 234 Time: 15 MIN Permit No. 98-62  
Receipt No. \_\_\_\_\_

Permit Issued To: Name CLARENCE MAAS Phone 865-2413

For Location: Address HC 10 BOX 1030 City LIBBONSVILLE Zip 83463

Legal Description: 1/4 Section \_\_\_\_\_ Section 00 Township 26N Range 21E

Subdivision \_\_\_\_\_ Lot \_\_\_\_\_ Block \_\_\_\_\_

INSTALLER: ENGLAND

## SEPTIC TANK SPECIFICATIONS (minimums)

Size of Septic Tank: 1000 gallons Multiple tank (If using or required): \_\_\_\_\_ Total gallons  
First tank: \_\_\_\_\_ gallons Second tank: \_\_\_\_\_ gallons  
Pump Chamber (if required): \_\_\_\_\_ gallons

## SEWAGE DISPOSAL (DRAINFIELD) SPECIFICATIONS (minimums)

Type(s) of Standard Sewage Disposal System Permitted: Trench ☒ Bed \_\_\_\_\_ Pit \_\_\_\_\_ Gravelless ☒  
Basic Alternative Privy \_\_\_\_\_ Steep Slope System \_\_\_\_\_ Capping Fill \_\_\_\_\_ Extra Drain-rock Trench \_\_\_\_\_

Type(s) of Complex Alternative Disposal System Permitted: Sand Filter Intermittent \_\_\_\_\_ Sand Filter Intrench \_\_\_\_\_  
Sand Mound \_\_\_\_\_ Lagoon \_\_\_\_\_ Extended Treatment Systems \_\_\_\_\_ Large Soil Absorption Systems \_\_\_\_\_  
Other \_\_\_\_\_

\*Complex Alternative Disposal Systems are required to be installed by a licensed complex installer\*

SOIL TYPE B  
DISPOSAL AREA SIZE: 500 Sq. Ft. MAXIMUM DEPTH OF EXCAVATION: \* Feet

DISTANCE TO NEAREST SURFACE WATER (explanation): SYSTEM MUST BE FT. FROM THE NEAREST  
SURFACE WATER -

## SPECIAL CONDITIONS

\*  
~~PERMIT ISSUED UNDER VESTED RIGHTS. THIS IS NON CONFORMING PERMIT AS TO THE DISTANCE TO THE NORTH FORK OF THE SALMON RIVER DUE TO LIMITATIONS OF PROPERTY SIZE. APPLICANT STATES THAT THIS IS FOR 3 BEDROOMS, 2 IN MAIN HOUSE, 1 IN THE CABIN. CABIN IS NOT FOR SEPARATE LIVING FACILITIES, JUST GUEST BEDROOM. ORIGINAL WELL TO BE PROPERLY ABANDONED AND NEW WELL TO MEET REQUIRED SETBACKS.~~

I hereby agree that the system will be installed as per the permit and will not make any changes from the permit without written approval from District 7. I also hereby authorize access to this property for purpose of inspection.

Applicant/Agent Signature Mike England by JS Date: 6/16/98

ISSUED BY EHS Steve Maas # 29 Date: 6/16/98

\*Note\* Other requirements on reverse side of permit: EXPIRES 6/16/99

## **OTHER SEPTIC REQUIREMENTS**

### **SEPTIC TANK:**

All septic tanks must come from a distributor who has had their tanks inspected and are state approved. If you have any questions regarding the tank you are buying please contact District Seven and we will inform you if that tank has been approved. Homeowner built tank must receive special approval before being allowed to be installed.

All septic tanks must be located at least 100 feet from a public well, spring or suction line, and must be 25 feet from the public water distribution line. They must also be located at least 50 feet from a private public well, spring or suction line and 10 feet from the private distribution line. Tanks must be no closer than 5 feet to the nearest property line. The septic tank must be located at least 50 feet from any stream, river, lake, pond or where the surface water remains continuously for more than two months a year. Septic tanks also must be located at least 25 feet from any ditch or canal or where temporary surface water exists continuously less than 2 months a year. Septic tanks must not be installed closer than 5 feet to any dwelling foundation, deck or concrete patio, etc. Septic tanks cannot be installed inside any structure. If there is a cut in the soil causing a scarp or steep slope the septic tank must be 25 feet from that slope. Caution should be used in installing septic tanks in high groundwater or sub-water and in no case can the top of the tank be closer than 2 feet from the seasonal high water level.

### **DRAINFIELDS/DISPOSAL AREAS:**

Your permit has designated what type of disposal system(s) will be allowed to be constructed on the location identified on the front of the permit. Only the type system(s) marked is approved for construction. Any change of system will have to be approved and a new permit issued prior to construction. There will not be a new permit fee for this service, so please contact us if you desire to make any changes to this permit.

All drainfield/disposal sites must be located at least 100 feet from a public well, spring or suction line. The drainfield must be 25 feet from any pressure distribution line and should the distribution line be a suction line then the drainfield must be located 100 feet from such a line. Drainfields must not be constructed closer than 5 feet to the nearest property line. The foundation determines how close the drainfield can be installed to a dwelling. If there is a basement the drainfield must be at least 20 feet from the basement; you must be 10 feet from the crawl space, deck or concrete patio, etc. If there is a cut in the soil causing a scarp or steep slope, the drainfield must either be located 25, 50 or 75 feet from that slope depending on the type of soil, this will be addressed under special conditions. Caution should be used in installing septic tanks in high ground water or sub-water. Depending on the type of soil your system is being installed in and the soil's ability to treat the wastewater determines the separation from the bottom of your septic system and that groundwater. The maximum installation depth shown on your permit must be followed and you are not allowed to construct your system any deeper than marked. Failure to comply with this requirement will automatically cause your system to be disapproved and action taken.

The drainfield must be located at least the minimum distance shown on the permit from any stream, river, lake, pond or where the surface water remains continuously for more than two months a year. This distance shown is based on the ability of that soil to treat the wastewater. Drainfields must be located at least 50 feet from any ditch or canal or where temporary surface water exists continuously less than 2 months a year. Failure to comply with this requirement will automatically cause your system to be disapproved and action taken.

**It is necessary to have your septic system inspected prior to covering to determine if your system is installed according to the permit issued and is in compliance with the regulations. We need at least 24 hours notice in order for us to schedule the time to make an inspection. To avoid unnecessary delays and inconveniences to you or the installer, please call us in advance.**

**For inspection purposes the system should be completely installed, but not covered.**



## ALTERNATIVE SYSTEM INSPECTION SUPPLEMENT

Permit # 98-62Name Greg Maas

## PRESSURE DISTRIBUTION SYSTEM

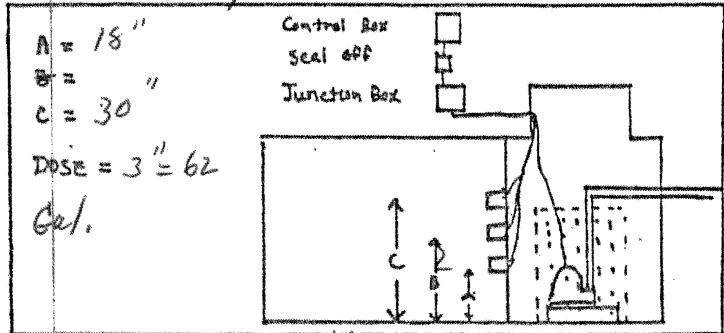
INSTALLER M. EnglandDOSING TANK: Size 3000 Manufacturer Dalhe Watertight/grouted? yesSeptic tank filter or pump screen manufacturer O.S.I. Model P.V. 1548ELECTRICAL: Visual/audio alarm on separate circuit? yes Wires in conduit? noControl box model O.S.I. A-1Seal-off model yesPUMP: Mfr. Stay-Rite Model P200511 H.P. 1/2 Voltage 120.For effluent? yes Quick disconnect yes Size of discharge 1.25Elevation difference between pump and laterals 15'TRANSPORT PIPE: Type Sch 40 Size 1.25 Length 50'MANIFOLD: Type Sch 40 Size 1.25 Length 12'LATERALS: Type Sch 40 Size 1.25 Length 48'ORIFACES: Size 1/8 Spacing 2' Oriented upEnd caps or interconnected laterals? End capsSystem tested for uniform distribution? yes (65')IN FILTER Drain Field

SKETCH

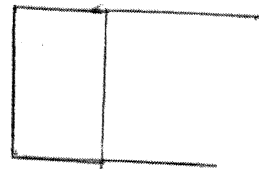
see Attachment

## INTERMITTENT SAND FILTER

ASTM C-33 \_\_\_\_\_ Source 1 Quantity \_\_\_\_\_

Container type \_\_\_\_\_ Size \_\_\_\_\_

Watertight and meets all other requirements of the Technical Guidance Manual, and constructed according to approved plans? \_\_\_\_\_

## INTRENCH SAND FILTER Pressure Gravity

ASTM C-33 \_\_\_\_\_ Source \_\_\_\_\_ Depth \_\_\_\_\_

## SAND MOUND Dimensions

ASTM C-33 \_\_\_\_\_ Source \_\_\_\_\_ Quantity \_\_\_\_\_

Bed dimensions \_\_\_\_\_ Sand below bed \_\_\_\_\_

Basal area ripped or scarified? \_\_\_\_\_

Pneumatic-tired vehicles used? \_\_\_\_\_

Standpipe installed in bed? \_\_\_\_\_

Notes  
June 25, 1998

Maass  
North of  
Gibbsonsville

N.

6-15-98

