

# Soils Map

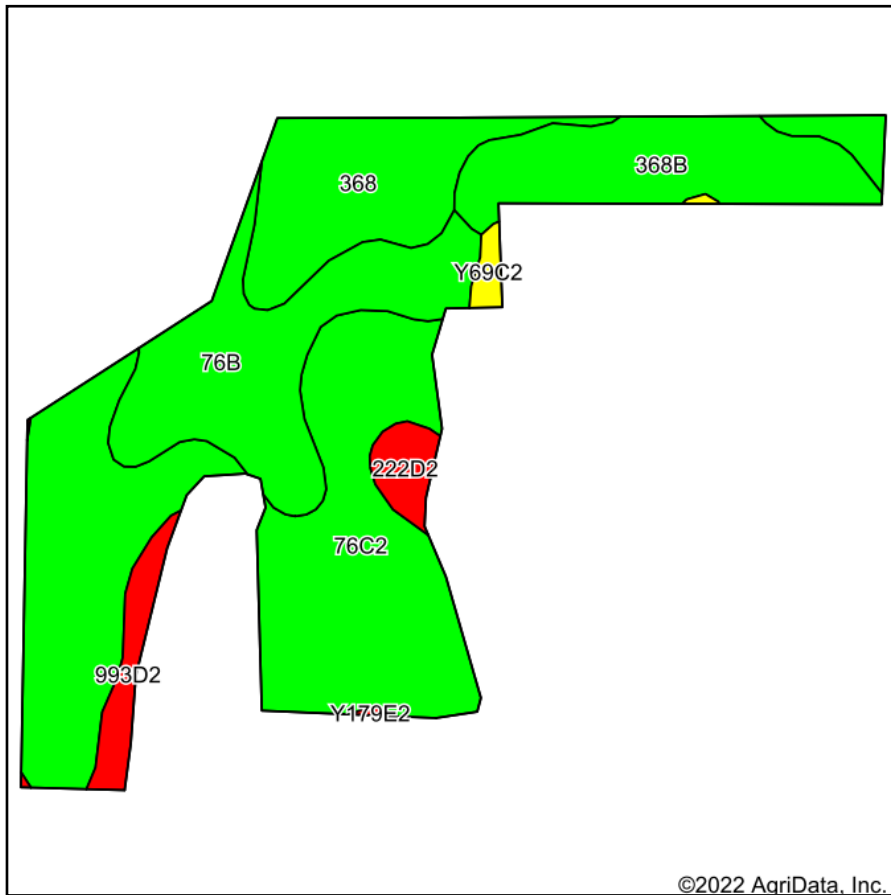

Soils data provided by USDA and NRCS.

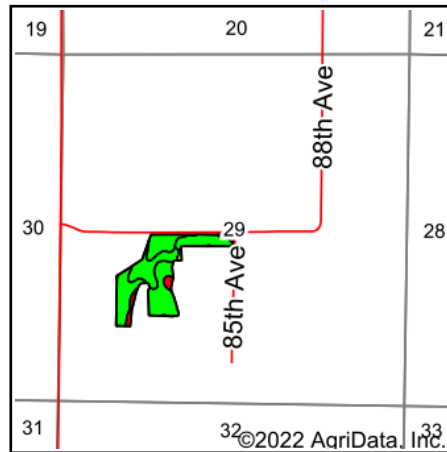

State: **Iowa**  
 County: **Warren**  
 Location: **29-75N-24W**  
 Township: **White Oak**  
 Acres: **22.53**  
 Date: **7/21/2022**



Maps Provided By:



© AgriData, Inc. 2021

www.AgriDataInc.com



Area Symbol: IA181, Soil Area Version: 26

Code	Soil Description	Acres	Percent of field	CSR2 Legend	Non-Irr Class *c	CSR2**	CSR	*n NCCPI Overall	*n NCCPI Corn	*n NCCPI Small Grains	*n NCCPI Soybeans	
76C2	Ladoga silt loam, dissected till plain, 5 to 9 percent slopes, eroded	10.14	45.0%		IIle	75	65	78	78	69	66	
76B	Ladoga silt loam, 2 to 5 percent slopes	4.34	19.3%		Ile	86	85	84	84	77	78	
368	Macksburg silty clay loam, 0 to 2 percent slopes	3.48	15.4%		Iw	93	95	87	87	78	79	
368B	Macksburg silty clay loam, 2 to 5 percent slopes	3.13	13.9%		Ile	89	90	87	87	79	78	
993D2	Armstrong-Gara loams, 9 to 14 percent slopes, moderately eroded	0.72	3.2%		IVe	23	20	68	68	52	47	
222D2	Clarinda silty clay loam, dissected till plain, 9 to 14 percent slopes, eroded	0.50	2.2%		IVe	17	10	57	57	49	47	
Y69C2	Clearfield silty clay loam, dissected till plain, 5 to 9 percent slopes, eroded	0.22	1.0%		IIIw	56		67	67	65	59	
<b>Weighted Average</b>						<b>2.41</b>	<b>78.7</b>	<b>*-</b>	<b>*n 80.9</b>	<b>*n 80.9</b>	<b>*n 72.3</b>	<b>*n 70.9</b>

\*\*IA has updated the CSR values for each county to CSR2.

\*- CSR weighted average cannot be calculated on the current soils data, use prior data version for csr values.

\*n: The aggregation method is "Weighted Average using all components"

\*c: Using Capabilities Class Dominant Condition Aggregation Method

Soils data provided by USDA and NRCS.