

David J. + Tara K.



SELLER'S DISCLOSURE AND CONDITION OF PROPERTY ADDENDUM

(Land)

(IF PROPERTY IS IMPROVED, USE IN CONJUNCTION WITH THE APPROPRIATE SELLER'S
DISCLOSURE AND CONDITION OF PROPERTY ADDENDUM)

SELLER (Indicate Marital Status): David + Tara Tidman married

LEGAL DESCRIPTION: (As described in the attached Legal Description/Company Disclosure Addendum, or described below)

Approximate date SELLER purchased Property: _____ Property is currently zoned as _____

1. NOTICE TO SELLER.

Be as complete and accurate as possible when answering the questions in this disclosure. Attach additional sheets if space is insufficient for all applicable comments. SELLER understands that the law requires disclosure of any material defects, known to SELLER, in the Property to prospective Buyer(s) and that failure to do so may result in civil liability for damages. This disclosure statement is designed to assist SELLER in making these disclosures. Licensee(s), prospective buyers and buyers will rely on this information.

2. NOTICE TO BUYER.

This is a disclosure of SELLER'S knowledge of the Property as of the date signed by SELLER and is not a substitute for any inspections or warranties that BUYER may wish to obtain. It is not a warranty of any kind by SELLER or a warranty or representation by the Broker(s) or their licensees.

3. WATER SOURCE.

- a. Is there a water source on or to the Property? Yes ☒ No ☐
☒ Public ☐ Private ☐ Well ☐ Cistern ☐ None ☐ Other _____
If well, state type _____ depth _____ diameter _____ age _____
Has water been tested? Yes ☐ No ☒
b. Other water systems and their condition: _____
c. Is there a water meter on the Property? Yes ☐ No ☒
d. Is there a rural water certificate? Yes ☐ No ☒
e. Other applicable information: _____

If any of the answers in this section are "Yes", explain in detail or attach documentation: _____

Rural water main running along road frontage of property

4. GAS/ELECTRIC.

- a. Is there electric service on the Property? Yes ☒ No ☐
If "Yes", is there a meter? N/A ☐ Yes ☐ No ☒
b. Is there gas service on the Property? Yes ☐ No ☒
If "Yes", what is the source? gas
c. Are you aware of any additional costs to hook up utilities? Yes ☐ No ☒
d. Other applicable information: _____

If any of the answers in this section are "Yes", explain in detail or attach documentation: _____

Osage Valley Electrical Coop. service line running along road frontage of property

DT JK
SELLER SELLER

Initials _____
BUYER BUYER

5. LAND (SOILS, DRAINAGE AND BOUNDARIES). ARE YOU AWARE OF:

- a. The Property or any portion thereof being located in a flood zone, wetlands area or proposed to be located in such as designated by FEMA which requires flood insurance? Yes ☒ No ☐
- b. Any drainage or flood problems on the Property or adjacent properties? Yes ☐ No ☒
- c. Any neighbors complaining Property causes drainage problems? Yes ☐ No ☒
- d. The Property having had a stake survey? Yes ☒ No ☐
- e. Any boundaries of the Property being marked in any way? Yes ☒ No ☐
- f. Having an Improvement Location Certificate (ILC) for the Property? Yes ☐ No ☒
- g. Any fencing/gates on the Property? Yes ☐ No ☒
If "Yes", does fencing/gates belong to the Property? Yes ☐ No ☐
- h. Any encroachments, boundary line disputes, or non-utility easements affecting the Property? Yes ☐ No ☒
- i. Any expansive soil, fill dirt, sliding, settling, earth movement, upheaval, or earth stability problems that have occurred on the Property or in the immediate vicinity? Yes ☐ No ☒
- j. Any diseased, dead, or damaged trees or shrubs on the Property? Yes ☐ No ☒
- k. Other applicable information: _____

If any of the answers in this section are "Yes" explain in detail or attach all warranty information and other documentation: Property has some acres in a flood zone, but enough upland to build on
Survey will be completed upon signing of contract
Corners + boundaries will be marked after survey is complete

6. SEWAGE.

- a. Does the Property have any sewage facilities on or connected to it? Yes ☐ No ☒
If "Yes", are they:
☐ Public Sewer ☐ Private Sewer ☐ Septic System ☐ Cesspool
☐ Lagoon ☐ Grinder Pump ☐ Other _____
If applicable, when last serviced? _____
By whom? _____
Approximate location of septic tank and/or absorption field: _____
Has Property had any surface or subsurface soil testing related to installation of sewage facility? N/A ☐ Yes ☐ No ☒
- b. Are you aware of any problems relating to the sewage facilities? Yes ☐ No ☐

If any of the answers in this section are "Yes", explain in detail or attach all warranty information and other documentation: _____

7. LEASEHOLD AND TENANT'S RIGHTS, INTERESTS, INCLUDING GAS AND OIL LEASES.

(Check and complete applicable box(es))

- a. Are there leasehold interests in the Property? Yes ☐ No ☒
If "Yes", complete the following:
Lessee is: _____
Contact number is: _____
Seller is responsible for: _____
Lessee is responsible for: _____
Split or Rent is: _____
Agreement between Seller and Lessee shall end on or before: _____
☐ Copy of Lease is attached.

DT JK2 Initials
SELLER SELLER

Initials
BUYER BUYER

- b. Are there tenant's rights in the Property? Yes ☐ No ☒
- If "Yes", complete the following:
- Tenant/Tenant Farmer is: _____
- Contact number is: _____
- Seller is responsible for: _____
- Tenant/Tenant Farmer is responsible for: _____
- Split or Rent is: _____
- Agreement between Seller and Tenant shall end on or before: _____
- ☐ **Copy of Agreement is attached.**
- c. Do additional leasehold interests or tenant's rights exist? Yes ☐ No ☒
- If "Yes", explain: _____

8. MINERAL RIGHTS (unless superseded by local, state or federal laws).

- ☒ Pass unencumbered with the land to the Buyer.
- ☐ Remain with the Seller.
- ☐ Have been previously assigned as follows: _____

9. WATER RIGHTS (unless superseded by local, state or federal laws).

- ☒ Pass unencumbered with the land to the Buyer.
- ☐ Remain with the Seller.
- ☐ Have been previously assigned as follows: _____

10. CROPS (planted at time of sale).

- ☒ Pass with the land to the Buyer.
- ☐ Remain with the Seller.
- ☐ Have been previously assigned as follows: _____

11. GOVERNMENT PROGRAMS.

- a. Are you currently participating, or do you intend to participate, in any government farm program? Yes ☐ No ☒
- b. Are you aware of any interest in all or part of the Property that has been reserved by previous owner or government action to benefit any other property? Yes ☐ No ☒

If any of the answers in this section are "Yes", explain in detail or attach documentation: _____

12. HAZARDOUS CONDITIONS. ARE YOU AWARE OF:

- a. Any underground storage tanks on or near Property? Yes ☐ No ☒
- b. Any previous or current existence of hazardous conditions (e.g., storage tanks, oil tanks, oil spills, tires, batteries, or other hazardous conditions)? Yes ☐ No ☒
- If "Yes", what is the location? _____
- c. Any previous environmental reports (e.g., Phase 1 Environmental reports)? Yes ☐ No ☒
- d. Any disposal of any hazardous waste products, chemicals, polychlorinated biphenyl's (PCB's), hydraulic fluids, solvents, paint, illegal or other drugs or insulation on the Property or adjacent property? Yes ☐ No ☒
- e. Environmental matters (e.g. discoloration of soil or vegetation or oil sheers in wet areas)? Yes ☐ No ☒
- f. Any existing hazardous conditions on the Property or adjacent properties (e.g. methane gas, radon gas, radioactive material, landfill, toxic materials)? Yes ☐ No ☒

DT | KJ Initials
SELLER | SELLER

Initials _____
BUYER | BUYER

- g. Gas/oil wells, lines or storage facilities on the Property or adjacent property? Yes ☐ No ☒
- h. Any other environmental conditions on the Property or adjacent properties? Yes ☐ No ☒
- i. Any tests conducted on the Property? Yes ☐ No ☒

If any of the answers in this section are "Yes" explain in detail or attach documentation: _____

13. OTHER MATTERS. ARE YOU AWARE OF:

- a. Any violation of zoning, setbacks or restrictions, or non-conforming use? Yes ☐ No ☒
- b. Any violation of laws or regulations affecting the Property? Yes ☐ No ☒
- c. Any existing or threatened legal action pertaining to the Property? Yes ☐ No ☒
- d. Any litigation or settlement pertaining to the Property? Yes ☐ No ☒
- e. Any current/pending bonds, assessments, or special taxes that apply to the Property? Yes ☐ No ☒
- f. Any burial grounds on the Property? Yes ☐ No ☒
- g. Any abandoned wells on the Property? Yes ☐ No ☒
- h. Any public authority contemplating condemnation proceedings? Yes ☐ No ☒
- i. Any government rule limiting the future use of the Property other than existing zoning and subdivision regulations? Yes ☐ No ☒
- j. Any condition or proposed change in surrounding area or received any notice of such? Yes ☐ No ☒
- k. Any government plans or discussion of public projects that could lead to special benefit assessment against the Property or any part thereof? Yes ☐ No ☒
- l. Any unrecorded interests affecting the Property? Yes ☐ No ☒
- m. Anything that would interfere with passing clear title to the Buyer? Yes ☐ No ☒
- n. The Property being subject to a right of first refusal? Yes ☐ No ☒
If "Yes", number of days required for notice: _____
- o. The Property subject to a Homeowner's Association fee? Yes ☐ No ☒
- p. Any other conditions that may materially and adversely affect the value or desirability of the Property? Yes ☐ No ☒
- q. Any other condition that may prevent you from completing the sale of the Property? Yes ☐ No ☒

If any of the answers in this section are "Yes", explain in detail or attach documentation: _____

14. UTILITIES. Identify the name and phone number for utilities listed below.

Electric Company Name: Osage Valley Elec. Coop. Phone # 660-679-3131

Gas Company Name: _____ Phone # _____

Water Company Name: P.W.S.D. #4 of Bates County Phone # 417-395-4964

Other: _____ Phone # _____

15. ELECTRONIC SYSTEMS AND COMPONENTS.

Any technology or systems staying with the Property? N/A ☐ Yes ☐ No ☒

If "Yes", list: _____

Upon Closing, SELLER will provide Buyer with codes and passwords, or items will be reset to factory settings.

The undersigned SELLER represents, to the best of their knowledge, the information set forth in the foregoing Disclosure Statement is accurate and complete. SELLER does not intend this Disclosure Statement to be a warranty or guarantee of any kind. SELLER hereby authorizes Licensee assisting SELLER to provide this information to prospective BUYER of the Property and to real estate brokers and licensees. **SELLER will promptly notify Licensee assisting the SELLER, in writing, if any information in this disclosure changes prior to Closing, and Licensee assisting the SELLER will promptly notify Licensee assisting the BUYER, in writing, of such changes. (SELLER and BUYER initial and date any changes and/or any list of additional changes. If attached, # of pages).**

DT JK2 Initials
SELLER | SELLER

Initials _____
BUYER | BUYER

CAREFULLY READ THE TERMS HEREOF BEFORE SIGNING. WHEN SIGNED BY ALL PARTIES, THIS DOCUMENT BECOMES PART OF A LEGALLY BINDING CONTRACT. IF NOT UNDERSTOOD, CONSULT AN ATTORNEY BEFORE SIGNING.

David Tidman 4-4-2022 Ma Adam 4/4/22
SELLER DATE SELLER DATE

BUYER ACKNOWLEDGEMENT AND AGREEMENT

1. I understand and agree the information in this form is limited to information of which SELLER has actual knowledge and SELLER need only make an honest effort at fully revealing the information requested.
2. This Property is being sold to me without warranties or guaranties of any kind by SELLER, Broker(s) or Licensees concerning the condition or value of the Property.
3. I agree to verify any of the above information, and any other important information provided by SELLER or Broker(s) (including any information obtained through the Multiple Listing Service) by an independent investigation of my own. I have been specifically advised to have the Property examined by professional inspectors. Buyer assumes responsibility Property is suitable for their intended use.
4. I acknowledge neither SELLER nor Broker(s) is an expert at detecting or repairing physical defects in the Property.
5. I specifically represent there are no important representations concerning the condition or value of the Property made by SELLER or Broker(s) on which I am relying except as may be fully set forth in writing and signed by them.

BUYER

DATE

BUYER

DATE

Approved by Legal Counsel of the Kansas City Regional Association of REALTORS® for exclusive use by its REALTOR® members. No warranty is made or implied as to the legal validity or adequacy of this Contract, or that it complies in every respect with the law or that its use is appropriate for all situations. Local law, customs and practices, and differing circumstances in each transaction may dictate that amendments to this Contract be made. Last revised 10/21. All previous versions of this document may no longer be valid. Copyright January 2022.

A diagram showing a map projection. At the top, a curved line represents the Earth's surface with points labeled 'A', 'B', 'C', 'D', 'E', 'F', 'G', 'H', 'I', 'J', 'K', 'L', 'M', 'N', 'O', 'P', 'Q', 'R', 'S', 'T', 'U', 'V', 'W', 'X', 'Y', 'Z'. Below this, a straight line represents the projected map. A vertical line labeled 'C' is shown. Below the map, a graphic scale is provided with markings for 0, 10, 20, 30, 40, 50, 60, 70, 80, 90, 100. Below the scale, the text '(1 INCH = 100 FEET)' is written.

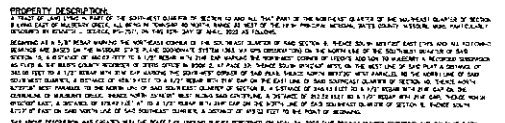

REFERENCE SURVEY:
1. PLAT OF TOWN OF WILDERBY PLAT BOOK 1, PAGE 37.
2. LITCHIE ADDITION TO WILDERBY, MO PLAT BOOK 2, PAGE 32.

SURVEYOR'S CERTIFICATION:
I, JOHN W. BARNES, JR., DO, I FURNISHED AND REGISTERED LAND SURVEY IN THE STATE OF MISSOURI, HEREBY CERTIFY THAT THIS WAS DONE ON PLAT AND THE SURVEY ON WHICH IT WAS BASED, WAS MADE IN ACCORDANCE WITH THE CURRENT MISSOURI STANDARDS FOR PROPERTY BOUNDARY SURVEYS AND WITHIN OR EXCEEDED THE ACCURACY STANDARDS FOR AN ALIQUOT SURVEY. THAT THE SURVEY WAS MADE IN ACCORDANCE WITH THE RULES AND ORDINANCES OF THE MISSOURI BOARD OF SURVEYING AND MAPPING, THAT THE SURVEY WAS COMPLETED IN THE FIELD AND ON THE OFFICE ON THE DATE THE SURVEY WAS FILED AND THE SURVEY WAS BASED UPON THE DATA THE SURVEYOR HAS BEEN PROVIDED AND THAT THE SURVEYOR HAS BEEN PROVIDED WITH THE NECESSARY INFORMATION AND IS CORRECT TO THE BEST OF MY BELIEF AND ABILITY.
THE FIELD WORK WAS COMPLETED ON APRIL 20, 2010
DATE OF SURVEY: APRIL 20, 2010

Noted - In Trial County, Missouri
RECEIVED BY MAIL

Recording Date/TI are: 04/29/2022 at 11:02:18 AM
Book: 6 Page: 2
Job #: 67000000

Page: 1
Per: CTS by JESSICA W

Seal: [Circular Seal]

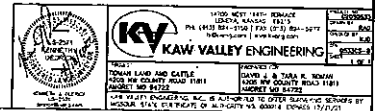

Search Parcel By
Owner Name

Search Parcel By
Address

Search Road By
Name

Search
Subdivision By
Name

Search By
Section

Query

Filter

Find Data

I want to...

BETTEL'S FARMS LLC

101
179.9 Ac

BETTEL'S FARMS LI

Tools

WHITE, SHIRLEY

5.4 Ac

230 (S)

150

4

BETTEL'S FARMS L

WHITE, SHIRLEY & 1 Ac

350

7.01

DUDLEY, WILLIAM A

DUD

301

30.37 Ac

1.02

117 Ac

WISDOMS WILD LIFE LLC

COX FAMILY REVOC TRUST, JAMES A

COUNTY ROAD 12001

COUNTY ROAD 11811

Handwritten mark resembling a stylized 'A' or 'N'.

Invoice

PWSD #4 BATES COUNTY
PO BOX 10
RICH HILL, MO 64779

Bill To: Crown Realty

Date: 4/18/2022

Decription		Amount
Meter deposit		\$100.00
Meter set		\$500.00
Labor & materials	Approx \$300.00 - \$600.00	
If you have questions, please call. Thanks, Steve		
TOTAL DUE		

Clerk Phone/Fax 417-395-4964