

Soils Map

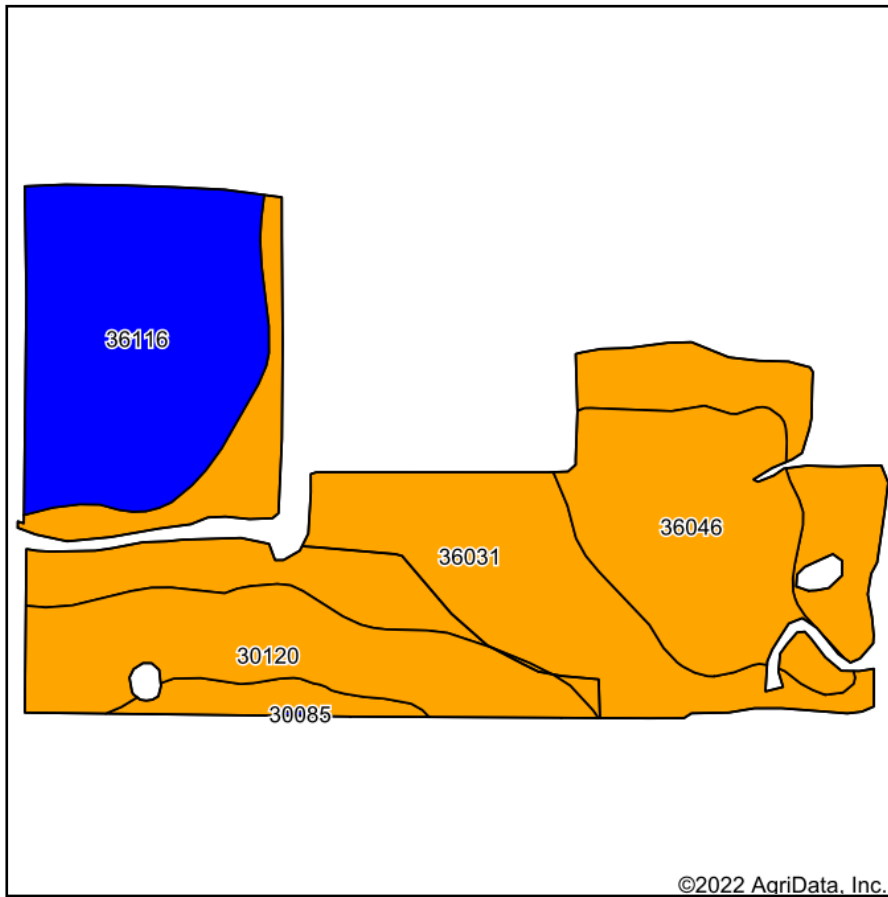

Soils data provided by USDA and NRCS.

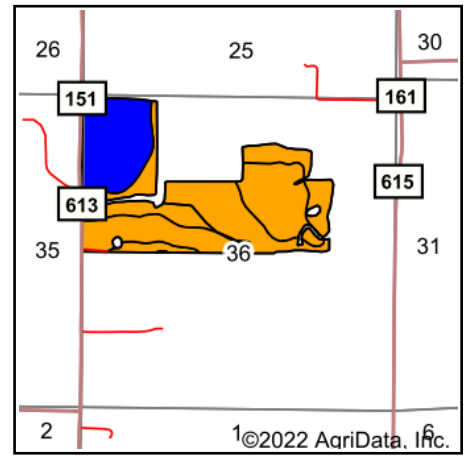

State: **Missouri**
 County: **Carroll**
 Location: **36-53N-25W**
 Township: **Prairie**
 Acres: **163.28**
 Date: **9/22/2022**

United
Country
Property
Solutions, LLC

Maps Provided By:

surety
CUSTOMIZED ONLINE MAPPING
© AgriData, Inc. 2021 www.AgriDataInc.com



Area Symbol: MO033, Soil Area Version: 24

Code	Soil Description	Acres	Percent of field	Non-Irr Class Legend	Non-Irr Class *c	Alfalfa hay Tons	Caucasian bluestem Tons	Common bermudagrass Tons	Orchardgrass red clover Tons	Tall fescue AUM	Tall fescue Tons	Warm season grasses Tons	*n NCCPI Overall	*n NCCPI Corn	*n NCCPI Soybean
36031	Nodaway silt loam, 0 to 2 percent slopes, frequently flooded	65.72	40.2%		IIIw			7	9	8	8	10	62	61	
36116	Zook silty clay loam, heavy till, 0 to 2 percent slopes, occasionally flooded	39.06	23.9%		IIw								74	74	
36046	Wabash silty clay, 0 to 2 percent slopes, occasionally flooded	28.60	17.5%		IIIw								60	60	
30120	Lagonda silty clay loam, 5 to 9 percent slopes, eroded	25.41	15.6%		IIIe	5	8	7	8	7	7	8	70	69	
10120	Sharpsburg silt loam, 2 to 5 percent slopes	4.40	2.7%		IIIIs								72	72	
30085	Grundy silt loam, 2 to 5 percent slopes	0.09	0.1%		IIe								74	74	
Weighted Average					2.76	0.8	1.2	3.9	4.9	4.3	4.3	5.3	*n 66	*n 65.5	*n

*n: The aggregation method is "Weighted Average using all components"

*c: Using Capabilities Class Dominant Condition Aggregation Method

Soils data provided by USDA and NRCS.