

Soils Map

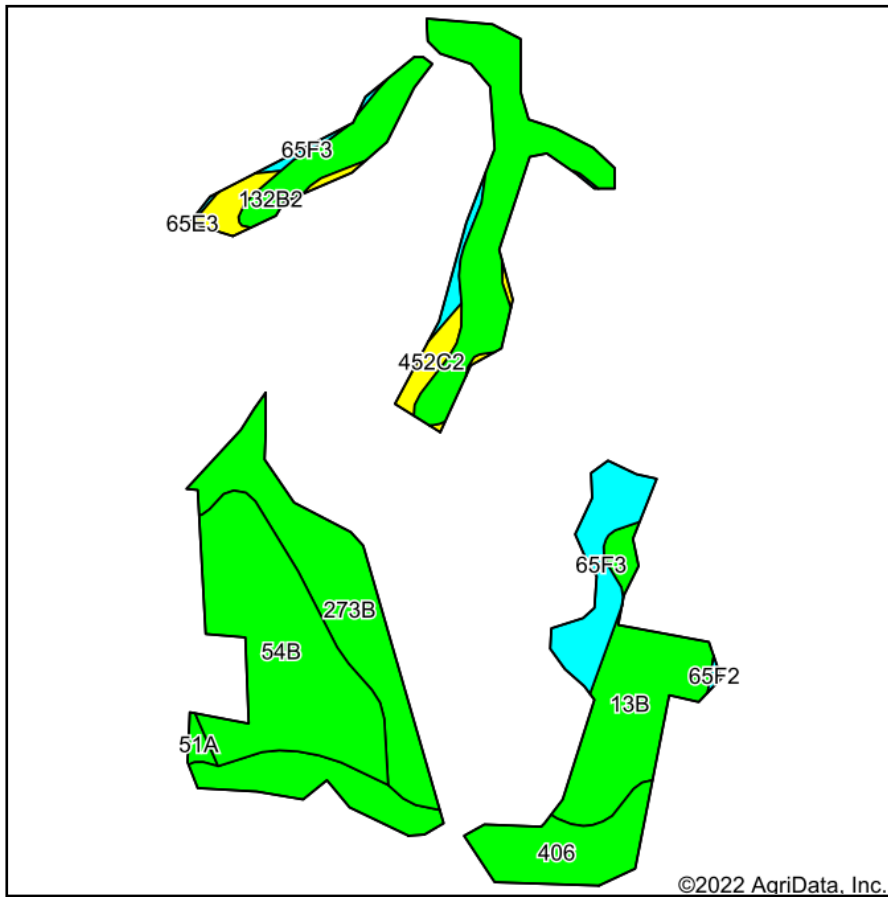

Soils data provided by USDA and NRCS.

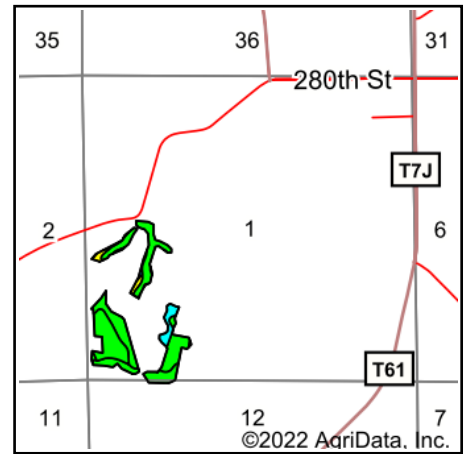

State: **Iowa**
 County: **Appanoose**
 Location: **1-70N-16W**
 Township: **Union**
 Acres: **27.58**
 Date: **9/26/2022**

Hawkeye Farm Mgmt & Real Estate



22 N Main, Albion IA Phone: 641-932-7796
 Email: hawkeye@uciowa.com
 On the web: www.uciowa.com
 www.iowawhitehallfarms.com

Maps Provided By:



© AgriData, Inc. 2021

www.AgriDataInc.com



Area Symbol: IA007, Soil Area Version: 28

Code	Soil Description	Acres	Percent of field	CSR2 Legend	Non-Irr Class *c	CSR2**	CSR	*n NCCPI Soybeans
54B	Zook silty clay loam, heavy till, 2 to 5 percent slopes, rarely flooded	6.26	22.7%		IIw	71	65	69
132B2	Weller silt loam, 2 to 5 percent slopes, moderately eroded	5.71	20.7%		IIIe	67	56	67
273B	Olmitz loam, heavy till, 2 to 5 percent slopes	4.31	15.6%		Ile	81	72	78
406	Kennebec-Amana silt loams complex	4.01	14.5%		Iw	88	90	84
13B	Olmitz-Vesser-Colo complex, 2 to 5 percent slopes	3.78	13.7%		IIw	79	68	81
65F3	Lindley soils, 18 to 24 percent slopes, severely eroded	2.25	8.2%		VIIe	7	10	35
452C2	Lineville silt loam, 5 to 9 percent slopes, moderately eroded	1.08	3.9%		IIIe	46	30	49
51A	Vesser silt loam, 0 to 2 percent slopes, occasionally flooded	0.18	0.7%		Iw	75	70	95
Weighted Average					2.51	69.1	62.5	*n 70.4

**IA has updated the CSR values for each county to CSR2.

*n: The aggregation method is "Weighted Average using all components"

*c: Using Capabilities Class Dominant Condition Aggregation Method

Soils data provided by USDA and NRCS.