

Soils Map

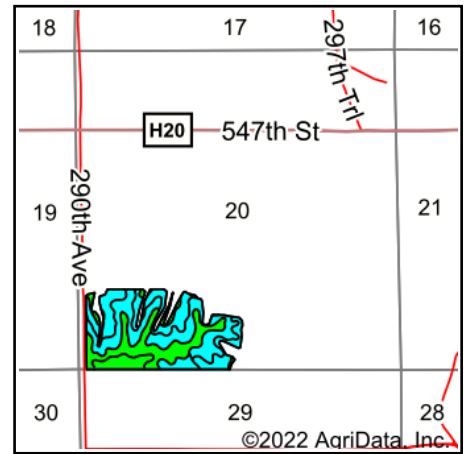

State: **Iowa**
 County: **Lucas**
 Location: **20-73N-20W**
 Township: **Pleasant**
 Acres: **62.55**
 Date: **9/29/2022**

Hawkeye Farm Mgmt & Real Estate

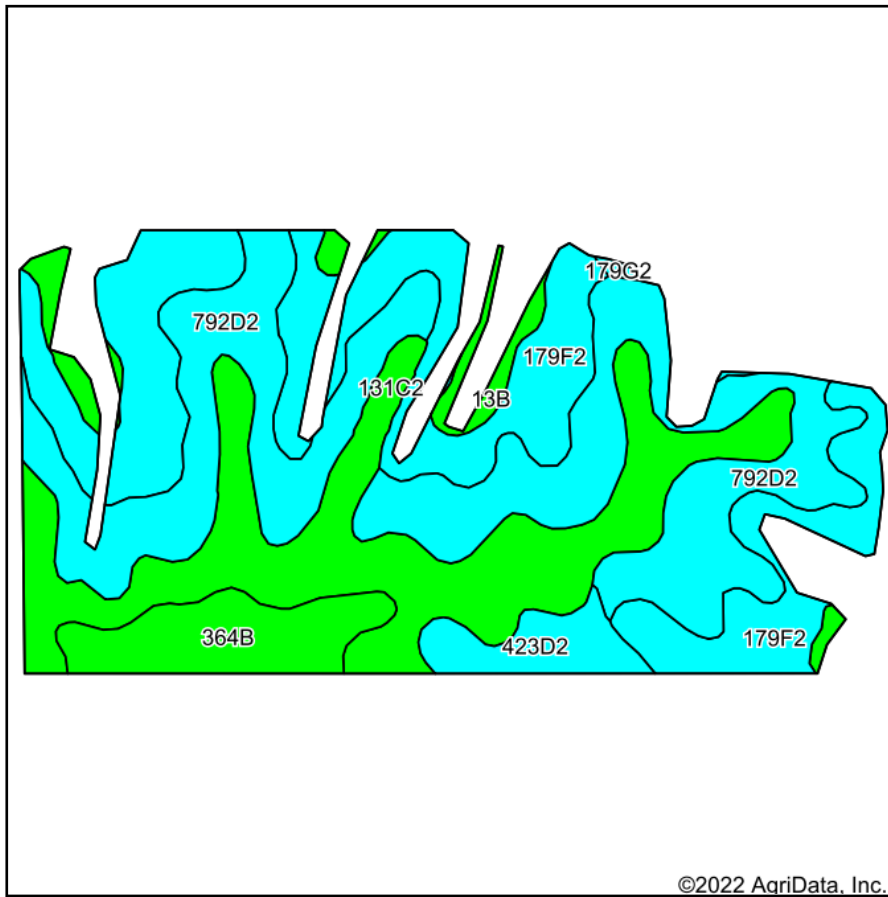

22 N Main, Albion IA Phone: 641-932-7796
 Email: hawkeye@uciowa.com
 On the web: www.uciowa.com
www.iowawhitetailfarms.com

Maps Provided By:



© AgriData, Inc. 2021

www.AgriDataInc.com



Area Symbol: IA117, Soil Area Version: 30

Code	Soil Description	Acres	Percent of field	CSR2 Legend	Non-Irr Class *c	CSR2**	CSR	*n NCCPI Soybeans
792D2	Armstrong clay loam, 9 to 14 percent slopes, moderately eroded	20.94	33.5%		IVe	5	13	40
179F2	Gara clay loam, 18 to 25 percent slopes, moderately eroded	17.58	28.1%		IVe	11	13	35
131C2	Pershing silty clay loam, 5 to 9 percent slopes, moderately eroded	15.23	24.3%		IIIe	62	45	57
364B	Grundy silty clay loam, 2 to 5 percent slopes	4.19	6.7%		Ile	72	75	69
423D2	Bucknell silty clay loam, 9 to 14 percent slopes, moderately eroded	2.27	3.6%		IVe	6	13	44
13B	Zook-Olmits-Vesser complex, 0 to 5 percent slopes	2.21	3.5%		IIw	68	53	74
179G2	Gara clay loam, 25 to 40 percent slopes, moderately eroded	0.13	0.2%		VIIe	5	5	8
Weighted Average					3.56	27.3	26.3	*n 46

**IA has updated the CSR values for each county to CSR2.

*n: The aggregation method is "Weighted Average using all components"

*c: Using Capabilities Class Dominant Condition Aggregation Method

Soils data provided by USDA and NRCS.