

# Soils Map

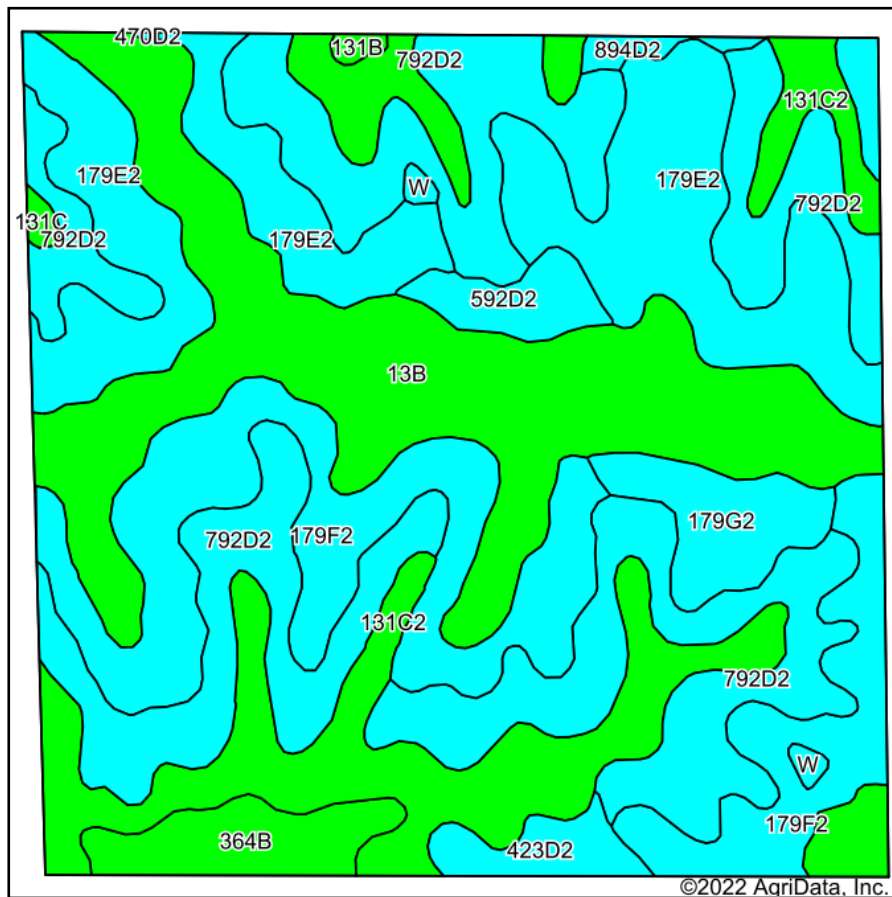

Soils data provided by USDA and NRCS.

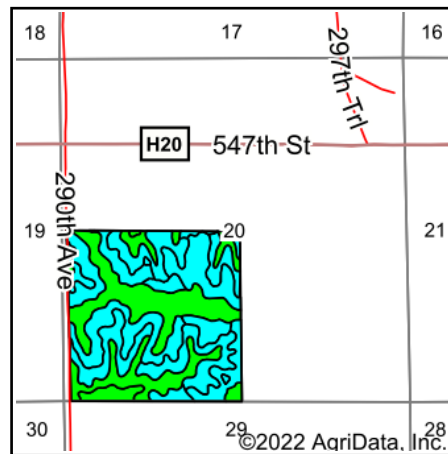

State: **Iowa**  
 County: **Lucas**  
 Location: **20-73N-20W**  
 Township: **Pleasant**  
 Acres: **158.8**  
 Date: **9/29/2022**

**Hawkeye Farm Mgmt & Real Estate**



22 N Main, Albion IA Phone: 641-932-7796  
 Email: [hawkeye@uciowa.com](mailto:hawkeye@uciowa.com)  
 On the web: [www.uciowa.com](http://www.uciowa.com)  
[www.iowawhitetailfarms.com](http://www.iowawhitetailfarms.com)

Maps Provided By:



Area Symbol: IA117, Soil Area Version: 30

Code	Soil Description	Acres	Percent of field	CSR2 Legend	Non-Irr Class *c	CSR2**	CSR	*n NCCPI Soybeans
792D2	Armstrong clay loam, 9 to 14 percent slopes, moderately eroded	40.28	25.4%		IVe	5	13	40
13B	Zook-Olmitz-Vesser complex, 0 to 5 percent slopes	31.31	19.7%		IIw	68	53	74
179E2	Gara clay loam, 14 to 18 percent slopes, moderately eroded	25.44	16.0%		VIe	23	33	43
179F2	Gara clay loam, 18 to 25 percent slopes, moderately eroded	24.54	15.5%		IVe	11	13	35
131C2	Pershing silty clay loam, 5 to 9 percent slopes, moderately eroded	21.39	13.5%		IIIe	62	45	57
179G2	Gara clay loam, 25 to 40 percent slopes, moderately eroded	4.35	2.7%		VIIe	5	5	8
364B	Grundy silty clay loam, 2 to 5 percent slopes	4.13	2.6%		IIe	72	75	69
423D2	Bucknell silty clay loam, 9 to 14 percent slopes, moderately eroded	3.11	2.0%		IVe	6	13	44
592D2	Mystic clay loam, 9 to 14 percent slopes, moderately eroded	2.46	1.5%		IVe	10	5	51
894D2	Bucknell-Gara complex, 9 to 14 percent slopes, moderately eroded	0.71	0.4%		IVe	22	24	46
W	Water	0.47	0.3%			0	0	
131C	Pershing silt loam, 5 to 9 percent slopes	0.31	0.2%		IIIe	65	49	59
131B	Pershing silt loam, 2 to 5 percent slopes	0.30	0.2%		IIIe	70	67	60
Weighted Average					*-	31.1	29.9	*n 48.8

\*\*IA has updated the CSR values for each county to CSR2.

\*n: The aggregation method is "Weighted Average using all components"

\*c: Using Capabilities Class Dominant Condition Aggregation Method

\*- Non Irr Class weighted average cannot be calculated on the current soils data due to missing data.

Soils data provided by USDA and NRCS.