

# Soils Map

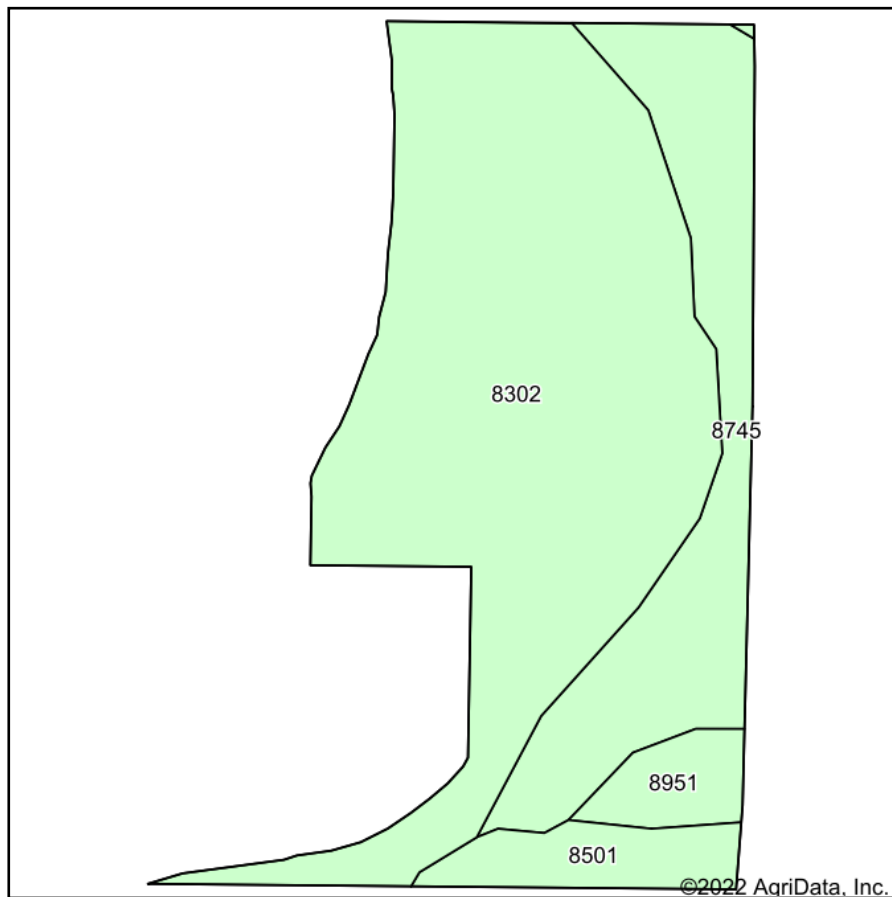

Soils data provided by USDA and NRCS.

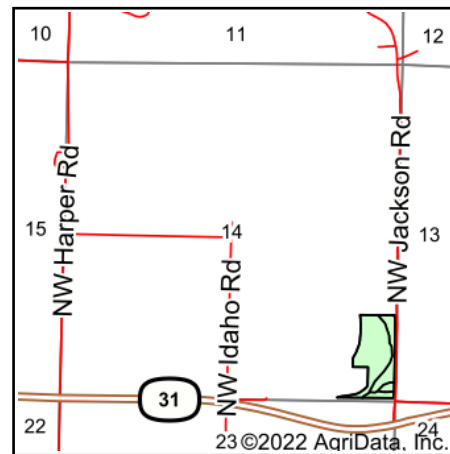

State: **Kansas**  
 County: **Anderson**  
 Location: **14-20S-18E**  
 Township: **Reeder**  
 Acres: **16.37**  
 Date: **10/14/2022**



Maps Provided By:  
  
 © AgriData, Inc. 2021 www.AgriDataInc.com



Area Symbol: KS003, Soil Area Version: 21

Code	Soil Description	Acres	Percent of field	Non-Irr Class *c	Range Production (lbs/acre/yr)	*n NCCPI Soybeans
8302	Verdigris silt loam, 0 to 1 percent slopes, occasionally flooded	10.95	66.9%	IIw	7758	76
8745	Eram-Clareson complex, 1 to 15 percent slopes	3.82	23.3%	IVe	3921	35
8501	Mason silt loam, 0 to 1 percent slopes, rarely flooded	0.94	5.7%	Iw	8250	70
8951	Wagstaff silty clay loam, 1 to 3 percent slopes	0.66	4.0%	IIIe	4968	43
<b>Weighted Average</b>				<b>2.45</b>	<b>6778.4</b>	<b>*n 64.8</b>

\*n: The aggregation method is "Weighted Average using all components"

\*c: Using Capabilities Class Dominant Condition Aggregation Method

Soils data provided by USDA and NRCS.