

Hearings based on NAD BS
and determined by G.P.E.

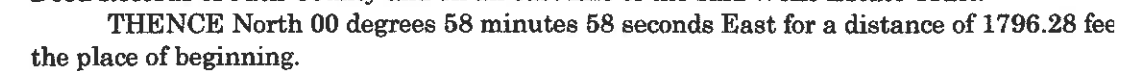

This plat represents a survey conducted on the ground under my supervision on April 28, 2020.

Clinton W. Farris, R.P.L.S.

This plat or description is not intended to express or imply a warranty of ownership or that there are no encumbrances on the described. It is not intended to imply that any adjoining tracts reflected on this document have been actually surveyed on the ground. Any easements, restrictive covenants or encumbrances that may be shown from visible inspection and are not intended to reflect a survey by current title search.