

# 1446 Moncove Lake Access Road, Gap Mills

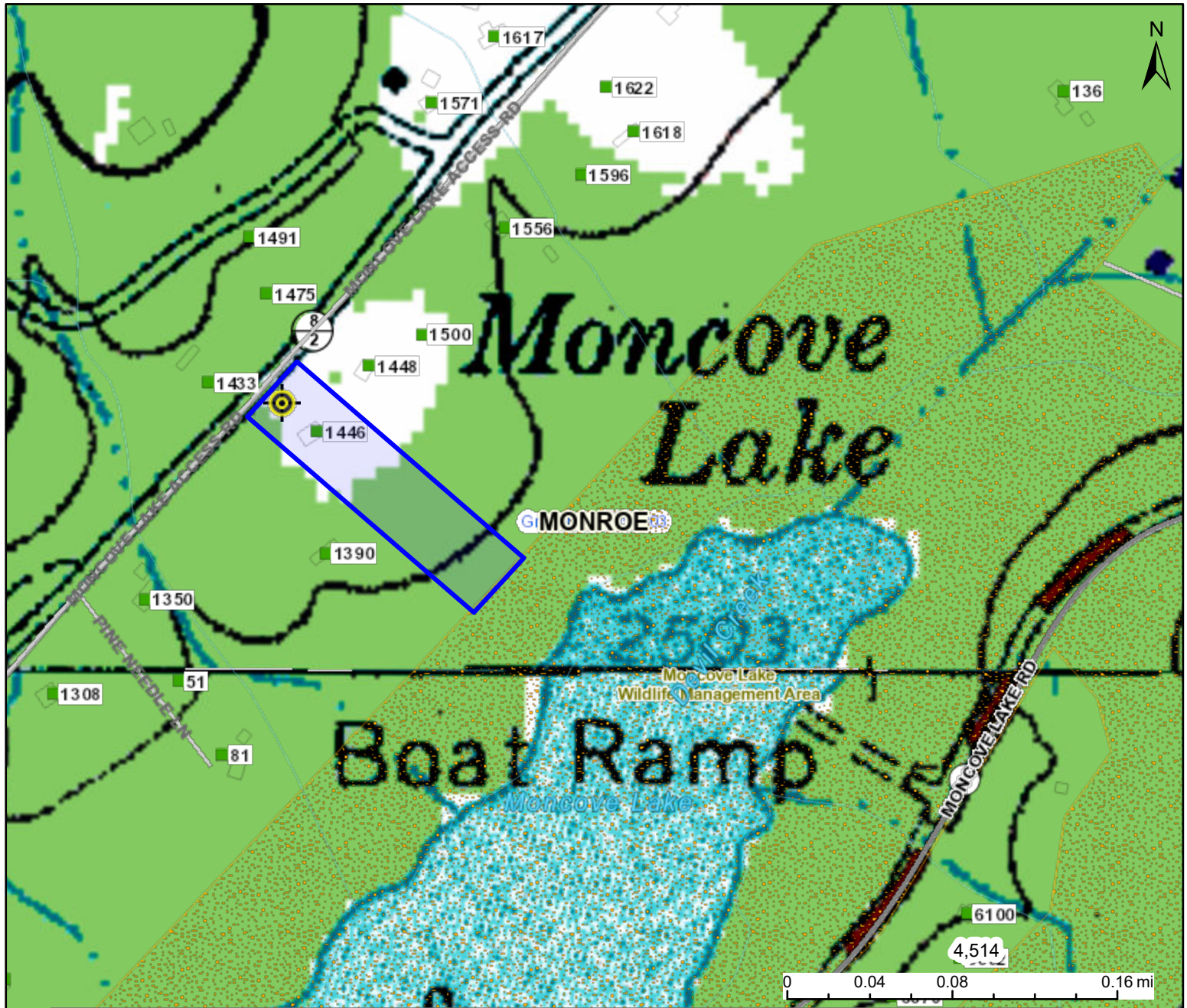

This map is not the official regulatory FIRM or DFIRM. Its purpose is to assist with determining potential flood risk for the selected location.

<div>H I G H  R I S K</div>		Regulatory Floodway
		1-Percent-Annual-Chance Flood Hazard Area <b>With Base Flood Elevation (BFE)</b>
		1-Percent-Annual-Chance Flood Hazard Area <b>Without BFE</b> (may have Advisory Flood Heights)
		1-Percent-Annual-Chance Future Conditions (High Risk Advisory Flood Zones)
Download the Full Legend for all flood tool symbols <a href="https://www.mapwv.gov/flood/map/docs/wv_flood_tool_legend.pdf">https://www.mapwv.gov/flood/map/docs/wv_flood_tool_legend.pdf</a>		
<b>Disclaimer:</b> The online map is for use in administering the National Flood Insurance Program. It does not necessarily identify all areas subject to flooding, particularly from local drainage sources of small size. Refer to the official Flood Insurance Study (FIS) for detailed flood elevation data in flood profiles and data tables. WV Flood Tool ( <a href="https://www.MapWV.gov/flood">https://www.MapWV.gov/flood</a> ) is supported by FEMA, WV NFIP Office, and WV GIS Technical Center.		
Flood Info Location Map created on 1/8/2023		
<b>User Notes</b>		
<b>Flood Hazard Area</b>	Location is <b>NOT WITHIN</b> any identified flood hazard area. Unmapped flood hazard areas may be present.	
<b>Flood Zone</b>	Out of Flood Zone	
<b>Stream</b>		
<b>Watershed (HUC8)</b>	Greenbrier (5050003)	
<b>Flood Height</b>	Flood Height 6a N/A	
<b>Water Depth</b>		
<b>Elevation</b>	2539.1 ft (Source: FEMA 2016) (NAVD88)	
<b>Community &amp; ID</b>	Monroe County (ID: 540278)	
<b>FEMA Map &amp; Date</b>	54063C0090C; Effective Date: 6/17/2002	
<b>Location (lat, long)</b>	(37.626612, -80.347894) (WGS84)	
<b>Parcel ID</b>	32-06-0012-0002-0008	
<b>E-911 Address</b>	1446 MONCOVE LAKE ACCESS RD, Gap Mills, WV, 24941	