

# Soils Map

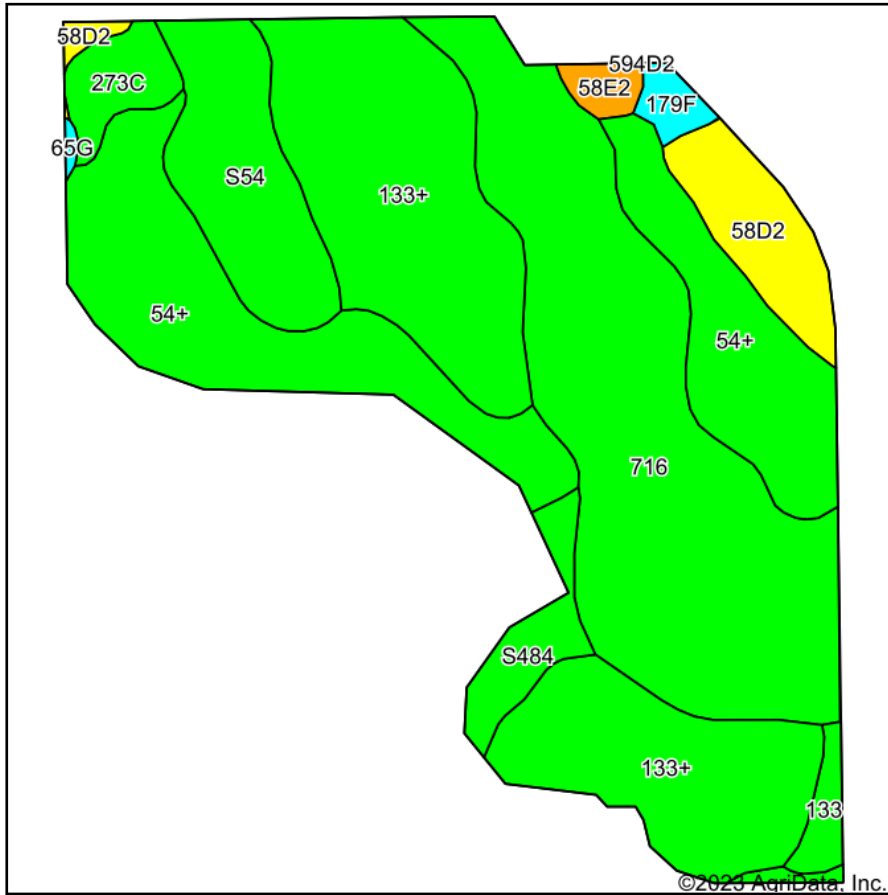

Soils data provided by USDA and NRCS.

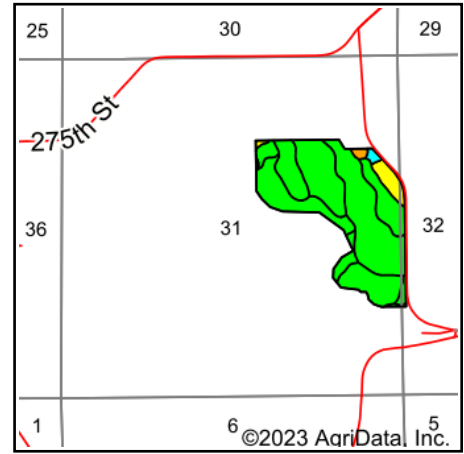

State: **Iowa**  
 County: **Monroe**  
 Location: **31-71N-16W**  
 Township: **Urbana**  
 Acres: **84**  
 Date: **1/27/2023**

**Hawkeye Farm Mgmt & Real Estate**

**United Country Real Estate**  
 22 N Main, Albion IA Phone: 641-932-7796  
 Email: hawkeye@uciowa.com  
 On the web: www.uciowa.com  
 www.iowawhitehallfarms.com

Maps Provided By:  
**surety**  
 CUSTOMIZED ONLINE MAPPING  
 © AgriData, Inc. 2021 www.AgriDataInc.com



Area Symbol: IA135, Soil Area Version: 30

| Code                    | Soil Description  | Acres | Percent of field | CSR2 Legend | Non-Irr Class<br>*c | CSR2**      | CSR       | *n NCCPI Soybeans |
|-------------------------|---|-------|------------------|-------------|---------------------|-------------|-----------|-------------------|
| 716                     | Lawson-Quiver-Nodaway complex, 0 to 2 percent slopes, occasionally flooded        | 24.78 | 29.5%            |             | Ilw                 | 78          |           | 86                |
| 133+                    | Colo silt loam, overwash, 0 to 2 percent slopes                                   | 22.43 | 26.7%            |             | Ilw                 | 78          | 80        | 87                |
| 54+                     | Zook silt loam, heavy till, 0 to 2 percent slopes, occasionally flooded, overwash | 18.73 | 22.3%            |             | Ilw                 | 68          | 70        | 73                |
| S54                     | Zook silty clay loam, heavy till, 0 to 2 percent slopes, occasionally flooded     | 6.98  | 8.3%             |             | Ilw                 | 68          |           | 68                |
| 58D2                    | Douds loam, heavy loess, 9 to 14 percent slopes, moderately eroded                | 4.12  | 4.9%             |             | Ive                 | 44          | 28        | 63                |
| S484                    | Lawson silt loam, heavy till, 0 to 2 percent slopes, occasionally flooded         | 2.32  | 2.8%             |             | Ilw                 | 86          |           | 93                |
| 273C                    | Olmitz loam, heavy till, 5 to 9 percent slopes                                    | 1.97  | 2.3%             |             | Ille                | 77          | 57        | 71                |
| 133                     | Colo silty clay loam, heavy till, 0 to 2 percent slopes, occasionally flooded     | 0.96  | 1.1%             |             | Ilw                 | 78          | 85        | 86                |
| 179F                    | Gara loam, 18 to 25 percent slopes  | 0.82  | 1.0%             |             | Vle                 | 19          | 15        | 42                |
| 58E2                    | Douds loam, heavy loess, 14 to 18 percent slopes, moderately eroded               | 0.77  | 0.9%             |             | Vle                 | 34          | 18        | 57                |
| 65G                     | Lindley loam, 18 to 40 percent slopes   | 0.12  | 0.1%             |             | Vlle                | 6           | 5         | 12                |
| <b>Weighted Average</b> |   |       |                  |             | <b>2.20</b>         | <b>72.4</b> | <b>*-</b> | <b>*n 79.8</b>    |

\*\*IA has updated the CSR values for each county to CSR2.

\*- CSR weighted average cannot be calculated on the current soils data, use prior data version for csr values.

\*n: The aggregation method is "Weighted Average using all components"

\*c: Using Capabilities Class Dominant Condition Aggregation Method

Soils data provided by USDA and NRCS.