

Soils Map

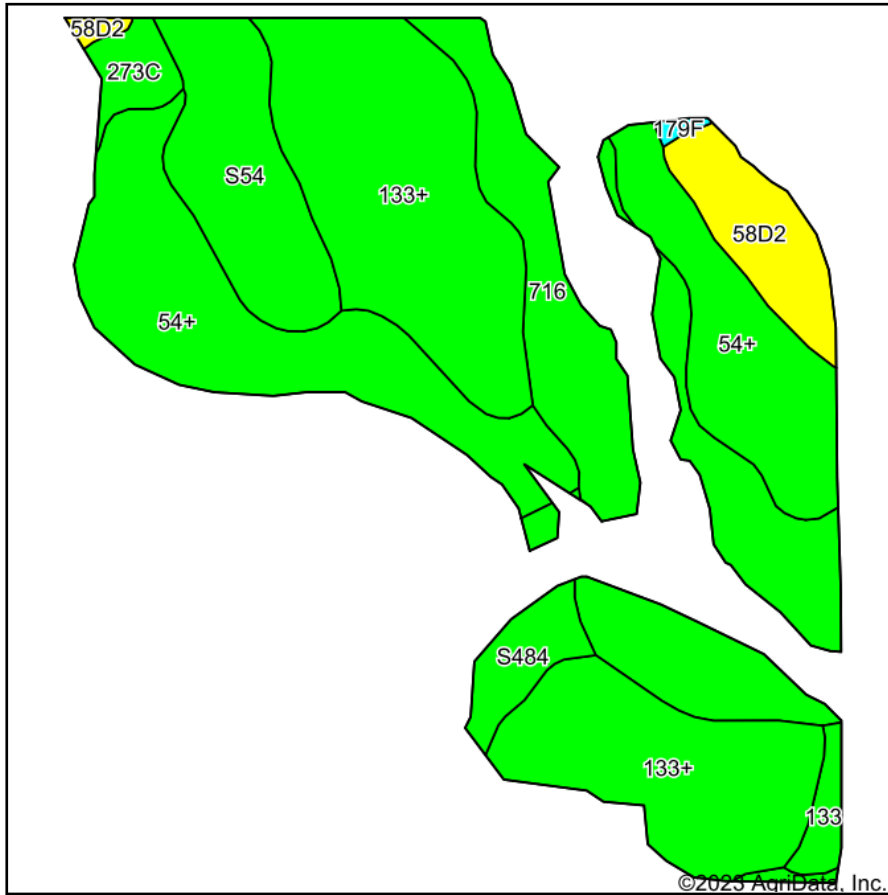

Soils data provided by USDA and NRCS.

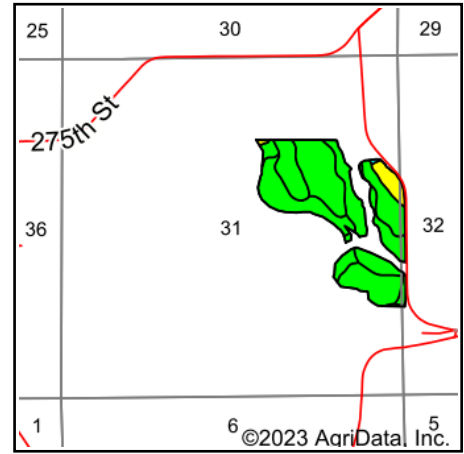

State: **Iowa**
 County: **Monroe**
 Location: **31-71N-16W**
 Township: **Urbana**
 Acres: **71.13**
 Date: **1/27/2023**

Hawkeye Farm Mgmt & Real Estate



22 N Main, Albion IA Phone: 641-932-7796
 Email: hawkeye@uciowa.com
 On the web: www.uciowa.com
 www.iowawhiteoakfarms.com

Maps Provided By:



Area Symbol: IA135, Soil Area Version: 30

Code	Soil Description	Acres	Percent of field	CSR2 Legend	Non-Irr Class *c	CSR2**	CSR	*n NCCPI Soybeans
133+	Colo silt loam, overwash, 0 to 2 percent slopes	22.26	31.3%		Ilw	78	80	87
54+	Zook silt loam, heavy till, 0 to 2 percent slopes, occasionally flooded, overwash	18.52	26.0%		Ilw	68	70	73
716	Lawson-Quiver-Nodaway complex, 0 to 2 percent slopes, occasionally flooded	14.85	20.9%		Ilw	78		86
S54	Zook silty clay loam, heavy till, 0 to 2 percent slopes, occasionally flooded	6.95	9.8%		Ilw	68		68
58D2	Douds loam, heavy loess, 9 to 14 percent slopes, moderately eroded	3.90	5.5%		Ive	44	28	63
S484	Lawson silt loam, heavy till, 0 to 2 percent slopes, occasionally flooded	2.21	3.1%		Ilw	86		93
273C	Olmitz loam, heavy till, 5 to 9 percent slopes	1.36	1.9%		Ille	77	57	71
133	Colo silty clay loam, heavy till, 0 to 2 percent slopes, occasionally flooded	0.91	1.3%		Ilw	78	85	86
179F	Gara loam, 18 to 25 percent slopes	0.17	0.2%		Vle	19	15	42
Weighted Average					2.14	72.6	*-	*n 79.7

**IA has updated the CSR values for each county to CSR2.

*- CSR weighted average cannot be calculated on the current soils data, use prior data version for csr values.

*n: The aggregation method is "Weighted Average using all components"

*c: Using Capabilities Class Dominant Condition Aggregation Method

Soils data provided by USDA and NRCS.