

Soils Map

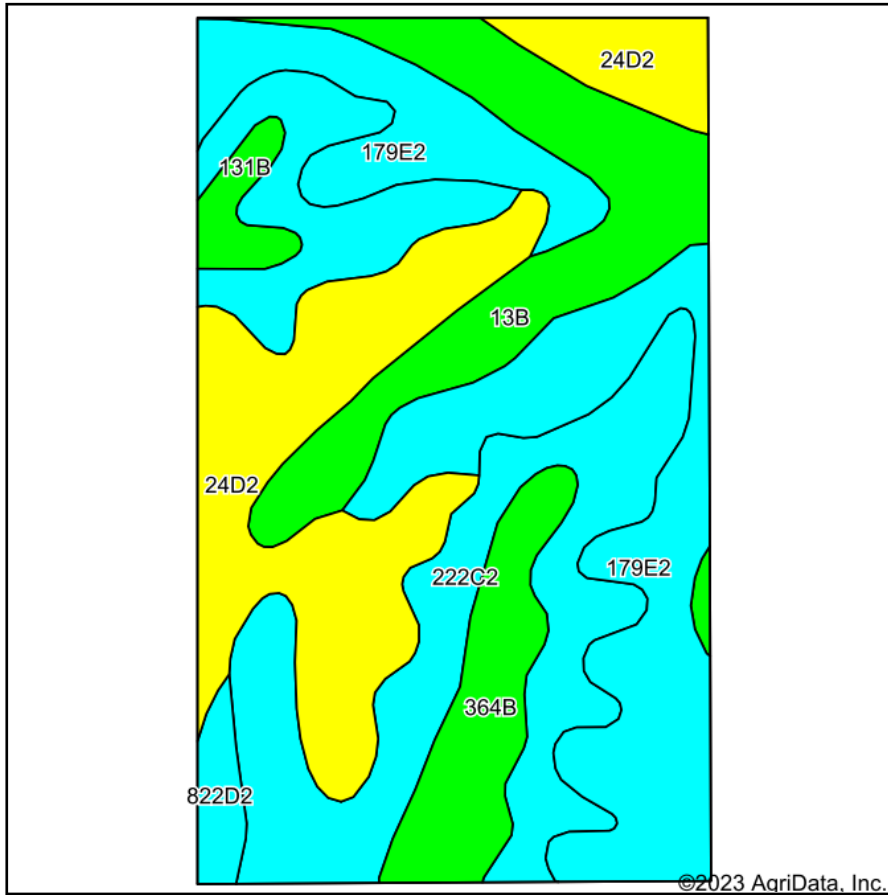

Soils data provided by USDA and NRCS.

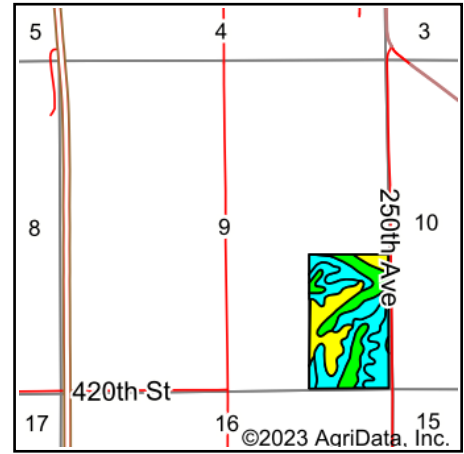

State: **Iowa**
 County: **Appanoose**
 Location: **9-70N-17W**
 Township: **Taylor**
 Acres: **63**
 Date: **1/27/2023**

Hawkeye Farm Mgmt & Real Estate



22 N Main, Albion IA Phone: 641-932-7796
 Email: hawkeye@uciowa.com
 On the web: www.uciowa.com
 www.iowawhitetailfarms.com

Maps Provided By:



Area Symbol: IA007, Soil Area Version: 29

Code	Soil Description	Acres	Percent of field	CSR2 Legend	Non-Irr Class *c	CSR2**	CSR	*n NCCPI Soybeans
222C2	Clarinda silty clay loam, 5 to 9 percent slopes, moderately eroded	17.29	27.4%		IVw	28	25	42
179E2	Gara loam, 14 to 18 percent slopes, moderately eroded	15.97	25.3%		VIe	24	33	44
24D2	Shelby loam, 9 to 14 percent slopes, moderately eroded	13.89	22.0%		IIIe	45	48	52
13B	Olmitz-Vesser-Colo complex, 2 to 5 percent slopes	8.98	14.3%		IIw	79	68	80
364B	Grundy silty clay loam, 2 to 5 percent slopes	4.56	7.2%		Ile	72	75	68
131B	Pershing silt loam, 2 to 5 percent slopes	1.21	1.9%		IIIe	70	67	59
822D2	Lamoni silty clay loam, 9 to 14 percent slopes, moderately eroded	1.10	1.7%		IVe	10	15	49
Weighted Average					3.84	41.7	42.5	*n 52.5

**IA has updated the CSR values for each county to CSR2.

*n: The aggregation method is "Weighted Average using all components"

*c: Using Capabilities Class Dominant Condition Aggregation Method

Soils data provided by USDA and NRCS.