

# Soils Map

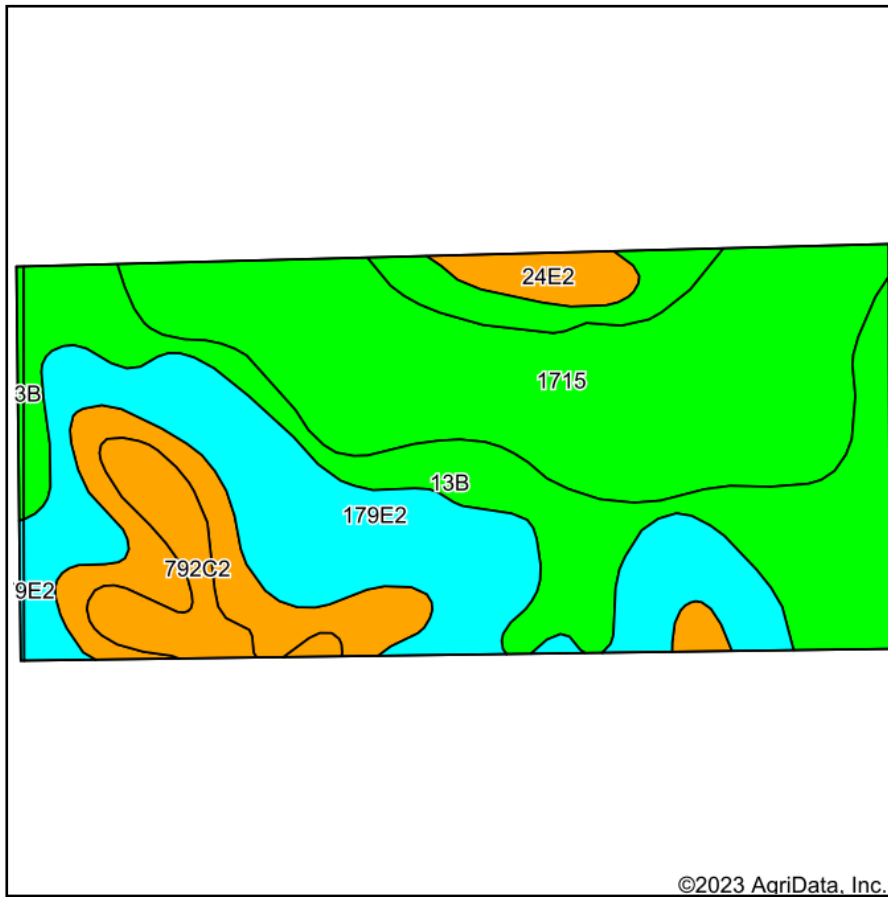

Soils data provided by USDA and NRCS.

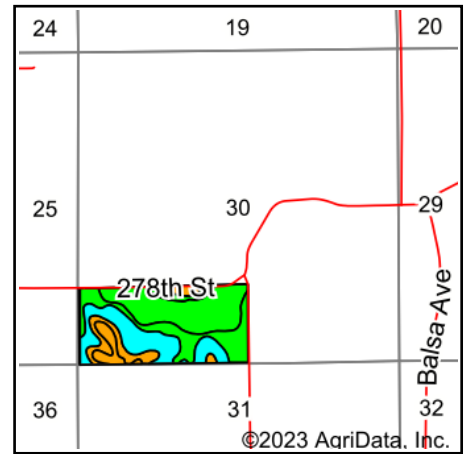

State: **Iowa**  
 County: **Davis**  
 Location: **30-68N-15W**  
 Township: **Fabius**  
 Acres: **86**  
 Date: **2/22/2023**

**Hawkeye Farm Mgmt & Real Estate**



22 N Main, Albion IA Phone: 641-932-7796  
 Email: hawkeye@uciowa.com  
 On the web: www.uciowa.com  
 www.iowawhitetailfarms.com

Maps Provided By:



Area Symbol: IA007, Soil Area Version: 29  
 Area Symbol: IA051, Soil Area Version: 29

Code	Soil Description	Acres	Percent of field	CSR2 Legend	Non-Irr Class *c	CSR2**	CSR	*n NCCPI Soybeans
1715	Nodaway-Lawson-Ackmore silt loams, 0 to 2 percent slopes	29.22	34.0%		IIIw	78	80	83
13B	Olmitz-Vesser-Zook complex, 0 to 5 percent slopes	21.58	25.1%		IIw	74	60	74
179E2	Gara loam, 14 to 18 percent slopes, moderately eroded	20.75	24.1%		VIe	24	33	44
993D2	Gara-Armstrong loams, 9 to 14 percent slopes, moderately eroded	7.60	8.8%		IVe	35	20	48
792C2	Armstrong loam, 5 to 9 percent slopes, moderately eroded	4.26	5.0%		IIIe	31	27	47
24E2	Shelby loam, 14 to 18 percent slopes, moderately eroded	2.07	2.4%		IVe	33	38	50
13B	Olmitz-Vesser-Colo complex, 2 to 5 percent slopes	0.38	0.4%		IIw	79	68	80
179E2	Gara loam, 14 to 18 percent slopes, moderately eroded	0.14	0.2%		VIe	24	33	44
Weighted Average					3.59	56.7	54.6	*n 65.6

\*\*IA has updated the CSR values for each county to CSR2.

\*n: The aggregation method is "Weighted Average using all components"

\*c: Using Capabilities Class Dominant Condition Aggregation Method

Soils data provided by USDA and NRCS.