

Tillable Soils Map

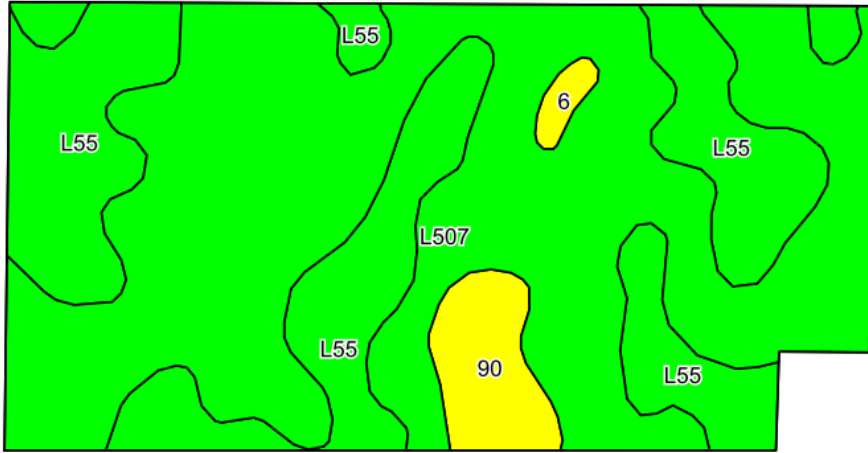

©2022 AgriData, Inc.

Soils data provided by USDA and NRCS.

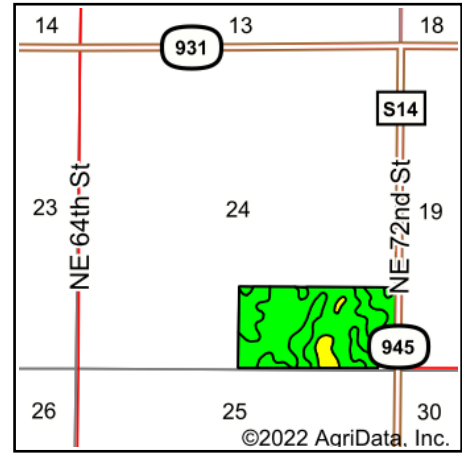

©2022 AgriData, Inc.

State: **Iowa**
 County: **Polk**
 Location: **24-80N-23W**
 Township: **Douglas**
 Acres: **76.76**
 Date: **11/30/2022**



Maps Provided By:



© AgriData, Inc. 2021

www.AgriDataInc.com



Area Symbol: IA153, Soil Area Version: 25

Code	Soil Description	Acres	Percent of field	CSR2 Legend	Non-Irr Class *c	*j Corn Bu	*i Soybeans Bu	CSR2**	CSR	*n NCCPI Overall	
L507	Canisteo clay loam, Bemis moraine, 0 to 2 percent slopes	48.10	62.7%		llw	0.0	0.0	87		81	
L55	Nicollet loam, 1 to 3 percent slopes	24.55	32.0%		le	0.0	0.0	91		84	
90	Okoboji mucky silty clay loam, depressional, 0 to 1 percent slopes	3.50	4.6%		llw	185.6	53.8	55	62	74	
6	Okoboji silty clay loam, 0 to 1 percent slopes	0.61	0.8%		llw	177.6	51.5	59	59	76	
Weighted Average						1.73	9.9	2.9	86.6	*-	*n 81.6

**IA has updated the CSR values for each county to CSR2.

*- CSR weighted average cannot be calculated on the current soils data, use prior data version for csr values.

*i Yield data provided by the ISPAID Database version 8.1.1 developed by IA State University.

*n: The aggregation method is "Weighted Average using all components"

*c: Using Capabilities Class Dominant Condition Aggregation Method

Soils data provided by USDA and NRCS.