

Soils Map

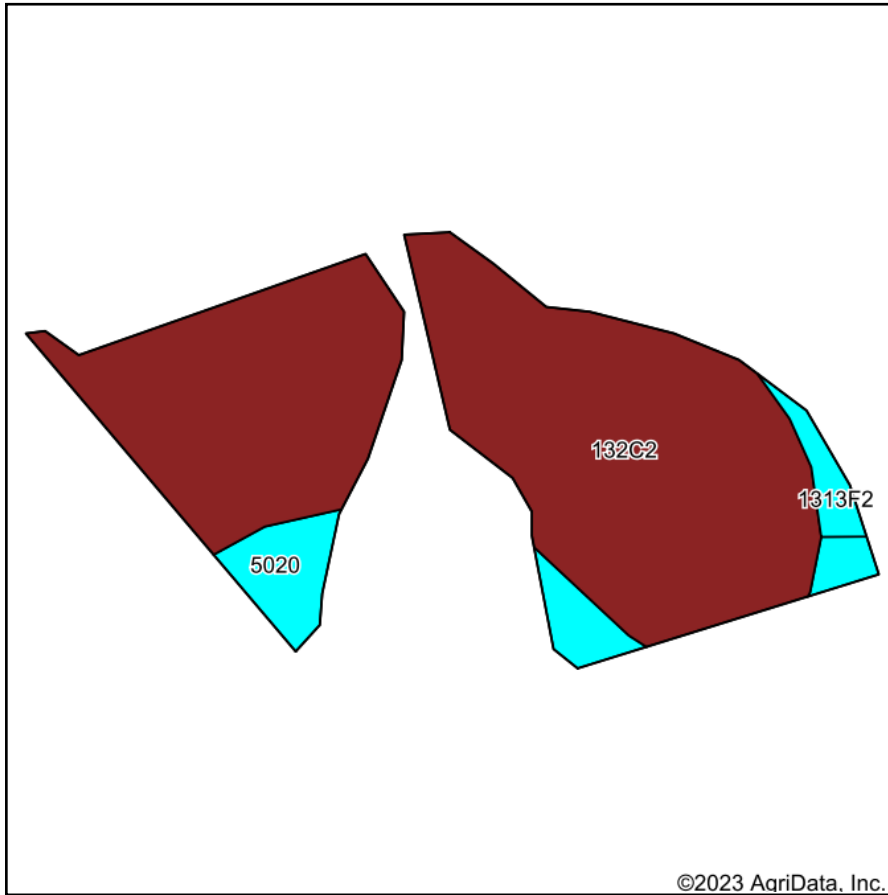

Soils data provided by USDA and NRCS.

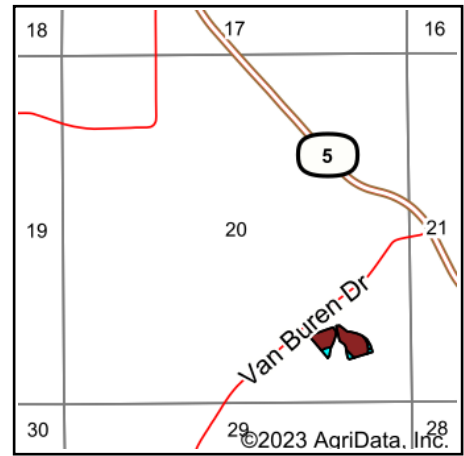

State: **Iowa**
 County: **Marion**
 Location: **20-74N-18W**
 Township: **Liberty**
 Acres: **5.66**
 Date: **2/27/2023**

Hawkeye Farm Mgmt & Real Estate



22 N Main, Albia IA Phone: 641-932-7796
 Email: hawkeye@uciowa.com
 On the web: www.uciowa.com
 www.iowawhitetailfarms.com

Maps Provided By:



© AgriData, Inc. 2021

www.AgriDataInc.com



Area Symbol: IA125, Soil Area Version: 32

Code	Soil Description	Acres	Percent of field	CSR2 Legend	Non-Irr Class *c	CSR2**	CSR	*n NCCPI Soybeans
132C2	Weller silt loam, 5 to 9 percent slopes, moderately eroded	4.96	87.6%		IIIe	59	45	68
5020	Dumps, strip mines	0.56	9.9%			0		59
1313F2	Munterville silt loam, 18 to 25 percent slopes, moderately eroded	0.14	2.5%		VIIe	5	5	27
Weighted Average					*-	51.8	*-	*n 66.1

**IA has updated the CSR values for each county to CSR2.

*- CSR weighted average cannot be calculated on the current soils data, use prior data version for csr values.

*n: The aggregation method is "Weighted Average using all components"

*c: Using Capabilities Class Dominant Condition Aggregation Method

*- Non Irr Class weighted average cannot be calculated on the current soils data due to missing data.

Soils data provided by USDA and NRCS.