

Soils Map

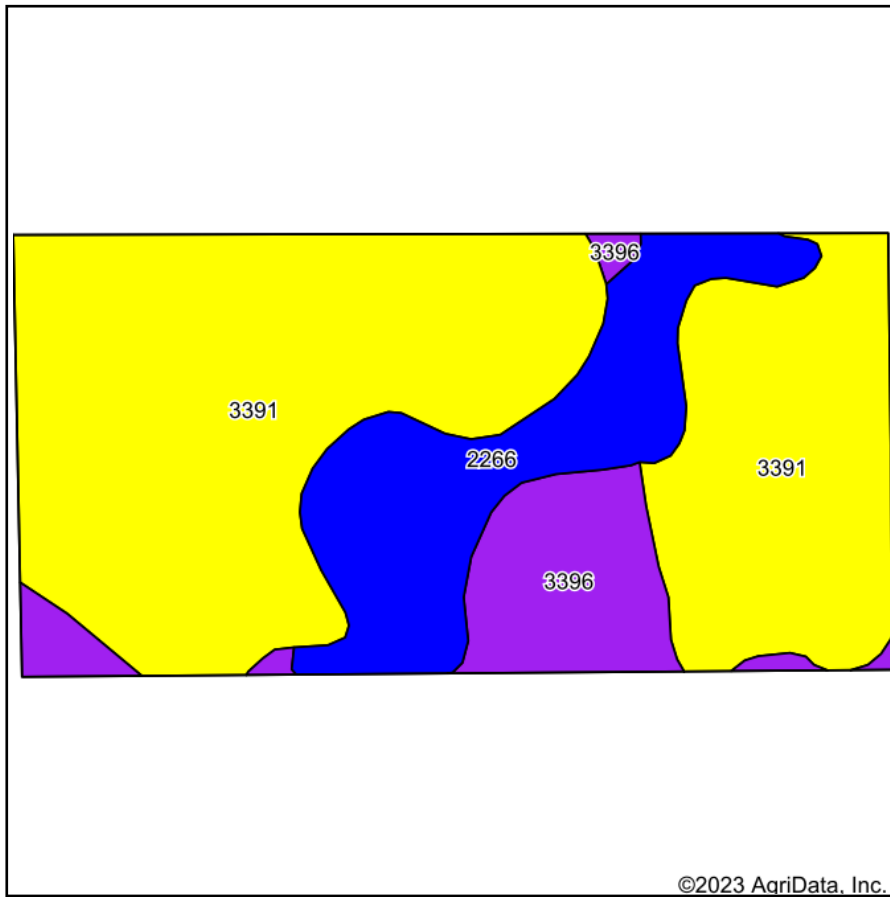

Soils data provided by USDA and NRCS.

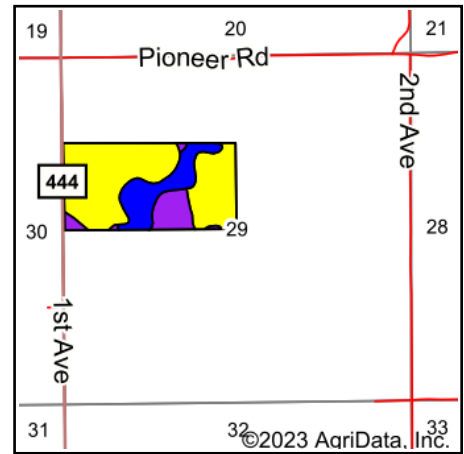

State: **Kansas**
 County: **McPherson**
 Location: **29-18S-5W**
 Township: **South Sharps Creek**
 Acres: **79.77**
 Date: **2/19/2023**



Maps Provided By:



Area Symbol: KS113, Soil Area Version: 20								
Code	Soil Description	Acres	Percent of field	Non-Irr Class Legend	Non-Irr Class *c	Irr Class *c	Range Production (lbs/acre/yr)	*n NCCPI Soybeans
3391	Lancaster loam, 3 to 7 percent slopes	55.20	69.2%		IVe	IVe	3850	48
2266	Tobin silt loam, occasionally flooded	14.87	18.6%		IIw	IIw	5875	83
3396	Lancaster-Hedville complex, 3 to 20 percent slopes	9.70	12.2%		Vle		3375	39
Weighted Average					3.87	*-	4169.7	*n 53.4

*n: The aggregation method is "Weighted Average using all components"

*c: Using Capabilities Class Dominant Condition Aggregation Method

*- Irr Class weighted average cannot be calculated on the current soils data due to missing data.

Soils data provided by USDA and NRCS.