

# Soils Map

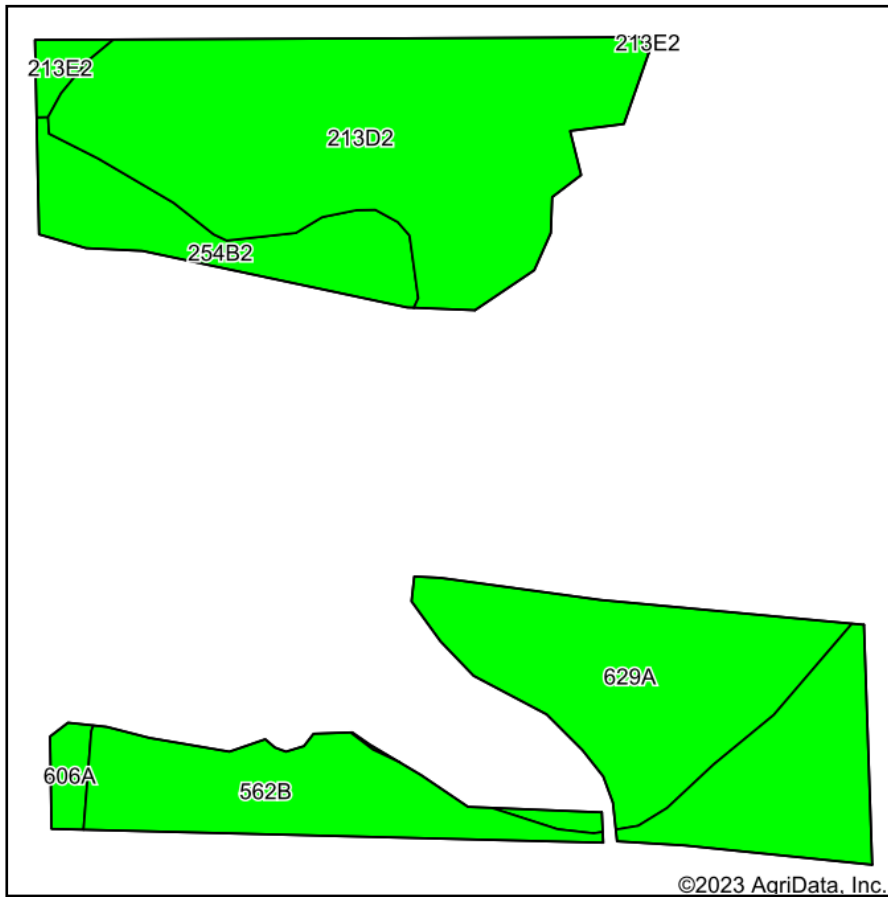

Soils data provided by USDA and NRCS.

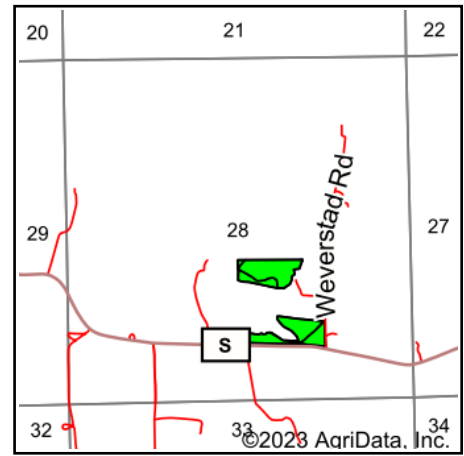

State: **Wisconsin**  
 County: **Trempealeau**  
 Location: **28-22N-7W**  
 Township: **Pigeon**  
 Acres: **15.05**  
 Date: **3/20/2023**



Maps Provided By:



© AgriData, Inc. 2023

www.AgriDataInc.com



Area Symbol: WI121, Soil Area Version: 15

Code	Soil Description	Acres	Percent of field	Non-Irr Class Legend	Non-Irr Class *c	Corn Bu	Soybeans Bu	*n NCCPI Overall	*n NCCPI Corn	*n NCCPI Small Grains	*n NCCPI Soybeans
213D2	Hixton silt loam, 12 to 20 percent slopes, moderately eroded	6.08	40.4%		IVe			58	58	49	47
562B	Gosil loamy sand, 1 to 6 percent slopes	3.80	25.2%		IVs	60	18	32	32	30	31
629A	Ettrick silt loam, 0 to 2 percent slopes, frequently flooded	3.25	21.6%		VIw			52	40	18	52
254B2	Norden silt loam, 2 to 6 percent slopes, moderately eroded	1.51	10.0%		Ile			64	64	56	55
606A	Huntsville silt loam, 0 to 3 percent slopes, occasionally flooded	0.22	1.5%		Iw	145	52	90	88	72	90
213E2	Hixton silt loam, 20 to 30 percent slopes, moderately eroded	0.19	1.3%		VIe			17	17	14	9
<b>Weighted Average</b>					<b>4.21</b>	<b>17.3</b>	<b>5.3</b>	<b>*n 50.7</b>	<b>*n 48.1</b>	<b>*n 38.1</b>	<b>*n 45</b>

\*n: The aggregation method is "Weighted Average using all components"

\*c: Using Capabilities Class Dominant Condition Aggregation Method

Soils data provided by USDA and NRCS.