

# Soils Map

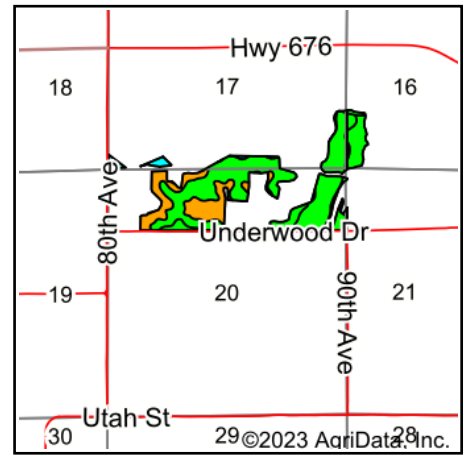

State: **Iowa**  
 County: **Marion**  
 Location: **20-74N-20W**  
 Township: **Washington**  
 Acres: **113.07**  
 Date: **3/16/2023**

**Hawkeye Farm Mgmt & Real Estate**

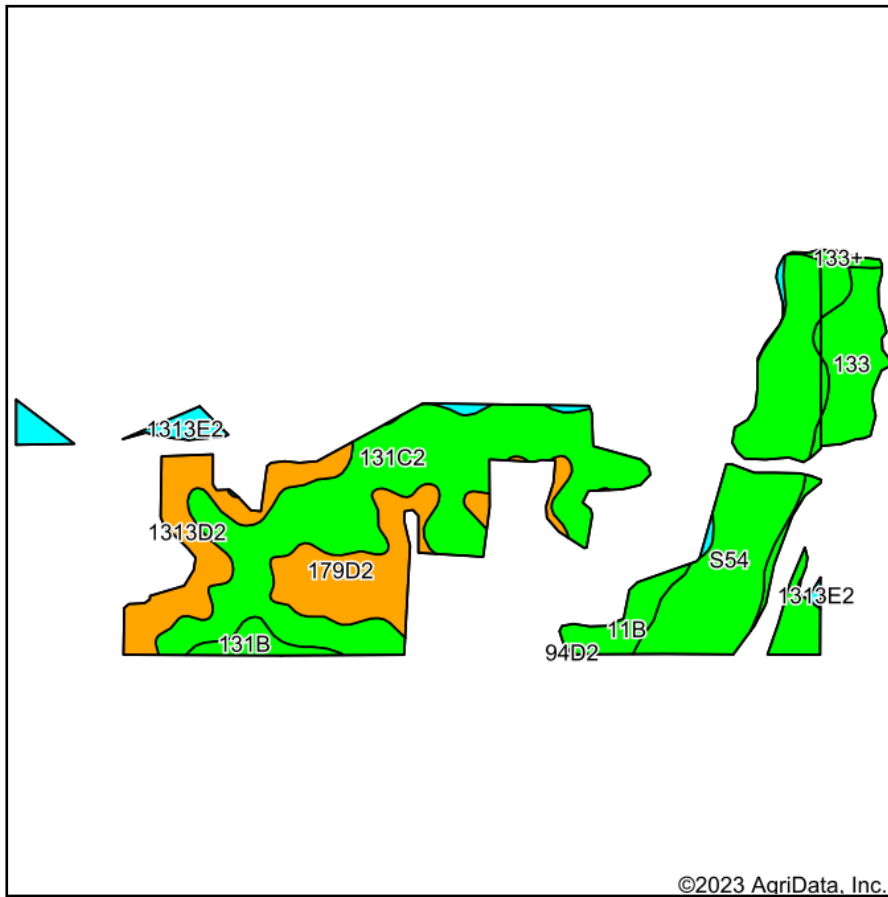

22 N Main, Albion IA Phone: 641-932-7796  
 Email: [hawkeye@uciowa.com](mailto:hawkeye@uciowa.com)  
 On the web: [www.uciowa.com](http://www.uciowa.com)  
[www.iowawhitetailfarms.com](http://www.iowawhitetailfarms.com)

Maps Provided By:



Area Symbol: IA125, Soil Area Version: 32

Code	Soil Description	Acres	Percent of field	CSR2 Legend	Non-Irr Class *c	CSR2**	CSR	*n NCCPI Soybeans
131C2	Pershing silt loam, 5 to 9 percent slopes, moderately eroded	40.14	35.5%		IIIe	62	49	51
S54	Zook silty clay loam, heavy till, 0 to 2 percent slopes, occasionally flooded	26.59	23.5%		IIw	68		68
179D2	Gara loam, 9 to 14 percent slopes, moderately eroded	12.31	10.9%		IVe	38	43	48
133	Colo silty clay loam, deep loess, 0 to 2 percent slopes, occasionally flooded	11.96	10.6%		IIw	78	80	80
1313D2	Munterville silt loam, 9 to 14 percent slopes, moderately eroded	11.17	9.9%		VIe	34	10	42
1313E2	Munterville silt loam, 14 to 18 percent slopes, moderately eroded	4.06	3.6%		VIe	22	5	39
11B	Colo-Ely silty clay loams, 2 to 5 percent slopes	3.83	3.4%		Ile	81	65	79
131B	Pershing silt loam, 2 to 5 percent slopes	2.29	2.0%		IIIe	70	72	59
133+	Colo silt loam, deep loess, 0 to 2 percent slopes, overwash, occasionally flooded	0.72	0.6%		IIw	78	80	85
Weighted Average					3.13	59.2	*-	*n 57.7

\*\*IA has updated the CSR values for each county to CSR2.

\*- CSR weighted average cannot be calculated on the current soils data, use prior data version for csr values.

\*n: The aggregation method is "Weighted Average using all components"

\*c: Using Capabilities Class Dominant Condition Aggregation Method

Soils data provided by USDA and NRCS.