

UNION PACIFIC RAILROAD
PROPERTY EXHIBIT
LOCATED WITHIN THE SOUTHEAST QUARTER OF SECTION
32, TOWNSHIP 50 NORTH, RANGE 9 EAST OF THE NEW
MEXICO PRINCIPAL MERIDIAN,
CITY OF SALIDA,
CHAFFEE COUNTY, COLORADO

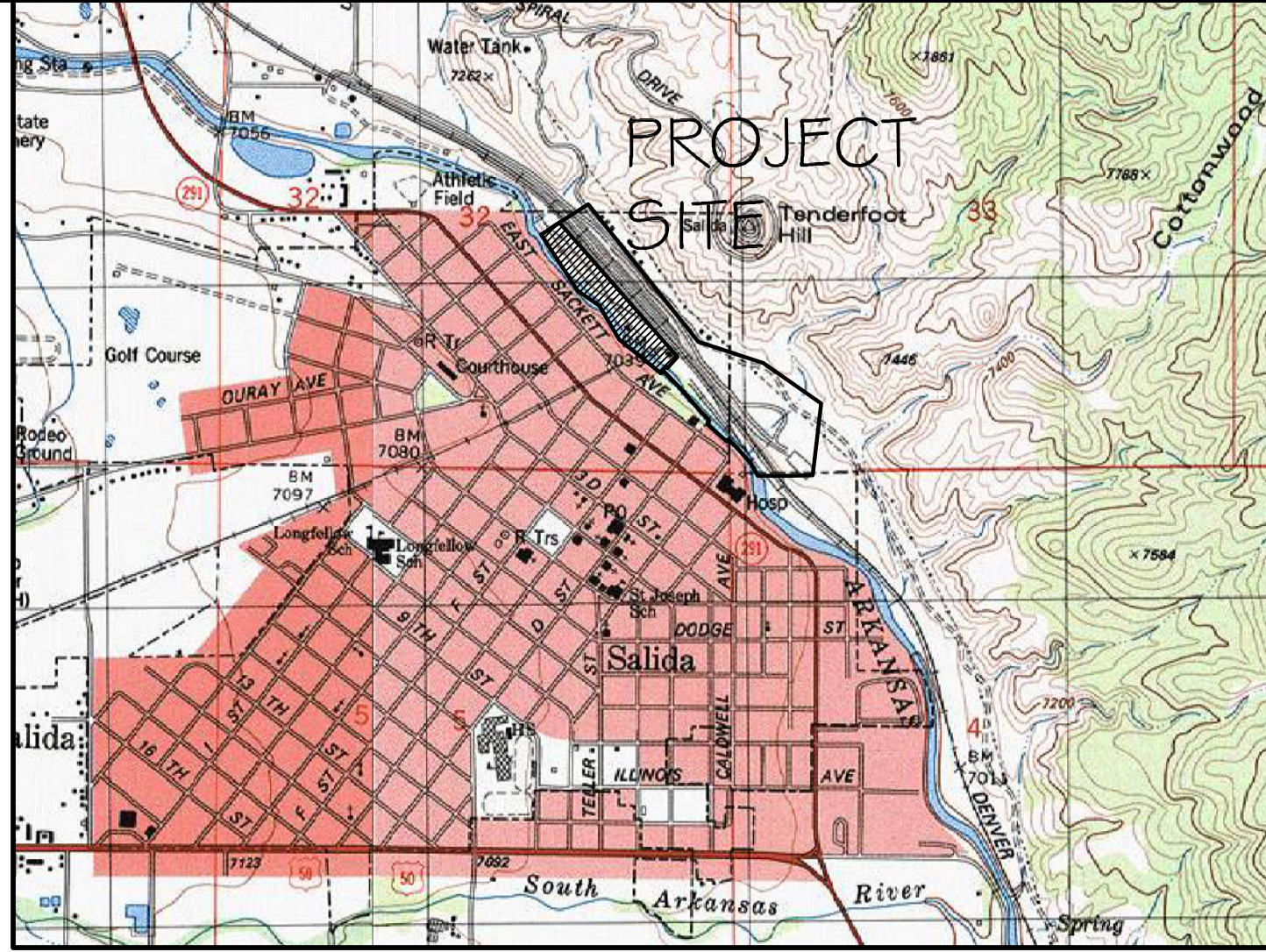

VICINITY MAP
NOT TO SCALE

SALIDA CITY LIMITS

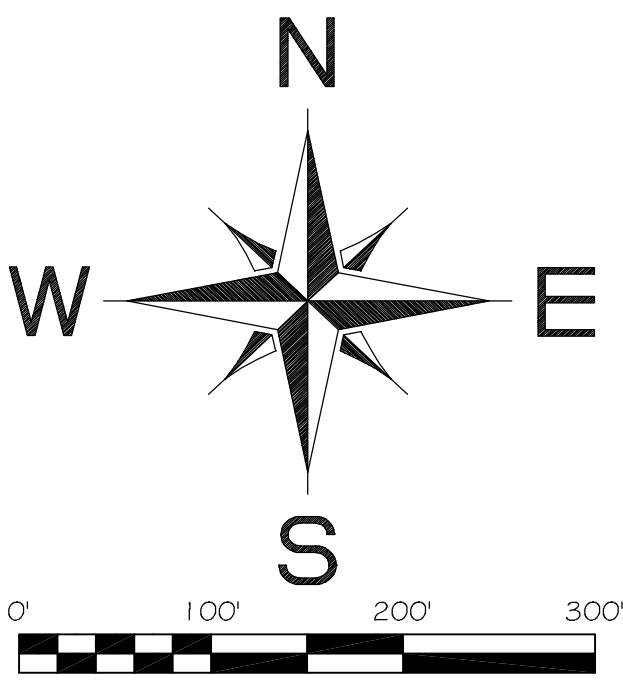
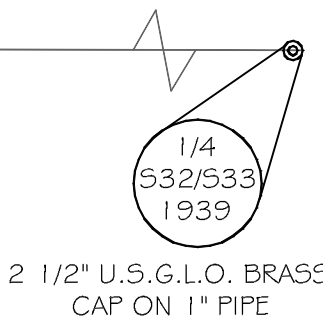

SCALE
1" = 100'

LEGAL DESCRIPTION

ALL THAT TRACT OF LAND LOCATED IN THE SOUTHEAST QUARTER OF SECTION 32, TOWNSHIP 50 NORTH, RANGE 9 EAST OF THE NEW MEXICO PRINCIPAL MERIDIAN, CITY OF SALIDA, CHAFFEE COUNTY, COLORADO, ALSO BEING A PORTION OF THE D&RG.W.R.R. (NOW UNION PACIFIC RAILROAD) DEPOT GROUNDS AS DESCRIBED IN BOOK 18 PAGE 256, BEING MORE PARTICULARLY DESCRIBED AS FOLLOWS:

BEGINNING AT A POINT 50 FEET SOUTHWESTERLY OF THE MOST SOUTHWESTERLY RAILROAD TRACK AND ON THE NORTHWESTERLY BOUNDARY OF SAID DEPOT GROUNDS, FROM WHENCE THE NORTHERLY CORNER OF SAID DEPOT GROUNDS, BEING MARKED BY A 1 1/2" ALUMINUM CAP STAMPED L5 37937, BEARS NORTH 57°13'31" EAST, A DISTANCE OF 350.54 FEET;

THENCE SOUTH 57°13'31" WEST ALONG SAID NORTHWESTERLY BOUNDARY OF THE DEPOT GROUNDS, A DISTANCE OF 226.46 FEET;

THENCE SOUTH 32°59'29" EAST, A DISTANCE OF 683.00 FEET;

THENCE SOUTH 55°16'29" EAST, A DISTANCE OF 272.00 FEET;

THENCE SOUTH 30°16'29" EAST, A DISTANCE OF 398.00 FEET;

THENCE SOUTH 51°19'29" EAST, A DISTANCE OF 542.55 FEET TO THE SOUTHEASTERLY RIGHT-OF-WAY OF F STREET, THIS AND THE PRECEDING 3 COURSES ARE ALONG THE SOUTHEASTERLY BOUNDARY OF SAID DEPOT GROUNDS;

THENCE NORTH 37°42'39" EAST, ALONG SAID SOUTHEASTERLY RIGHT-OF-WAY OF F STREET EXTENDED, A DISTANCE OF 44.89 FEET, MORE OR LESS, TO THE CENTER OF THE ARKANSAS RIVER;

THENCE SOUTH 44°23'59" EAST ALONG SAID CENTER OF THE ARKANSAS RIVER, A DISTANCE OF 32.23 FEET;

THENCE NORTH 43°58'56" EAST, A DISTANCE OF 193.15 FEET, MORE OR LESS, TO A POINT 50 FEET SOUTHWESTERLY OF THE MOST SOUTHWESTERLY RAILROAD TRACK;

THENCE NORTH 41°17'22" WEST AND PARALLEL TO THE MOST SOUTHWESTERLY RAILROAD TRACK, A DISTANCE OF 1838.86 FEET TO THE POINT OF BEGINNING.

CONTAINING 12.12 ACRES, MORE OR LESS.

GENERAL NOTES

- 1) BASIS OF BEARING FOR THIS SURVEY IS GRID NORTH FROM COLORADO STATE PLANE COORDINATE SYSTEM CENTRAL ZONE, BASED ON G.P.S. OBSERVATIONS ALONG THE EAST LINE OF THE SOUTHEAST QUARTER OF SECTION 32 BETWEEN A 2" ALUMINUM CAP SET IN ASPHALT STAMPED L5 28291 AND A 2 1/2" U.S.G.L.O. BRASS CAP ON 1" PIPE HAVING A BEARING OF SOUTH 00°23'00" EAST
- 2) THE PURPOSE OF THIS PLAT IS TO PROPOSE A PURCHASE AREA FROM UNION PACIFIC RAILROAD FOR APPRAISAL PURPOSES. THIS PROPERTY EXHIBIT DOES NOT CONSTITUTE A SUBDIVISION OF LAND OR CREATE A LEGALLY SUBDIVIDED LOT.

LAND SURVEYOR'S CERTIFICATE

I, SYDNEY A. SCHIEREN, A REGISTERED LAND SURVEYOR LICENSED TO PRACTICE IN THE STATE OF COLORADO, DO HEREBY CERTIFY THAT THIS LAND SURVEY WAS PERFORMED UNDER MY DIRECT SUPERVISION, AND THAT THE PLAT REPRESENTS THE RESULTS OF SAID SURVEY AND IS TRUE AND CORRECT TO THE BEST OF MY KNOWLEDGE.

SYDNEY A. SCHIEREN
COLORADO P.L.S. 37937

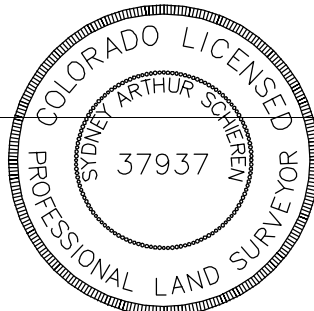

REVISED:	
JOB # 1435	
DATE: MAY 12, 2014	
SHEET 1 OF 1	

**UNION PACIFIC
RAILROAD PROPERTY
EXHIBIT**

LOCATED WITHIN THE SOUTHEAST QUARTER
OF SECTION 32, TOWNSHIP 50 NORTH,
RANGE 9 EAST OF THE NEW MEXICO
PRINCIPAL MERIDIAN,
CITY OF SALIDA,
CHAFFEE COUNTY, COLORADO

**LANDMARK
SURVEYING & MAPPING**

P.O. BOX 668 SALIDA, CO 81201
PH 719.539.4021 FAX 719.539.4031