

McNabb Rd to Bottom Rd Palmer

# High Intensity Soil Map for Subsurface Drain Field System

Any Cutting, filling or Compaction will void this soil map.  
This soil map is to evaluate the site for a subsurface sewage disposal system only.

For: Andrew Finger  
County: Grundy

| Soil name and slope         | Estimated absorption rate (mpi) | Depth | Soil Improvement practices/ Soil notes | Perc status | Color code    |
|-----------------------------|---------------------------------|-------|--|-------------|---------------|
| [Ap] Apison<br>0-15% slopes | 45 mpi, 0-30"<br>> 75 mpi, 30"+ | 30 in | NA                                     | NA          | RED/<br>GREEN |

## LEGEND

- Control flag 4
- Dirt/gravel road
- Drain, <1 foot, 15 foot setback
- Drain, >1 foot, 25 foot setback
- Cut bank
- Sink hole
- Fence
- Well
- Rock outcrop
- Karst Percable KP
- Percable Non-Karst P
- Non-Percable NPW
- Wet
- Non-Percable NP
- Non-Percable NP
- Rock
- Non-Percable NP

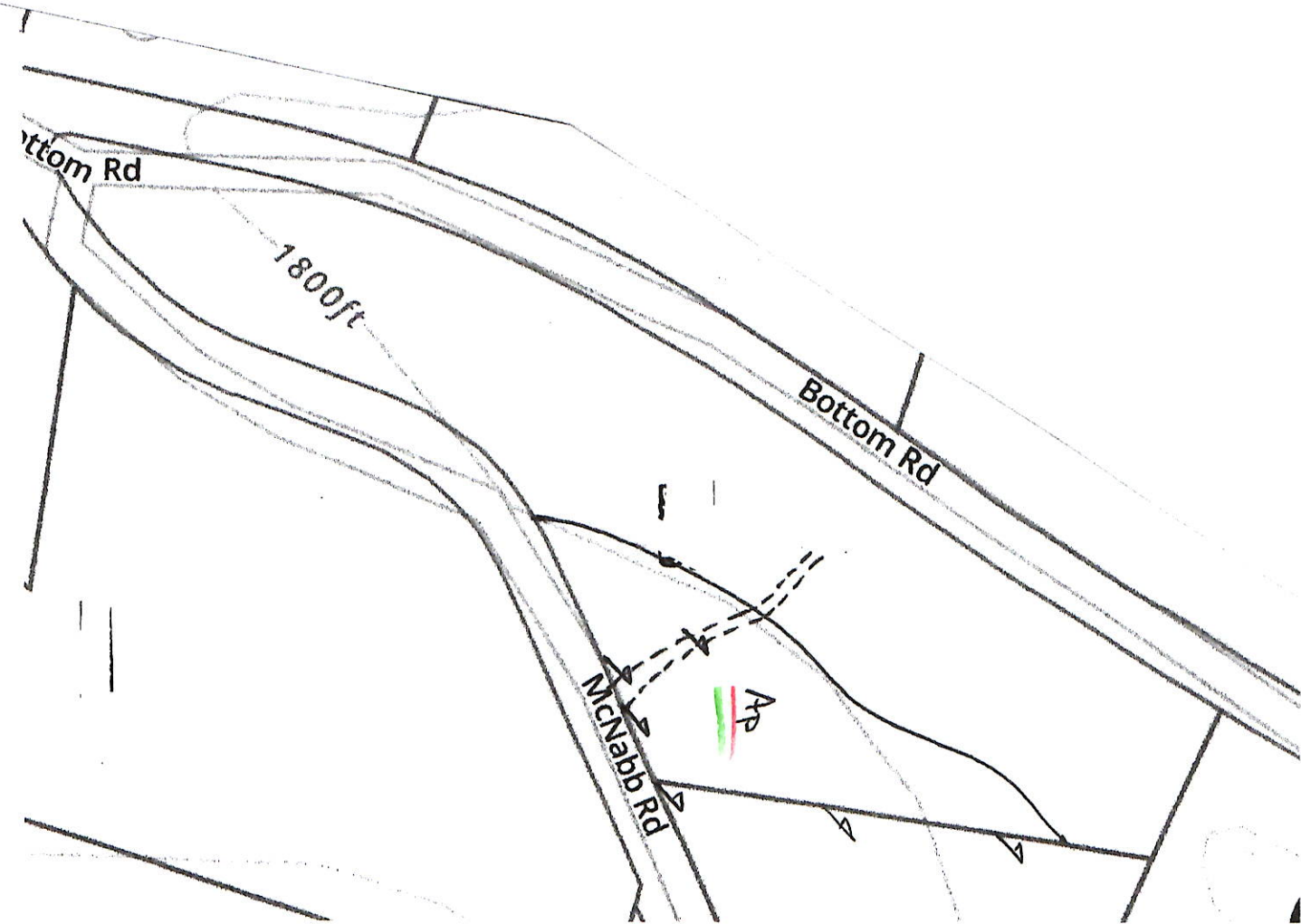
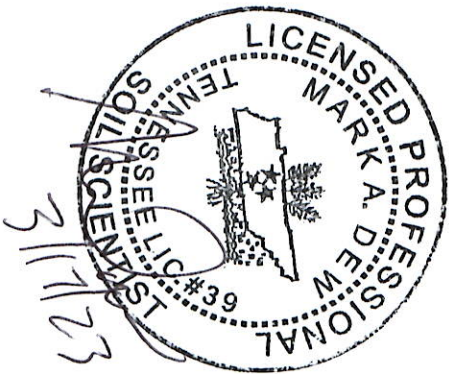

I affirm that this soil map meets the standards established in the Regulations to Govern Subsurface Sewage Disposal, the Soils Handbook, and the Soil Taxonomy. No other warranties are made or implied. Signature of Soil Consultant does not constitute approval of this map by the Division of Water Resources. (High Intensity) Soil Map Completed by Mark Dew, Soil Scientist