

NOTES

1. BEARINGS ARE BASED UPON THE TEXAS COORDINATE SYSTEM OF 1983 (NAD83), NORTH CENTRAL ZONE.
2. A CERTIFIED METES AND BOUNDS DESCRIPTION HAS BEEN PREPARED UNDER THE SAME JOB NUMBER AS A PART OF THIS PROFESSIONAL SERVICE.
3. THIS PROFESSIONAL SERVICE WAS PERFORMED WITHOUT BENEFIT OF HAVING BEEN FURNISHED A TITLE COMMITMENT. EASEMENTS AND/OR OTHER MATTERS AND/OR ISSUES RELATING TO TITLE COULD AND MAY EXIST.
4. ACCORDING TO TEXAS LOCAL GOVERNMENT CODE, CHAPTER 212.004 AND 212.005, DIVIDING ANY TRACT OR LOT INTO TWO OR MORE PARTS WITHOUT BENEFIT OF A SUBDIVISION PLAT APPROVED AND RECORDED WITH THE COUNTY CLERK, IS A VIOLATION OF CITY ORDINANCE AND/OR STATE LAW, SUBJECTING THE VIOLATOR TO FINES AND/OR THE WITHHOLDING OF UTILITIES AND BUILDING PERMITS.

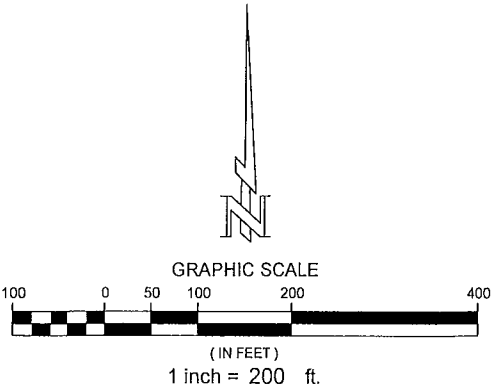

WILLIAM H. BOYCE SURVEY
A-41

LEGEND	
	POWER POLE
	WATER METER
	CONTROLLING MONUMENT
	OVERHEAD ELECTRIC

SURVEYORS CERTIFICATION

I HEREBY CERTIFY THIS PLAT REPRESENTS A SURVEY MADE ON THE GROUND UNDER MY SUPERVISION AND CORRECTLY REFLECTS THE FACTS FOUND AT THE TIME OF SAID SURVEY. THERE ARE NO VISIBLE AND OBSERVED IMPROVEMENTS, EASEMENTS/RIGHTS-OF-WAY, OR PROTRUSIONS EXCEPT AS SHOWN HEREON. THIS SURVEY WAS MADE WITHOUT THE BENEFIT OF A CURRENT TITLE COMMITMENT, AND MAY BE SUBJECT TO RECORD EVIDENCE WHICH IS NOT AVAILABLE FOR CONSIDERATION AT THIS TIME. THIS SURVEY SUBSTANTIALLY CONFORMS TO THE CURRENT GENERAL RULES OF PROCEDURES AND PRACTICES, ESTABLISHED BY THE BOARD OF PROFESSIONAL LAND SURVEYING, AS AUTHORIZED BY THE PROFESSIONAL LAND SURVEYING PRACTICES ACT (ART 5282C, V.T.C.S.).

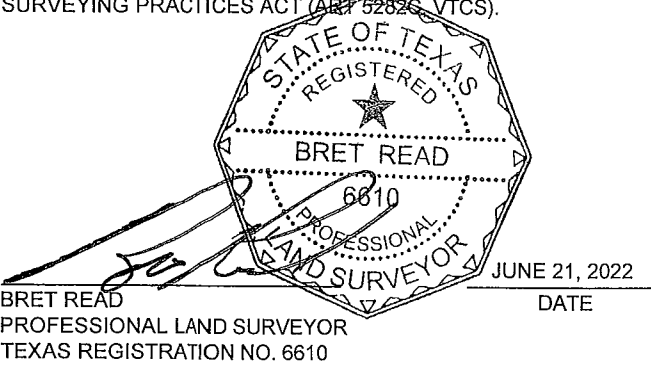

PLAT OF SURVEY OF
36.946 ACRES
IN THE ABNER E. TURNER SURVEY, A-574
BOWIE COUNTY, TEXAS

360 SURVEYING
310 H. G. MOSLEY PKWY., LONGVIEW, TEXAS 75604
(903) 387-2577 WWW.360SURV.COM
TBPELS 10194293

JUNE 22, 2022 | DRAWN BY: MTW | CHECKED BY: JBR | JOB # 15080

Filename: T:\15080 - Bachelor, Tommy - Survey of 37.411 Acres in the A E Turner HRS, A-574, Bowie Co, TX\DRAWING\15080 BASE.dwg

