

# FOOTHILLS ESTATES

Pickens County



00 HIGHWAY 178 & HIGHWAY 11 PICKENS, SC • FOR SALE



## PROPERTY HIGHLIGHTS

- A Portion of Pickens County Tax Map # 4175-03-32-0783
- Three ±10 Acres Lots on Highway 178 Pickens, SC 29671
- Double Road Frontage: Varies per Lot
- Rolling Topography | Mature Hardwoods & Pines
- Zoned for Ambler Elementary School | Pickens Middle School | Pickens High School
- Possible Utilities – Power, Cable & Septic Capability
- \*Acreage, Taxes and Utility to be verified by Buyer or Buyer's Agent

## OFFERING SUMMARY

Lot #	ACREAGE	SALES PRICE
Lot 1:	±10 Acres	\$165,000
Lot 2:	±10 Acres	\$165,000
Lot 3:	±10 Acres	\$135,000

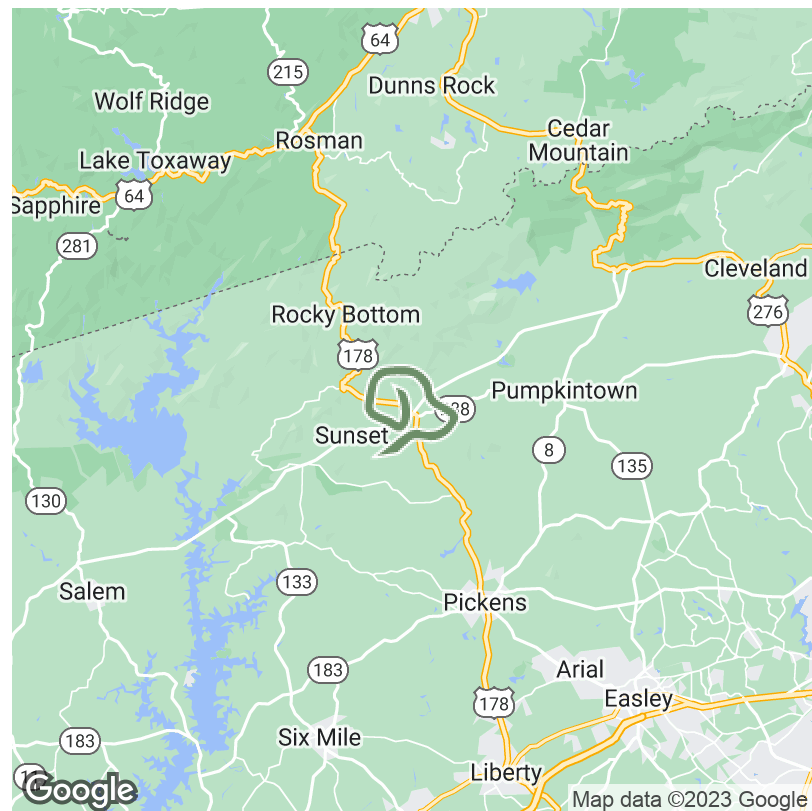

## ANDERSON DRAKE

Associate  
864.546.0342  
adrake@reedygpg.com

**REEDY LAND CO.**  
P.O. Box 17009  
Greenville, SC 29606  
864.610.5869  
reedylandco.com



# FOOTHILLS ESTATES

Pickens County



00 HIGHWAY 178 & HIGHWAY 11 PICKENS, SC • FOR SALE

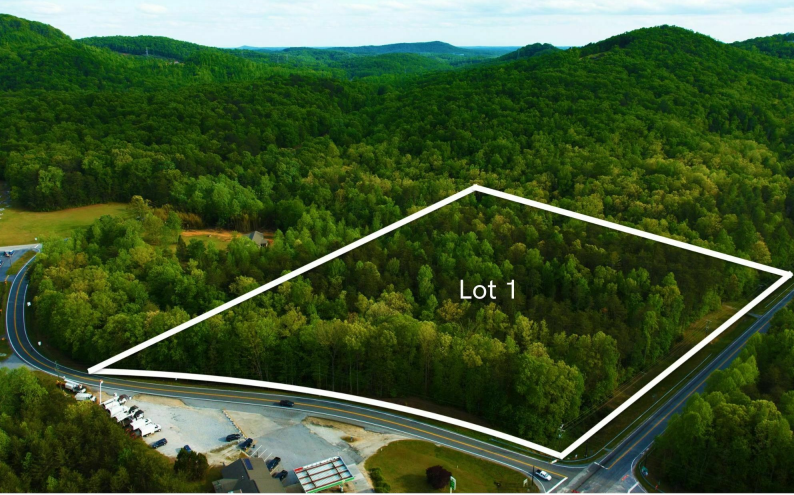

## ANDERSON DRAKE

Associate

864.546.0342

[adrake@reedygpg.com](mailto:adrake@reedygpg.com)

## REEDY LAND CO.

P.O. Box 17009

Greenville, SC 29606

864.610.5869

[reedylandco.com](http://reedylandco.com)



# FOOTHILLS ESTATES

Pickens County



00 HIGHWAY 178 & HIGHWAY 11 PICKENS, SC • FOR SALE

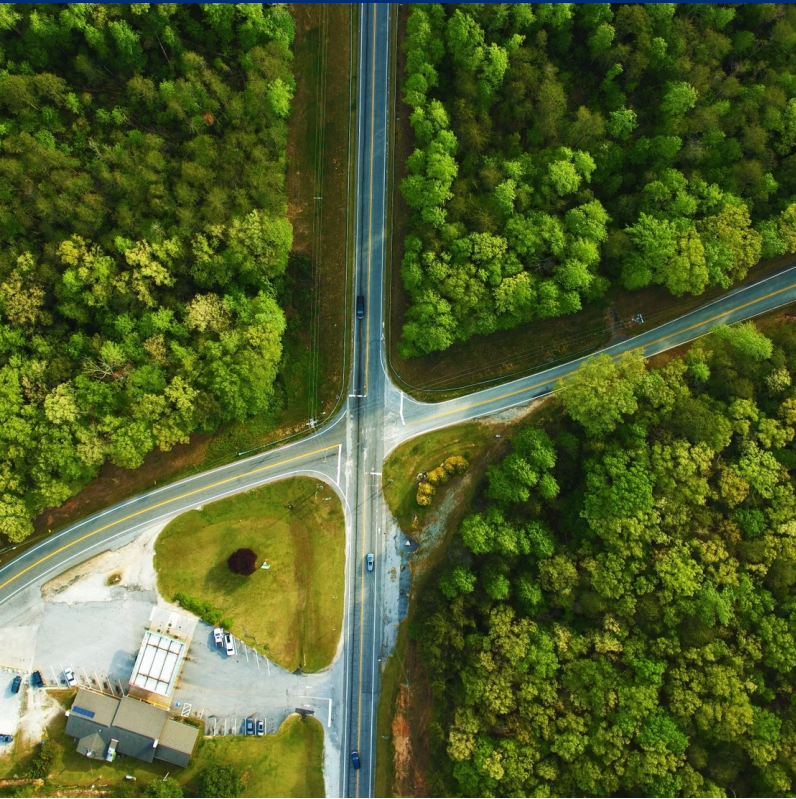

## PROPERTY DESCRIPTION

The Cherokee Foothills Scenic Highway is one of the most sought-after areas the Upstate rarely has to offer until now! We at Reedy Land Co are proud to present you with this very rare opportunity! We have three  $\pm 10$ -acre homesites for sale! Each homesite allows you to build the home of your dreams in a dream location! The mountain views will leave you speechless along with everything an outdoorsmen can dream of. A dream Saturday would be to drive 5 minutes you can drive over to Table Rock State Park for an awesome day of hiking or to drive 20 minutes and spend the day on Lake Keowee! On Sunday you can be at The Rock Golf Club for a tee time in just 3 minutes! All of this and more is available to you with these tracts at Foothills Estates Homesites!

## LOCATION DESCRIPTION

$\pm 10$  Minutes to Pumpkintown  
 $\pm 13$  Minutes to Pickens  
 $\pm 28$  Minutes to Travelers Rest  
 $\pm 45$  Minutes to Greenville

### ANDERSON DRAKE

Associate  
864.546.0342  
adrake@reedygpg.com

### REEDY LAND CO.

P.O. Box 17009  
Greenville, SC 29606  
864.610.5869  
reedylandco.com