

SW258

Rec
5-4-07

WELL LOG

[illegible]

WELL HEAD

DETAILS	#1	#2	#3
Static Water Level (Ft. Below Grade)	160		
Pumping Rate (GPM)	10		
Pumping Level (Ft. Below Grade)	480		
Duration of Test (In Hours)	1		
Recovery Time to Static Level (In Hours)	2		

Pitless Adapter: Type, Make, Etc. _____

Well Cap: Type, Make, Etc. _____

Well Seal: Type, Make, Etc. _____

Well Platform: _____

Length _____ Width _____ Thickness _____

Grouting: ☒ Yes ☐ No

All Public Water Supplies must be grouted.

I hereby certify that this well was drilled and constructed under my supervision, in compliance with all requirements of the referenced permit, and that this record is true to the best of my knowledge and belief.

B. MARK SMITH
Name
B.W. SMITH WELL DRILLING INC.
Registered Business Name
Signed 
001
Certification No.
4-25-07
Date

Hampshire County Health Department On-Site Sewage Disposal System Inspection Form

Permit # **ST-14-07-158**

Name of Owner: John Stahovic Installer: Terry Kesner
Address: 12405 Lime Kiln Rd, Fulton, Md 20759
Property Location: Lost Mtn. Lot # 88 Lot Size: 3.562 Acres
Type of Facility: Residence Facility is: ☒ New ☐ Existing
Design Loading in gpd/# Bedrooms: 3 Source of Water: Proposed Well

SEWAGE TANK COMPONENT

Capacity in Gallons: 1000 Material: precast concrete Manufacturer: _____
Pump Chamber gal
Distances (in feet) of Tank to: Dwelling 46'
Private ☐ Public ☐ Water Source: Property Line: >50'

ON-SITE DISPOSAL SYSTEM

Class I Systems: Standard Soil Trenches () or Bed () Gravelless Pipe (), Diameter In.
Chamber Soil Absorption Trenches (X) or Bed ()
Class II Systems: Pumped/Dosed Soil Absorption Trenches () or Bed ()
Evapotranspiration Trenches () or Bed ()
Shallow Soil Absorption Trenches () or Bed () Other:

No. of Lines: 3 Length (in feet) of Each: 60,
Width of Trenches: 36 inches/feet Depth to Bottom of Field: 24 inches
If Bed, Dimensions (in feet): If Chamber System, Name: , No. of Units:
Approved and Adequate Materials Used? Yes (X) No () Size Equates to 900 sq ft of SGF
Distance (in feet) of System to: Dwelling 180' Private () Public ()
Water Source: Property Line: 30'

Remarks: well not drilled at time of inspection
GPS: N39 17 11.9 W78 43 44.0

An inspection indicates that
The sewage disposal system
Described above

DOES MEET X

DOES NOT MEET ☐ or

CANNOT BE DETERMINED TO

MEET ☐ the minimum standards
Established by the West Virginia
Bureau of Public Health.

To correct a health hazard,
Modifications to existing systems
May be done to improve part of a
System. Such modifications may
Not be able to be designated as
a Does meet system since
Inadequate information is known.

Although many factors
Contribute to the successful
Functioning of a sewage disposal
System, this office recommends
Water conservation and
Maintaining an even usage of
Water throughout the week.

Visit Date(s):

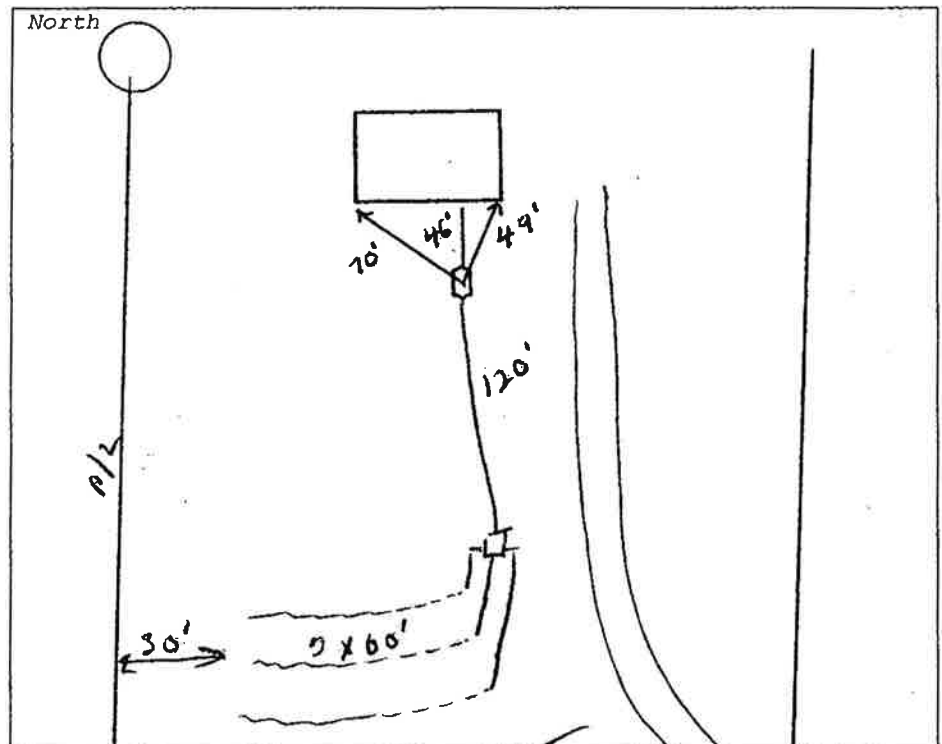

FINAL INSPECTION DATE: 4/10/2007

SANITARIAN: Brian M. Miller