

Soils Map

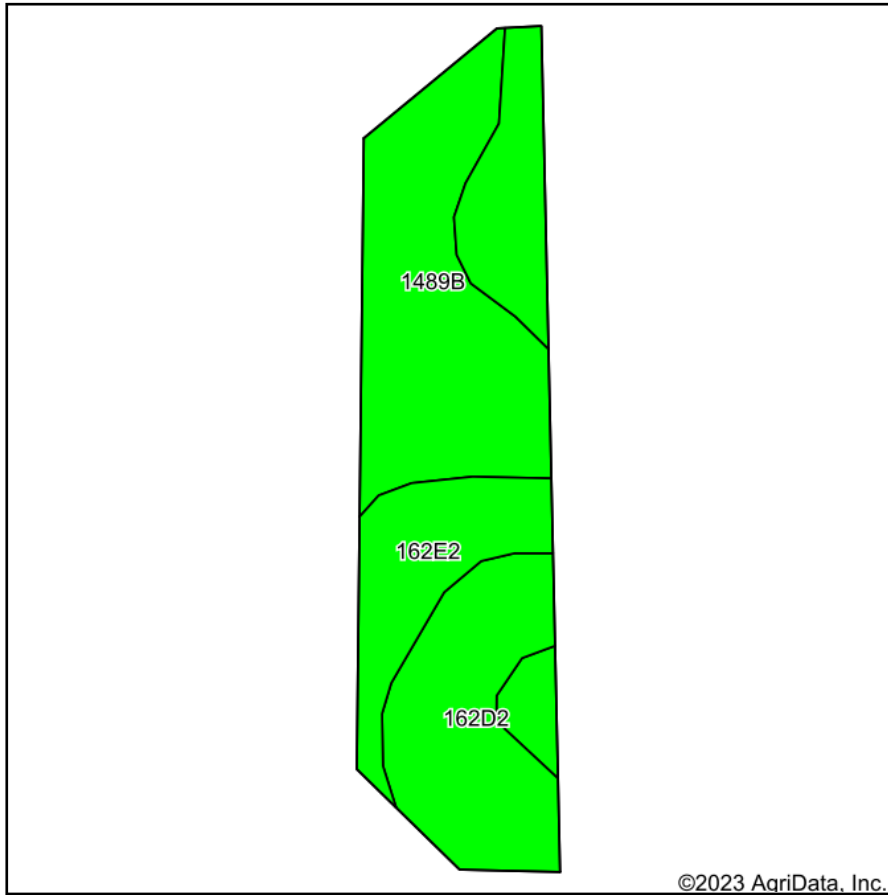

Soils data provided by USDA and NRCS.

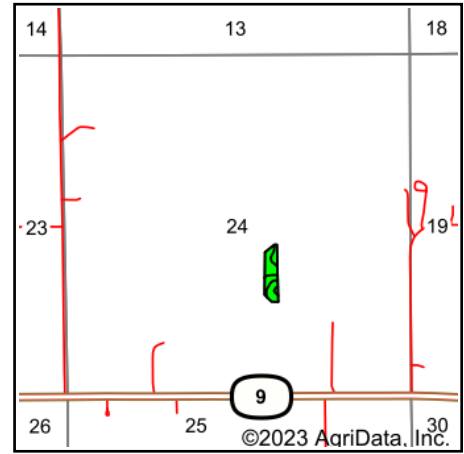

State: **Iowa**
 County: **Winneshiek**
 Location: **24-98N-9W**
 Township: **Madison**
 Acres: **3.62**
 Date: **4/7/2023**



Maps Provided By:



Area Symbol: IA191, Soil Area Version: 31

Code	Soil Description	Acres	Percent of field	CSR2 Legend	Non-Irr Class *c	CSR2**	CSR	*n NCCPI Overall	*n NCCPI Corn	*n NCCPI Small Grains	*n NCCPI Soybeans
162D2	Downs silt loam, 9 to 14 percent slopes, moderately eroded	1.44	39.8%		IIIe	54		81	81	68	67
1489B	Lawson-Ossian complex, 0 to 4 percent slopes	1.41	39.0%		IIw	77	82	75	63	43	75
162E2	Downs silt loam, 14 to 18 percent slopes, moderately eroded	0.64	17.7%		IVe	42	51	76	76	63	62
762C	Tama-Downs complex, driftless, 5 to 9 percent slopes	0.13	3.6%		IIIe	88	75	91	91	77	83
Weighted Average						2.79	62.1	*n 78.1	*n 73.5	*n 57.7	*n 69.8

**IA has updated the CSR values for each county to CSR2.

*- CSR weighted average cannot be calculated on the current soils data, use prior data version for csr values.

*n: The aggregation method is "Weighted Average using all components"

*c: Using Capabilities Class Dominant Condition Aggregation Method

Soils data provided by USDA and NRCS.