

DESCRIPTION - 30.00 FEET WIDE ROADWAY & UTILITY EASEMENT

A 30.00 FEET ROADWAY & UTILITY EASEMENT LYING IN THE NORTHEAST QUARTER OF SECTION 26, TOWNSHIP 62 NORTH, RANGE 9 WEST, LEWIS COUNTY, MISSOURI AND LYING 30.00 FEET SOUTHERLY AND COINCIDENT WITH THE FOLLOWING DESCRIBED LINE TO-WIT:

COMMENCING AT A PLUMB 1/2" IRON PIN MARKING THE NORTHEAST CORNER OF SAID SECTION 24; THENCE SOUTH 01 DEGREE, 59 MINUTES AND 00 SECONDS WEST ALONG THE EAST LINE OF SAID SECTION 908.15 FEET TO THE TRUE POINT OF BEGINNING OF SAID LINE; THENCE SOUTH 87 DEGREES, 28 MINUTES AND 34 SECONDS WEST LEAVING SAID EAST LINE 42.50 FEET; THENCE SOUTH 07 DEGREE, 59 MINUTES AND 07 SECONDS WEST 239.64 FEET; THENCE SOUTH 23 DEGREES, 37 MINUTES AND 27 SECONDS WEST 26.95 FEET; THENCE SOUTH 01 DEGREE, 45 MINUTES AND 29 SECONDS WEST 32.61 FEET; THENCE SOUTH 80 DEGREES, 51 MINUTES AND 39 SECONDS WEST 44.52 FEET; THENCE NORTH 71 DEGREES, 07 MINUTES AND 52 SECONDS WEST 37.17 FEET; THENCE NORTH 31 DEGREES, 31 MINUTES AND 10 SECONDS WEST 105.49 FEET; THENCE NORTH 56 DEGREES, 27 MINUTES AND 34 SECONDS WEST 68.41 FEET; THENCE SOUTH 76 DEGREES, 12 MINUTES AND 15 SECONDS WEST 44.79 FEET; THENCE SOUTH 11 DEGREES, 37 MINUTES AND 15 SECONDS WEST 67.26 FEET; THENCE SOUTH 73 DEGREES, 15 MINUTES AND 53 SECONDS WEST 299.15 FEET; THENCE SOUTH 85 DEGREES, 09 MINUTES AND 12 SECONDS WEST 39.54 FEET; THENCE NORTH 38 DEGREES, 22 MINUTES AND 08 SECONDS WEST 54.61 FEET; THENCE NORTH 29 DEGREES, 42 MINUTES AND 24 SECONDS WEST 80.37 FEET; THENCE NORTH 52 DEGREES, 03 MINUTES AND 32 SECONDS WEST 73.56 FEET; THENCE NORTH 45 DEGREES, 49 MINUTES AND 39 SECONDS WEST 114.95 FEET; THENCE NORTH 60 DEGREES, 59 MINUTES AND 42 SECONDS WEST 54.29 FEET; THENCE NORTH 45 DEGREES, 41 MINUTES AND 36 SECONDS WEST 355.76 FEET; THENCE NORTH 08 DEGREES, 13 MINUTES AND 09 SECONDS WEST 340.55 FEET; THENCE NORTH 42 DEGREES, 48 MINUTES AND 41 SECONDS WEST 245.04 FEET; THENCE SOUTH 15 DEGREES, 06 MINUTES AND 22 SECONDS WEST 159.61 FEET; THENCE SOUTH 39 DEGREES, 24 MINUTES AND 09 SECONDS WEST 25.86 FEET; THENCE SOUTH 71 DEGREES, 32 MINUTES AND 20 SECONDS WEST 26.21 FEET; THENCE SOUTH 88 DEGREES, 08 MINUTES AND 47 SECONDS WEST 62.45 FEET; THENCE SOUTH 68 DEGREES, 45 MINUTES WEST 217.07 FEET; THENCE SOUTH 24 DEGREES, 10 MINUTES AND 36 SECONDS WEST 49.90 FEET; THENCE SOUTH 13 DEGREES, 46 MINUTES AND 33 SECONDS WEST 94.51 FEET; THENCE SOUTH 09 DEGREES, 00 MINUTES AND 56 SECONDS EAST 216.15 FEET; THENCE SOUTH 14 DEGREES, 22 MINUTES AND 46 SECONDS EAST 104.45 FEET; THENCE SOUTH 19 DEGREES, 45 MINUTES AND 03 SECONDS EAST 178.04 FEET; THENCE SOUTH 02 DEGREES, 15 MINUTES AND 46 SECONDS EAST 36.96 FEET; THENCE SOUTH 07 DEGREES, 53 MINUTES AND 11 SECONDS WEST 46.34 FEET; THENCE SOUTH 19 DEGREES, 40 MINUTES AND 43 SECONDS WEST 66.44 FEET; THENCE SOUTH 36 DEGREES, 27 MINUTES AND 13 SECONDS WEST 38.02 FEET; THENCE SOUTH 57 DEGREES, 50 MINUTES WEST 40.52 FEET; THENCE SOUTH 73 DEGREES, 06 MINUTES AND 09 SECONDS WEST 64.21 FEET; THENCE SOUTH 54 DEGREES, 39 MINUTES AND 22 SECONDS WEST 36.94 FEET; THENCE SOUTH 28 DEGREES, 05 MINUTES AND 12 SECONDS WEST 39.02 FEET; THENCE SOUTH 07 DEGREES, 39 MINUTES AND 30 SECONDS WEST 64.68 FEET; THENCE SOUTH 08 DEGREES, 06 MINUTES AND 23 SECONDS EAST 93.83 FEET; THENCE SOUTH 37 DEGREES, 57 MINUTES AND 13 SECONDS EAST 95.70 FEET; THENCE SOUTH 09 DEGREES, 44 MINUTES AND 52 SECONDS WEST 211.03 FEET; THENCE SOUTH 11 DEGREES, 09 MINUTES AND 45 SECONDS EAST 199.34 FEET; THENCE SOUTH 07 DEGREES, 03 MINUTES AND 29 SECONDS WEST 135.19 FEET; THENCE SOUTH 10 DEGREES, 56 MINUTES AND 02 SECONDS EAST 166.70 FEET; THENCE SOUTH 09 DEGREES, 24 MINUTES AND 33 SECONDS EAST 150.97 FEET; THENCE SOUTH 01 DEGREE, 06 MINUTES AND 15 SECONDS EAST 144.72 FEET TO LEWIS COUNTY ROUTE #326 AND THE POINT OF TERMINATION OF SAID LINE. AS PER SURVEY #2017-005166 OF DOUG WALKER, MISSOURI PROFESSIONAL LAND SURVEYOR #2014000200 DURING FEBRUARY OF 2018.

THIS PLAT AS A RESULT OF A SURVEY MADE UNDER MY
DIRECT SUPERVISION ON FEBRUARY 7, 2018 REPRESENTS A
TRUE AND ACCURATE RECORD OF SAID SURVEY AND WAS
EXECUTED IN ACCORDANCE WITH THE CURRENT STANDARDS FOR
RURAL PROPERTY BOUNDARY SURVEYS OF THE MISSOURI
DEPARTMENT OF AGRICULTURE.

 2-8-18
DOUG WALKER, P.L.S. #2014000200 – MISSOURI

A 30.00 FEET WIDE ROADWAY & UTILITY EASEMENT LYING IN THE
NORTHEAST QUARTER OF SECTION 26, TOWNSHIP 62 NORTH,
RANGE 9 WEST, LEWIS COUNTY, MISSOURI.

PLAT OF EASEMENT

(AS MADE FOR LARRY KENNEDY)



JANES SURVEYING, INC.
MISSOURI STATE CERTIFICATE
OF AUTHORITY #000342
RENEWAL: 12-31-19

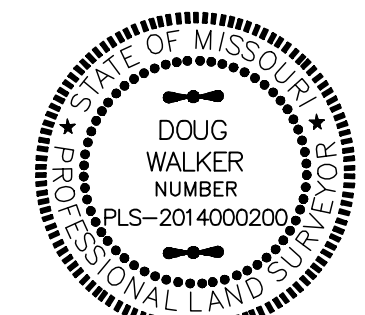

LICENSE RENEWAL: 12-31-18

DOUG WALKER, SURVEYOR
MO# PLS-2014000200

SI PROJECT NO.

2017-005166

FIELD BOOK NO: --

FIELD D: JUSTIN

DRAWN: TYLER

CHECKED: DOUG

REVISÉ:

REVISÉ:



LICENSE RENEWAL: 12-31-18



Description – Larry Kennedy
30.00 Feet Wide Roadway & Utility Easement – Page 1 of 2

2017-005166
February 8, 2018

A 30.00 feet roadway & utility easement lying in the Northeast Quarter of Section 26, Township 62 North, Range 9 West, Lewis County, Missouri and lying 30.00 feet Southerly and coincident with the following described line to-wit:

Commencing at a found 1/2" iron pin marking the Northeast Corner of said Section 26; thence South 01 degree, 59 minutes and 00 seconds West along the East line of said Section 908.15 feet to the **True Point of Beginning** of said line; thence South 87 degrees, 28 minutes and 34 seconds West leaving said East line 42.50 feet; thence South 01 degree, 59 minutes and 07 seconds West 239.64 feet; thence South 23 degrees, 37 minutes and 27 seconds West 26.95 feet; thence South 49 degrees, 45 minutes and 29 seconds West 32.61 feet; thence South 80 degrees, 51 minutes and 39 seconds West 44.52 feet; thence North 71 degrees, 07 minutes and 52 seconds West 37.17 feet; thence North 31 degrees, 31 minutes and 10 seconds West 105.49 feet; thence North 56 degrees, 27 minutes and 34 seconds West 68.41 feet; thence South 76 degrees, 12 minutes and 15 seconds West 44.79 feet; thence South 11 degrees, 37 minutes and 15 seconds West 67.26 feet; thence South 73 degrees, 15 minutes and 53 seconds West 299.15 feet; thence South 85 degrees, 09 minutes and 12 seconds West 39.54 feet; thence North 38 degrees, 22 minutes and 08 seconds West 54.61 feet; thence North 29 degrees, 42 minutes and 24 seconds West 80.37 feet; thence North 52 degrees, 03 minutes and 32 seconds West 73.56 feet; thence North 45 degrees, 49 minutes and 39 seconds West 114.95 feet; thence North 60 degrees, 59 minutes and 42 seconds West 54.29 feet; thence North 45 degrees, 41 minutes and 36 seconds West 355.76 feet; thence North 08 degrees, 13 minutes and 09 seconds West 340.55 feet; thence North 42 degrees, 48 minutes and 41 seconds West 245.04 feet; thence South 15 degrees, 06 minutes and 22 seconds West 159.61 feet; thence South 39 degrees, 24 minutes and 09 seconds West 25.86 feet; thence South 71 degrees, 32 minutes and 20 seconds West 26.21 feet; thence South 88 degrees, 08 minutes and 47 seconds West 62.45 feet; thence South 68 degrees, 45 minutes and 50 seconds West 49.90 feet; thence South 24 degrees, 10 minutes and 36 seconds West 217.07 feet; thence South 13 degrees, 46 minutes and 33 seconds West 94.51 feet; thence South 09 degrees, 00 minutes and 56 seconds East 216.15 feet; thence South 14 degrees, 22 minutes and 46 seconds East 104.45 feet; thence South 19 degrees, 45 minutes and 03 seconds East 178.04 feet; thence South 02 degrees, 15 minutes and 46 seconds East 36.96 feet; thence South 07 degrees, 53 minutes and 11 seconds West 46.34 feet;

thence South 19 degrees, 40 minutes and 43 seconds West 66.44 feet; thence South 36 degrees, 27 minutes and 13 seconds West 38.02 feet; thence South 57 degrees, 50 minutes and 25 seconds West 40.52 feet; thence South 73 degrees, 06 minutes and 09 seconds West 64.21 feet; thence South 54 degrees, 39 minutes and 22 seconds West 36.94 feet; thence South 28 degrees, 05 minutes and 12 seconds West 39.02 feet; thence South 07 degrees, 39 minutes and 30 seconds West 64.68 feet; thence South 08 degrees, 06 minutes and 23 seconds East 93.83 feet; thence South 37 degrees, 57 minutes and 13 seconds East 95.70 feet; thence South 09 degrees, 44 minutes and 52 seconds West 211.03 feet; thence South 11 degrees, 09 minutes and 45 seconds East 199.34 feet; thence South 07 degrees, 03 minutes and 29 seconds West 135.19 feet; thence South 10 degrees, 56 minutes and 02 seconds East 166.70 feet; thence South 09 degrees, 24 minutes and 33 seconds East 150.97 feet; thence South 01 degree, 06 minutes and 15 seconds East 144.72 feet to Lewis County Route #326 and the Point of Termination of said line. As per survey #2017-005166 of Doug Walker, Missouri Professional Land Surveyor #2014000200 during February of 2018.

Prepared by
JANES SURVEYING, Inc.
222 South Main
Palmyra, Missouri 63461

