

Soils Map

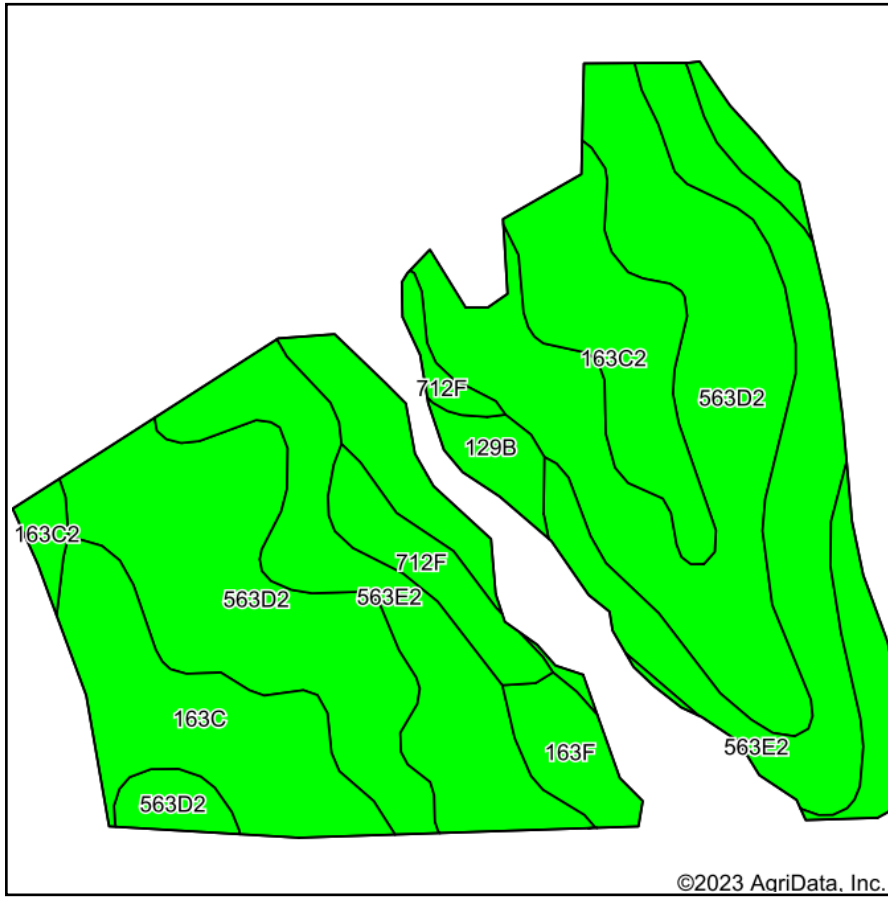

Soils data provided by USDA and NRCS.

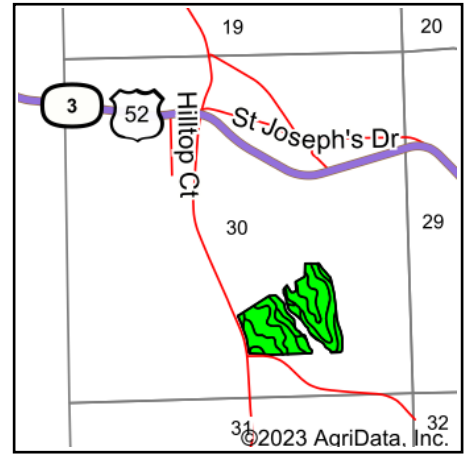

State: **Iowa**
 County: **Dubuque**
 Location: **30-90N-1E**
 Township: **Jefferson**
 Acres: **31.14**
 Date: **6/5/2023**



Maps Provided By:



Area Symbol: IA061, Soil Area Version: 24

Code	Soil Description	Acres	Percent of field	CSR2 Legend	Non-Irr Class *c	CSR2**	CSR	*n NCCPI Overall	*n NCCPI Corn	*n NCCPI Small Grains	*n NCCPI Soybeans
563D2	Rozetta-Eleroy silt loams, 9 to 14 percent slopes, moderately eroded	12.20	39.2%		IIIe	42	54	74	73	63	63
563E2	Rozetta-Eleroy silt loams, 14 to 18 percent slopes, moderately eroded	7.62	24.5%		IIIe	30	45	71	71	61	60
163C	Fayette silt loam, 5 to 9 percent slopes	3.16	10.1%		IIIe	75	70	86	86	74	74
129B	Arenzville-Chaseburg complex, 1 to 5 percent slopes	3.13	10.1%		IIw	73	63	85	85	71	83
163C2	Fayette silt loam, 5 to 9 percent slopes, moderately eroded	2.80	9.0%		IIIe	72	68	81	81	69	66
712F	Schapville silt loam, 18 to 30 percent slopes	1.34	4.3%		VIe	5	5	25	25	20	13
163F	Fayette silt loam, 18 to 25 percent slopes	0.89	2.9%		VIe	21	30	62	62	43	48
Weighted Average					3.11	46	52.8	*n 73.8	*n 73.4	*n 62.5	*n 63.1

**IA has updated the CSR values for each county to CSR2.

*n: The aggregation method is "Weighted Average using all components"

*c: Using Capabilities Class Dominant Condition Aggregation Method

Soils data provided by USDA and NRCS.