



Specifications for Project

0000 FAWN DR
INTEGRITY ALL STARS

Salesperson

Dwayne Dixon

ddixon@spencerstv.com



REMINDER:

To ensure a smooth project it is the responsibility of the homeowner / purchaser of appliances for this project to share all the attached specifications to ensure the cabinet provider, contractor, or any other tradesperson have all the information required to complete their work accurately.

Specifications are subject to change. If any tradesperson has questions regarding the attached specifications please contact our sales associate.

0000 FAWN DR
INTEGRITY ALL STARS0000 FAWN DR
PINE, AZ 85544

<i>Models</i>	<i>Pages</i>
PYE22KYNFS GE Refrigeration	3-4
PDT715SYNFS GE Dishwasher	5-6
PGB935YPFS GE Range	7-8
PVM9005SJSS GE Microwave	9-11
WKEX200HBA LG Washer-Dryer	12-17

**Spencers TV & Appliance**
spencerstv.com**Dwayne Dixon**
sales
6023124207Invoice **JC6893**
Version 1.1Tue, Sep 28, 2021
4:30 PM UMSTenterprise.steelcod.com/sp/spnr/XU4BQL3Z**Note about page numbers:**

Because the original manufacturer's documents are not altered in any way, the page numbers displayed on the page may not correspond to the page number within this package.

All specifications are intended for initial planning purposes only.

Manufacturers reserve the right to change specifications at any time without notice. Always consult the installation instructions found on the manufacturer's website or included with the appliances before installation.



GE APPLIANCES
a Haier company



Model#: PYE22KYNFS

**GE Profile™ Series ENERGY STAR® 22.1
Cu. Ft. Counter-Depth French-Door
Refrigerator with Hands-Free AutoFill**

Approx Dimensions (HxDxW):
69 7/8 in X 31 1/4 in X 35 3/4 in

- Fingerprint resistant stainless - Easily wipe away smudges and fingerprints for a look that's always sparkling clean
- Counter-depth design - Offers a built-in look by fitting nearly flush with surrounding cabinetry
- Hands-free Autofill - Lets you walk away while the dispenser automatically fills any container with filtered water
- Full-width, electronic temperature-controlled drawer with LED lights - 3 accurate settings deliver the optimal temperature for your favorite foods
- Second icemaker option - Always have extra ice on hand with an optional second icemaker in the freezer (IM5D kit sold separately)
- TwinChill™ evaporators - Separate climates in the fresh food and freezer sections help keep foods fresh
- Showcase LED lighting - Positioned throughout the interior and under fresh food doors to spotlight foods inside the refrigerator and in the freezer

Warranty Information:

- Parts Warranty : Limited 1-year entire applianceLimited 5-year sealed refrigerating system
- Labor Warranty : Limited 1-year entire applianceLimited 5-year sealed refrigerating system
- Warranty Notes : See written warranty for full details

Also Available in:

PYE22KELDS - Black Slate
PYE22KMKES - Slate
PYE22KBLTS - Black Stainless

PYE22KBL/KEL/KMK/KSK/KYN

GE Profile™ Series ENERGY STAR® 22.1 Cu. Ft. Counter-Depth French-Door Refrigerator

DIMENSIONS AND INSTALLATION INFORMATION (IN INCHES)

Height to top of door (in.) A	70-1/2
Height to top of hinge (in.) B	69-7/8
Height to top of case (in.) C	69
Case depth without door (in.) D	24-3/8
Case depth less door handle (in.) E	29-3/4
Case depth with door handle (in.) F	31-1/4
Depth with fresh food door open 90° (in.) G	43-3/8
Width (in.) H	35-3/4
Width with door open 90° with door handle (in.) I	44-5/8
Width with doors open fully (in.) J	68
Min distance between side of case and wall, in either direction, to allow doors to open fully (in.) K	16-1/8
Depth with FZ door completely open (w/o handle) (in.) X	44-3/4
Depth with FZ door completely open (w/ handle) (in.) Y	46-1/4

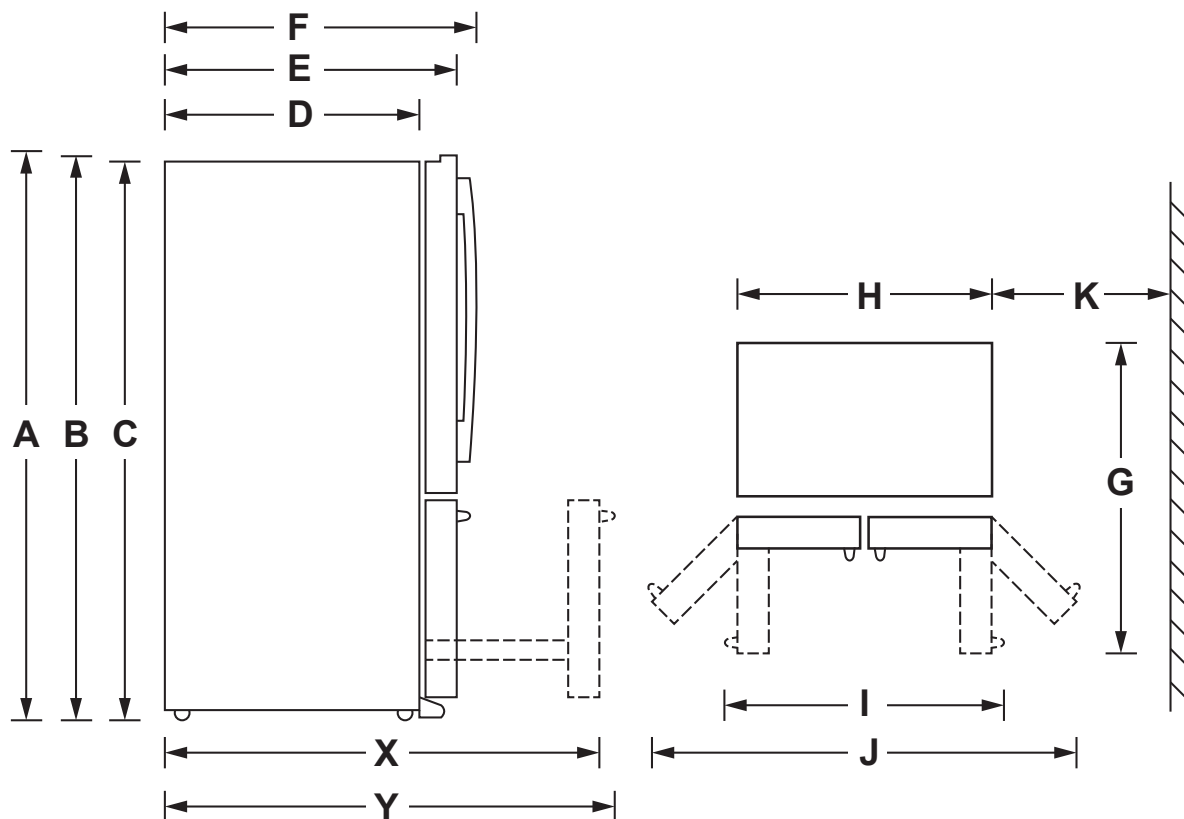

For answers to your Monogram, GE Café™ Series, GE Profile™ Series or GE Appliances product questions, visit our website at geappliances.com or call GE Answer Center® Service, 800.626.2000.



Listed by
Underwriters
Laboratories



As an ENERGY STAR® partner, GE has determined that this product meets the ENERGY STAR guidelines for energy efficiency.



GE APPLIANCES
a Haier company

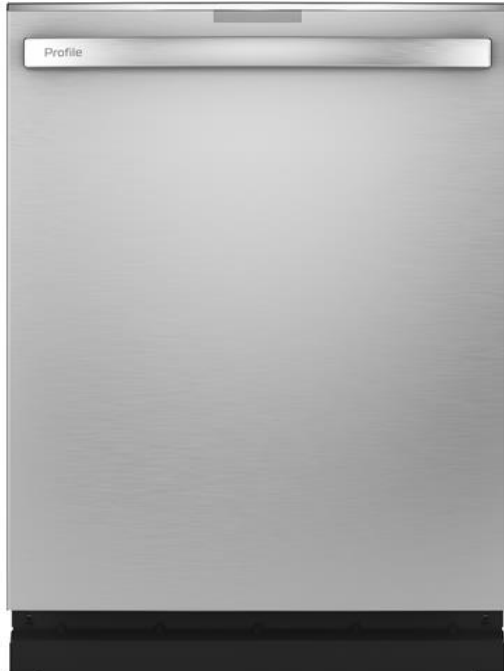

Model#: PDT715SYNFS

**GE Profile™ Stainless Steel Interior
Dishwasher with Hidden Controls**

Approx Dimensions (HxDxW):
34 in X 24 in X 23 3/4 in

- Dry Boost with Fan Assist - Use the latest in drying technology to get hard-to-dry items like plastic tumblers up to three times drier than other heated cycles can.
- Deep Clean Silverware Jets - No matter how you load your silverware basket, powerful jets blast away stuck-on food for silverware that's always spotless
- Bottle Jets - Clean hard-to-reach areas inside tall items with up to 4 dedicated jets integrated into the upper rack that shower water deep inside for the ultimate clean
- Third Rack - Now there's a place for miscellaneous items and gadgets, thanks to an additional rack at the top of the dishwasher that's ideal for plastic lids, pizza slicers and more.
- Steam + Sani - Loosens tough soils before any cycle virtually eliminating the need for soaking or pre-rinsing dishes. Plus a High-temperature rinse sanitizes and reduces 99.999% of bacteria found on dishes

Warranty Information:

- Parts Warranty : Limited 1-year entire appliance
- Labor Warranty : Limited 1-year entire appliance
- Warranty Notes : See written warranty for full details

Also Available in:

PDT715SFNDS - Black Slate
PDT715SMNES - Slate
PDT715SBNTS - Black Stainless

PDT715SBN/SFN/SMN/SYN

GE Profile™ Series Stainless Steel Interior Dishwasher with Hidden Controls

DIMENSIONS AND INSTALLATION INFORMATION (IN INCHES)

ELECTRICAL RATING

Voltage AC.....	120
Hertz.....	60
Total connected load amperage.....	6.6
Calrod® heater watts max.....	800/500

For use on adequately wired 120-volt, 15-amp circuit having 2-wire service with a separate ground wire. This appliance must be grounded for safe operation.

INSTALLATION INFORMATION: Before installing, consult installation instructions packed with product for current dimensional data.

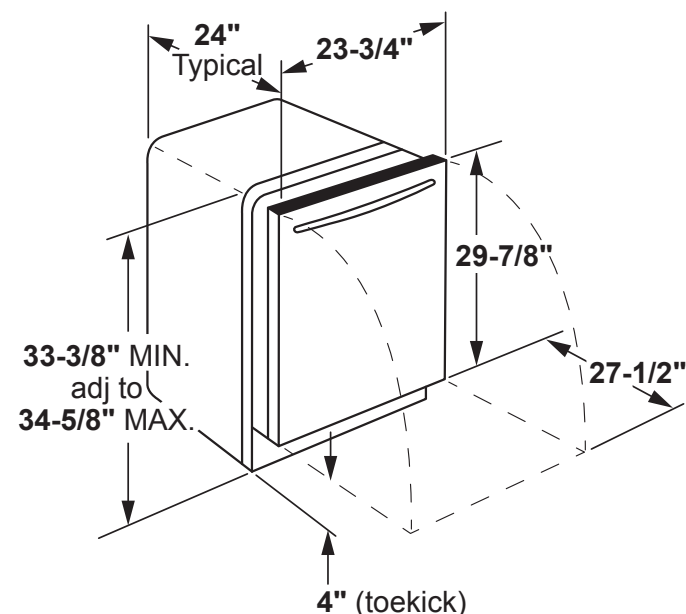
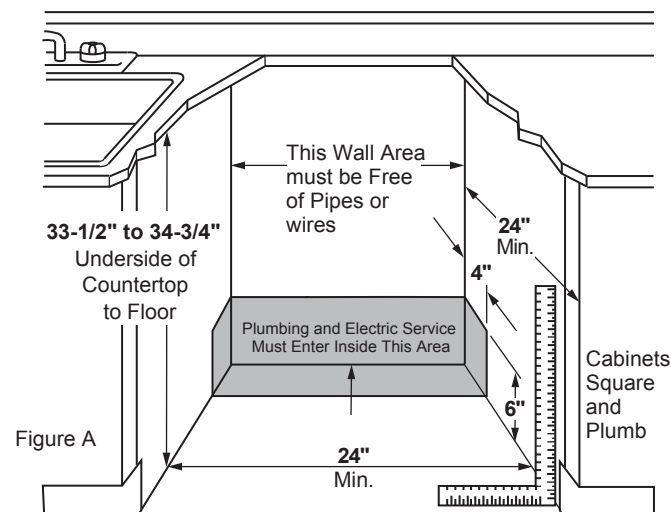

For answers to your GE Profile™ Series or GE Appliances product questions, visit our website at geappliances.com or call GE Answer Center® Service, 800.626.2000.



Listed by
Underwriters
Laboratories



As an ENERGY STAR® partner, GE has determined that this product meets the ENERGY STAR guidelines for energy efficiency.



GE APPLIANCES
a Haier company



Model#: PGB935YPFS

**GE Profile™ 30" Free-Standing Self Clean
Gas Fingerprint Resistant Range with No
Preheat Air Fry**

Approx Dimensions (HxDxW):
47 in X 29 3/4 in X 30 in

- **No Preheat Air Fry** - With this air fryer right in the oven, you can cook healthier, crispier versions of your favorite foods. There's no preheat required and it shortens the cook time because every minute counts
- **Built-in WiFi** - This smart oven features built-in WiFi so you can control oven functions with the SmartHQ app on your smart device
- **Fingerprint resistant stainless** - Easily wipe away smudges and fingerprints for a look that's always sparkling clean
- **Reversible Grill and Griddle** - This extra-large, reversible griddle and grill combination lets you enjoy the best in cooking versatility
- **True European Convection** - Enjoy consistent baking thanks to an advanced convection system that pairs a third heating element with a rear fan for a high level of precision
- **3 oven racks** - This oven features three adjustable racks for extra space in the oven

Warranty Information:

- **Parts Warranty** : Limited 1-year entire appliance
- **Labor Warranty** : Limited 1-year entire appliance
- **Warranty Notes** : See written warranty for full details

Also Available in:

PGB935BPTS - Fingerprint Resistant Black Stainless

PGB935YP/BP

GE Profile™ 30" Free-Standing Self-Clean Gas Range

DIMENSIONS AND INSTALLATION INFORMATION (IN INCHES)

Electrical Rating: 120V, 60Hz, 15A

INSTALLATION INFORMATION: Before installing, consult installation instructions packed with product for current dimensional data.

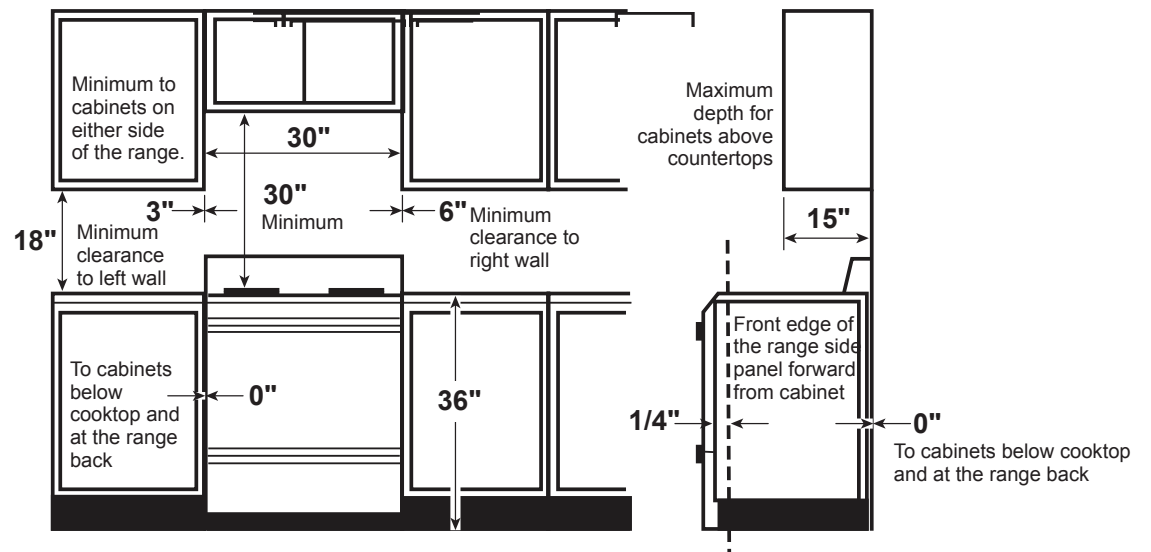
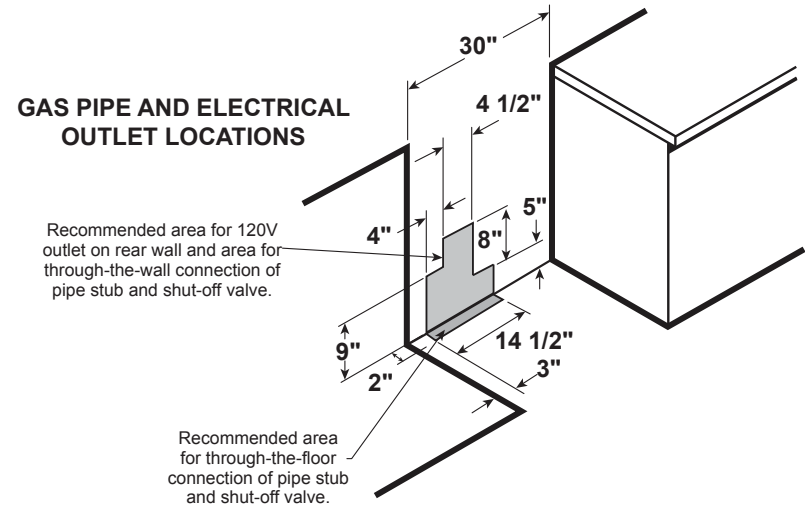
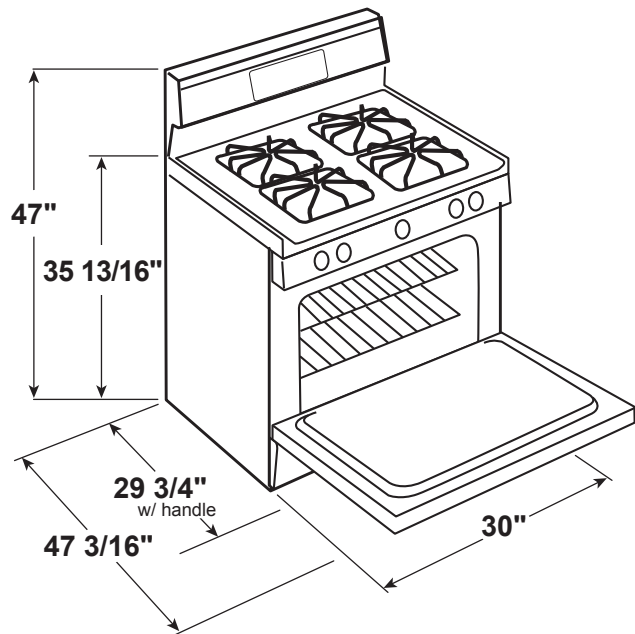

For answers to your Monogram,® GE Profile™ or GE® appliance questions, visit our website at geappliances.com or call GE Answer Center® service, 800.626.2000.



All GE ranges are equipped with an Anti-Tip device. The installation of this device is an important, required step in the installation of the range.



Specification Revised 6/20



GE APPLIANCES
a Haier company

Model#: PVM9005SJSS

**GE Profile™ 2.1 Cu. Ft. Over-the-Range
Sensor Microwave Oven**



Approx Dimensions (HxDxW):
17 5/16 in X 16 5/32 in X 29 15/16 in

- 2.1 cu. ft. capacity - 1050 Watts (IEC-705 test procedure)
- Chef Connect - Three options with a single touch. For instant convenience, choose when to automatically sync clocks and the range elements with the microwave's surface light and vent
- Bottom control with integrated handle - Enjoy a sleek appearance that makes cleaning easy
- Upfront charcoal filter with indicator light - Light indicates when odor-removing charcoal filter needs to be replaced
- Four-speed, 400CFM venting system - Removes smoke, steam and odors
- 10 power levels - Multiple power levels offer cooking flexibility
- "Add 30 seconds" button - Add 30 seconds of microwave cooking time

Warranty Information:

- Parts Warranty : Limited 1-year entire appliance
- Labor Warranty : Limited 1-year entire appliance
- Warranty Notes : See written warranty for full details

Also Available in:

PVM9005FMDS - Black Slate
PVM9005DJWW - White
PVM9005EJES - Slate
PVM9005DJBB - Black
PVM9005BLTS - Black Stainless

PVM9005SJ/EJ/BL/FM

GE Profile™ Series 2.1 cu. ft. Over-the-Range Sensor Microwave Oven

DIMENSIONS AND INSTALLATION INFORMATION (IN INCHES)

NOTE: Requires 120V grounded outlet. Electrical receptacle must be located in cabinet above microwave oven. No additional wiring, venting or cabinet rebuilding necessary in many cases. Complete detailed, easy-to-follow installation instructions and convenient full-size templates are packed with the Spacemaker microwave oven.

IMPORTANT INFORMATION: When installing the microwave oven over a range, allow minimum of 2" from bottom of microwave oven to top of range backguard to allow for removal of light covers.

VENTILATION OPTIONS: The microwave ovens are designed for adaptation to the following three types of ventilation:

- Outside exhaust (vertical – as shown)
- Outside exhaust (horizontal)
- Recirculating (non-vented ductless – see Filter Kit drawing)

INSTALLATION INFORMATION: This information is not intended to be used for installing unit described. Before installing, consult installation instructions packed with product/kit for current dimensional data.

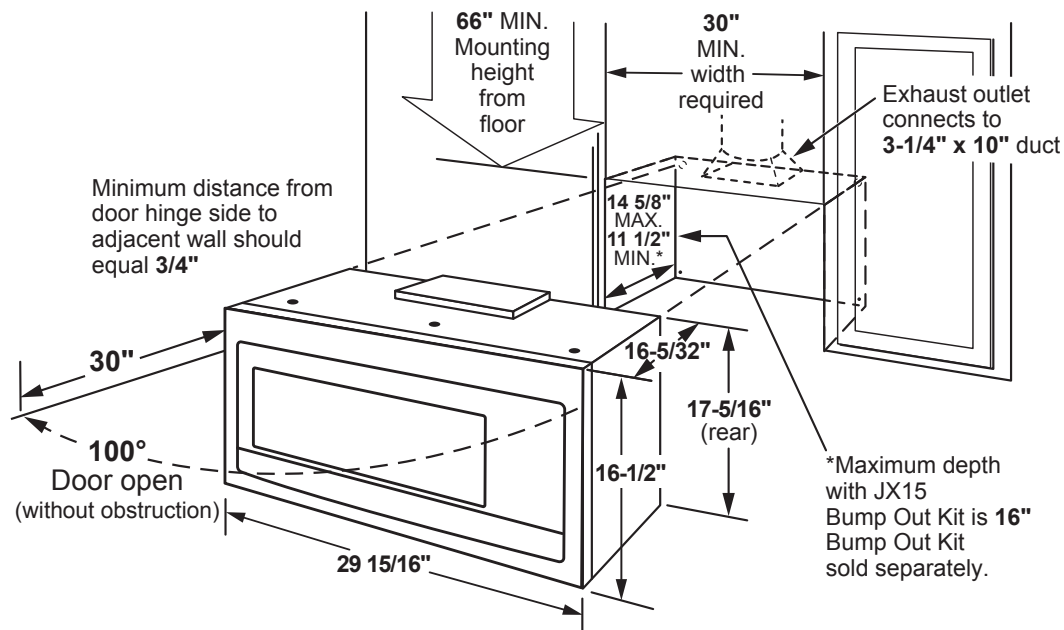

For answers to your Monogram, GE Café™ Series, GE Profile™ Series or GE Appliances product questions, visit our website at geappliances.com or call GE Answer Center® Service, 800.626.2000.



Specification Revised 10/18

PVM9005SJ/EJ/BL/FM

GE Profile™ Series 2.1 cu. ft. Over-the-Range Sensor Microwave Oven

DIMENSIONS AND INSTALLATION INFORMATION (IN INCHES)

HOOD EXHAUST DUCT: Outside ventilation requires a HOOD EXHAUST DUCT. Read the following carefully.

EXHAUST CONNECTION: The hood exhaust has been designed to mate with a standard 3-1/4" x 10" rectangular duct. If a round duct is required, a rectangular-to-round transition adaptor must be used. Do not use less than a 6" diameter duct.

REAR EXHAUST: If a rear or horizontal exhaust is to be used, care should be taken to align exhaust with space between studs, or wall should be prepared at the time it is constructed by leaving enough space between the wall studs to accommodate exhaust.

MAXIMUM DUCT LENGTH: For satisfactory air movement, the total duct length of 3-1/4" x 10" rectangular or 6" diameter round duct should not exceed 140 equivalent feet.

ELBOWS, TRANSITIONS, WALL AND ROOF CAPS, etc., present additional resistance to airflow and are equivalent to a section of straight duct which is longer than their actual physical size. When calculating the total duct length, add the equivalent length of all transitions and adaptors plus the lengths of all straight duct sections. The chart below shows the approximate feet of equivalent length of some typical ducts.

DUCT	EQUIVALENT FEET
A. Rectangular-To-round Transition Adaptor	5 ft.
B. Wall Cap	40 ft.
C. 90° Elbow	10 ft.
D. 45° Elbow	5 ft.
E. 90° Elbow	25 ft.
F. 45° Elbow	5 ft.
G. Roof Cap	24 ft.

OPTIONAL ACCESSORIES (AVAILABLE AT ADDITIONAL COST)

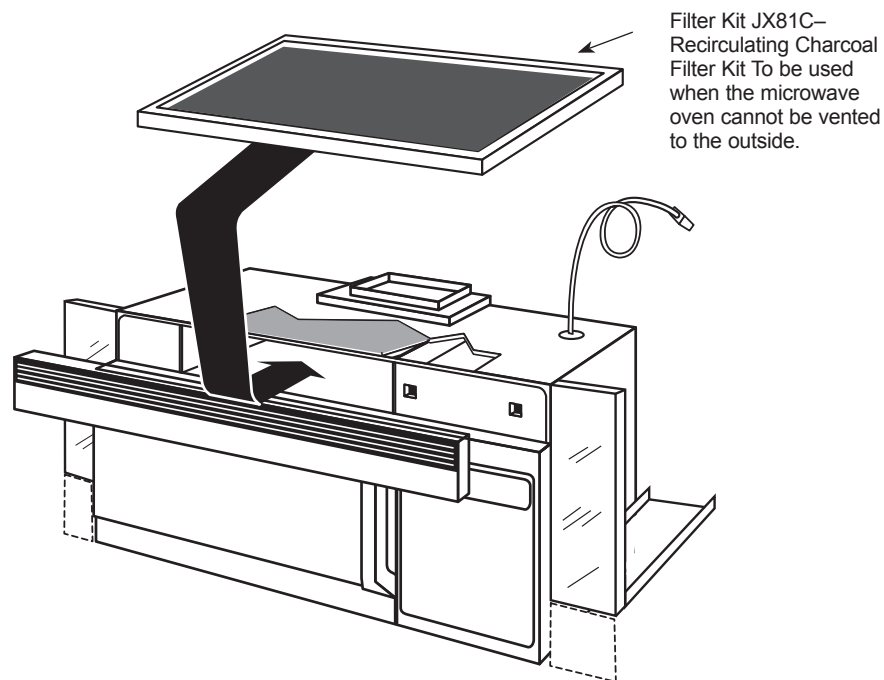

For answers to your Monogram, GE Café™ Series, GE Profile™ Series or GE Appliances product questions, visit our website at geappliances.com or call GE Answer Center® Service, 800.626.2000.



Specification Revised 10/18

LG LAUNDRY

Single Unit LG WashTower™ with Center Control™ 4.5 cu. ft. Front Load Washer and 7.4 cu. ft. Dryer

Ultra Large Capacity 4.5 cu.ft. Washer and 7.4 cu.ft. Dryer

Single Unit WashTower™ Design

Built-In Intelligence - AI Fabric Sensors/Smart Learner/Smart Pairing™

Advanced Washing & Drying - TurboWash™ 360°/Allergiene™ wash cycle/
TurboSteam™

ThinQ® Technology / Proactive Customer Care

Tempered Glass Door

Enjoy new ways to control your home with LG smart appliances

- Use the ThinQ® app to start the laundry while you're out
- Get alerts when the cycle is finished
- With Smart Pairing™, the washer can tell the dryer to select a compatible drying cycle

LG ThinQ®



AVAILABLE COLORS



SUMMARY	Washer	Dryer
Type	Front Load Washer	Front Load Dryer
Capacity (cu.ft.)	4.5 cu. ft.	7.4 cu. ft.
Color	Black Steel (B), White (W)	
APPEARANCE	Washer	Dryer
Hard Buttons	Yes	
Touch Buttons	Yes	
Full Touch Electronic Control Panel with LED Display	Yes	
Unified Center Control	Yes	
Reversible Door	No	
ENERGY	Washer	Dryer
ENERGY STAR® Qualified	Yes	
CEE Tier	Tier2	-
IMEF	2.92	-
IWF	2.9	-
CEF	-	Electric: 3.94 Gas: 3.49
PROGRAMS	Washer	Dryer
No. of Programs	6	6
	Normal, Bedding, Delicates, Heavy Duty, Speed Wash, Downloaded	Normal, Bedding, Delicates, Heavy Duty, Speed Wash, Downloaded
OPTIONS	Washer	Dryer
No. of Options	10	9
	TurboWash®, Steam, Extra Rinse, Pre-wash, Sanitary, Tub Clean, Drum Light, Child Lock, Signal, Wi-Fi / Remote Start	Wrinkle Care, TurboSteam™, Reduce Static, Energy Saver, Steam Fresh*, Drum Light*, Child Lock*, Signal*, Wi-Fi* / Remote Start*
DETAILS	Washer	Dryer
No. of Wash/Rinse Temps	5	-
Wash/Rinse Temps	Hot, Warm/Hot, Warm, Cold/Warm, Cold	-
No. of Spin Speeds	5	-
Spin Speeds	High, Medium/High, Medium, Low, No Spin	-
Max RPM	1300	-
Water Levels	Load Sensing	-
No. of Soil Levels	5	-
Temperature Settings	-	High, Medium/High, Medium, Low/Medium, Low

Drying Levels	-	Very, More, Normal, Less, Damp
Manual Dry Times	-	60 min., 50 min., 40 min., 30 min., 20 min.
FABRIC CARE FEATURES	Washer	Dryer
AI DD	Yes	-
TurboWash™ 360 Technology	Yes	-
Steam Technology	Yes	-
Allergiene™ Cycle	Yes	-
Sanitary Cycle	Yes	-
SenseClean™ System	Yes	-
AI Dry	-	Yes
Sensor Dry	-	Yes
Precise Temperature Control with Variable Heater	-	Yes
Steam Technology	-	Yes (TurboSteam™)
CONVENIENCE FEATURES	Washer	Dryer
TrueBalance™ Anti-Vibration System	Yes	-
4 Tray Dispenser	Prewash, Main Wash (with liquid detergent cup), Bleach, Fabric Softener	-
LoDecibel™ Quiet Operation	Yes	-
End of Cycle Signal	Yes	-
LoadSense	Yes	-
Child Lock	Yes	-
Auto Suds Removal	Yes	-
Leveling Legs	4 Adjustable Legs	-
Easy Loading TilTub™	Yes	-
Drum Light	Yes	-
Remaining Time Display/Status Indicator(s)	Yes	-
3 Minute Installation Check	-	Yes
LoDecibel™ Quiet Operation	-	Yes
End of Cycle Signal	-	Yes
Drum Light	-	Yes
FlowSense™ Duct Clogging Indicator	-	Yes
Wrinkle Care Option	-	Yes
Child Lock	-	Yes
Venting Option	-	Electric: 3 Way Venting / Gas: 2 Way Venting
4 Adjustable Legs	-	Yes
Remaining Time Display/Status Indicator(s)	-	Yes

ThinQ® TECHNOLOGY	Washer	Dryer
SmartDiagnosis™ (v3.0)		Yes
Wi-Fi		Yes
Remote Start and Cycle Monitor		Yes
Energy Monitoring	Yes	
Tub Clean Coach	Yes	-
MOTOR AND AGITATOR	Washer	Dryer
Motor Type	Inverter Direct Drive Motor	-
Axis	Horizontal	-
MATERIALS AND FINISHES	Washer	Dryer
NeveRust™ Stainless Steel Drum	Yes	-
Cabinet	PCM	-
Control Panel	Plastic	-
Top Plate	Painted	-
NeveRust™ Stainless Steel Drum	-	Yes
Tub Rear	-	Painted
CERTIFICATION	Washer	Dryer
AAFA	Yes	-
POWER SOURCE	Washer	Dryer
Ratings	UL Listed	-
Electrical Requirements	120V, 10 Amps	-
Type	Electric	-
Ratings	-	CSA Listed
		120V, 15 Amps (Gas)
Electrical Requirements	-	240V 30 Amps (Electric)
Type	-	Gas / Electric
BTU Rating	-	10,000 Feet
LP Conversion Kit	-	383EEL3002D / LPK1
Side Venting Kit	-	3911EZ9131X
DIMENSIONS	Washer	Dryer
Product (WxHxD)	27" x 74 3/8" x 30 3/8"	
Depth with Door Open	55" D with door open	
Carton (WxHxD)	30 1/16" x 79 11/32" x 32"	
Weight (Product/Carton)		Electric: (326 lb / 361 lb) Gas: (329 lb / 364 lb)
LIMITED WARRANTY	Washer	Dryer
Parts and Labor	1 Year	1 Year
Direct Drive Motor	10 Years	-
Drum	3 Years	3 Years
UPC CODES	Washer	Dryer
WKEX200HBA (Black Steel)	048231028486	
WKGX201HBA (Black Steel)	048231029254	
WKEX200HWA (White)	048231028462	
WKGX201HWA (White)	048231029261	

⚠ WARNING

- Read all installation instructions completely before installing and operating the appliance. It is important that you review this entire manual before installing and using the appliance. Detailed instructions concerning electrical connections and additional requirements are provided on the following pages.
- Moving or installation of the appliance requires two or more people. Failure to follow these instructions may result in injury.
- Store and install the appliance where it will not be exposed to temperatures below freezing or exposed to outdoor weather conditions. Failure to follow this warning can cause product or part failure, serious injury, fire, electric shock, or death.
- Properly ground the appliance to conform with all governing codes and ordinances. Failure to follow this warning can cause serious injury, fire, electric shock, or death.
- To ensure proper airflow, do not block the large opening on the bottom of the appliance with carpeting or other materials.
- Do not remove the ground prong from the power cord. Do not use an adapter or extension cord. Plug into a grounded 3-prong outlet. Failure to follow this warning can cause serious injury, fire, electric shock, or death.
- Certain internal parts are intentionally not grounded and may present a risk of electric shock only during servicing. Service personnel- Do not contact the following parts while the appliance is energized: pump, valve, motor, control board.

Choosing the Proper Location

Check the following requirements for the install location before installing the appliance.

- Allow for sufficient space between the walls and the appliance for installation.
- Make sure that the floor is clean, dry and free of dust, dirt, water and oil so the leveling feet cannot slide easily. Leveling feet that can move or slide on the floor can contribute to excess vibration and noise.
- If the floor has too much flex, reinforce it to make it more rigid. If the floor is not solid, it may cause severe vibration and noise.
- If a drain pan must be used, take extra care to follow the instructions provided with the drain pan and make sure the leveling feet are adjusted for firm and even contact with the pan. Use of drain pans and failure to properly level the appliance may result in increased vibration and noise during operation.

Flooring

- To minimize noise and vibration, install the washer on a level, solidly constructed floor capable of supporting the appliance without flexing or bouncing.
- The appliance must be installed on firm flooring to minimize vibration during the spin cycle.

Concrete flooring is best, but a wood floor is sufficient, provided it is built to FHA standards.

- The floor under the appliance must not slope more than **1 inch (2.5 cm)** from front to back or side to side.
- Installing on carpeting and soft tile surfaces is not recommended.
- Never install the appliance on a platform or weakly supported structure.

Floor Installation

To ensure sufficient clearance for water inlet hoses, drain hose and airflow, allow minimum clearances of at least **1" (2.5 cm)** at the sides and **4" (10 cm)** behind the appliance. Be sure to allow for wall, door, or floor moldings that may increase the required clearances.

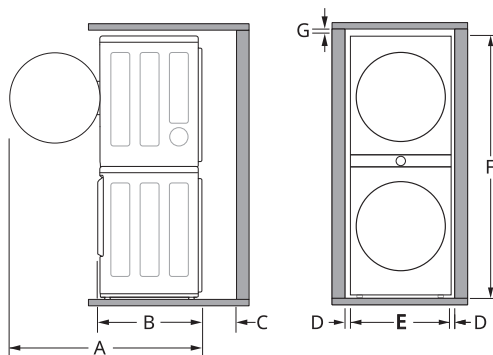

Dimensions and Clearances	
A	55" (139.6 cm)
B	30 3/8" (77 cm)
C	4" (10 cm)
D	1" (2.5 cm)
E	27" (70 cm)
F	74 3/8" (189 cm)
G	4" (10 cm)

Exhaust

- A location that allows for proper exhaust installation. A gas dryer must be exhausted to the outdoors.

Power Outlet

- The power outlet must be within **60 inches (1.5 m)** of either side of the appliance.
- Position the appliance so that the outlet and plug are easily accessible.
- Do not overload the outlet with more than one appliance.
- The outlet must be grounded in accordance with current electrical wiring codes and regulations.
- Use a time-delay fuse or circuit breaker.
- It is the personal responsibility and obligation of the appliance owner to have a proper outlet installed by a qualified electrician.

NOTE

- Check code requirements that limit, or do not permit, installation of the appliance in garages, mobile homes or sleeping quarters. Contact your local building inspector.

Clearances

The following clearances are recommended for the appliance.

- Additional clearances should be considered for ease of installation and servicing.
- Additional clearances should be considered on all sides of the appliance to reduce noise transfer.

Installation spacing for Recessed Area or Closet Installation

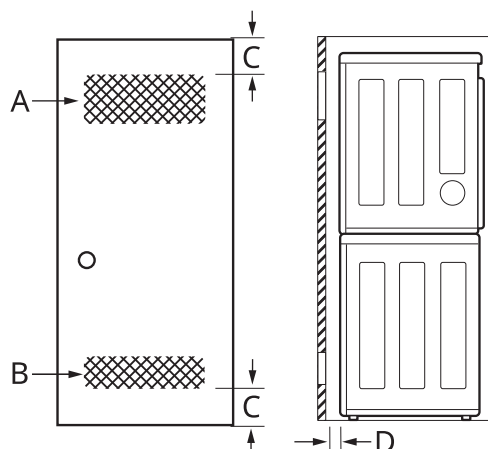

Description	Dimension/Clearance
A: Upper Ventilation Opening	48 sq. in. (310 cm ²)
B: Lower Ventilation Opening	24 sq. in. (155 cm ²)
C: Distance to Ventilation Opening	3" (76 mm)
D: Front Clearance	4" (100 mm)

Closet Ventilation Requirements

Closets with doors must have both an upper and lower vent to prevent heat and moisture buildup in the closet. One upper vent opening with a minimum opening of 48 sq. in. (310 cm²) must be installed no lower than 6 feet above the floor. One lower vent opening with a minimum opening of 24 sq. in. (155 cm²) must be installed no more than one foot above the floor. Install vent grills in the door or cut down the door at the top and bottom to form openings. Louvered doors with equivalent ventilation openings are also acceptable.

NOTE

- There should be at least a little space around the appliance (or any other appliance) to eliminate the transfer of vibration from one appliance to another. If there is enough vibration, it could cause appliances to make noise or come into contact, causing paint damage and further increasing noise.
- No other fuel-burning appliance can be installed in the same closet as an appliance.

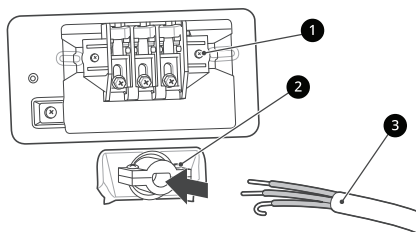

- 1 Terminal block
- 2 UL-listed strain relief
- 3 UL-listed 3-wire power cord

- 5 Attach the two hot leads (black and red) of the power cord to the outer terminal block screws.
- 6 Attach the neutral (white) wire to the center terminal block screw.
- 7 Connect the external ground (if required by local codes) to the green ground screw.
- 8 Tighten all screws securely.
- 9 Reinstall the terminal block access cover.

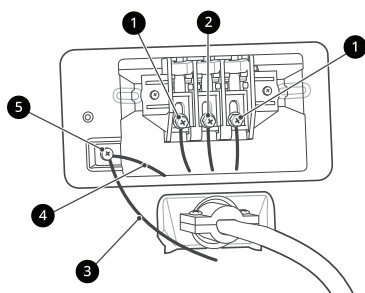

- 1 Hot lead (black and red)
- 2 Neutral wire (white)
- 3 External ground wire (if required by local codes)
- 4 Wire from the appliance harness
- 5 Ground screw (green)

Installing the Dryer Side Vent Kit

The appliance is configured to vent to the rear. It can also vent to the side.

⚠ WARNING

- Use long-sleeved gloves and safety glasses.
- Use a heavy metal vent.
- Do not use plastic or thin foil ducts.
- Clean old ducts before installing the appliance.

NOTE

- An adapter kit, part number 383EEL9001B, may be purchased from your LG retailer. This kit contains duct components necessary to change the appliance vent location.
- Right-side venting is not available on gas models.
- Bottom venting is not available on stacked or integrated stacked models.

Side Venting

- 1 Remove the rear exhaust duct retaining screw 1 and pull out the exhaust duct 2.

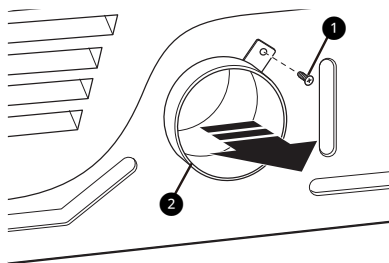

- 2 Press the tabs on the knockout 3 and carefully remove the knockout for the desired vent opening. (Right-side venting is not available on gas models.) Press the adapter duct 4 onto the blower housing and secure to the base of the dryer as shown.

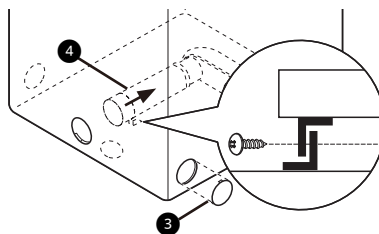

- 3 Preassemble a 4" (10 cm) elbow 5 to the next 4" (10 cm) duct section, and secure all joints with duct tape. Be sure that the male end of the elbow faces AWAY from the dryer. Insert the elbow/duct assembly through the side opening and press it onto the adapter duct. Secure it in place with duct tape. Be sure that

the male end of the duct protrudes **1 1/2" (3.8 cm)** to connect the remaining ductwork. Attach the cover plate **6** to the back of the dryer with the included screw.

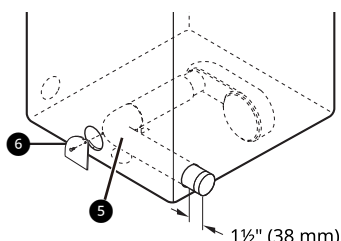

- Do not exceed the recommended duct length limitations noted in the chart. Failure to follow these instructions may result in extended drying times, fire or death.
- Do not crush or collapse ductwork.
- Do not allow ductwork to rest on or contact sharp objects.
- If connecting to existing ductwork, make sure it is suitable and clean before installing the dryer.
- Venting must conform to local building codes.
- Use only 4 " (10 cm) rigid, semi-rigid or flexible metal ductwork inside the dryer cabinet and for venting outside.
- The exhaust duct must be 4 " (10 cm) in diameter with no obstructions. The exhaust duct should be kept as short as possible. Make sure to clean any old ducts before installing your new dryer.
- Rigid, semi-rigid or flexible metal ducting is recommended for use between the dryer and the wall. All non-rigid metal transition duct must be UL-listed. Use of other materials for transition duct could affect drying time.
- Ductwork is not provided with the dryer. You should obtain the necessary ductwork locally. The vent hood should have hinged dampers to prevent backdraft when the dryer is not in use.
- The total length of flexible metal duct must not exceed 8 ft. (2.4 m).

Venting the Dryer

⚠ WARNING

- Gas dryers **MUST** exhaust to the outdoors.
- **DO NOT** use sheet metal screws or other fasteners which extend into the duct that could catch lint and reduce the efficiency of the exhaust system. Secure all joints with duct tape.
- To reduce the risk of fire, combustion, or accumulation of combustible gases, **DO NOT** exhaust dryer air into an enclosed and unventilated area, such as an attic, wall, ceiling, crawl space, chimney, gas vent, or concealed space of a building.
- To reduce the risk of fire, **DO NOT** exhaust the dryer with plastic or thin foil ducting.

Ductwork

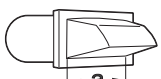
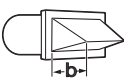
Wall Cap Type	Number of 90° Elbows	Maximum length of 4-inch diameter rigid metal duct
Recommended   a: 4 " (10 cm)	0	65 ft. (19.8 m)
	1	55 ft. (16.8 m)
	2	47 ft. (14.3 m)
	3	36 ft. (11.0 m)
	4	28 ft. (8.5 m)
Use for only short run installations  b: 2 1/2 " (6.4 cm)	0	55 ft. (16.8 m)
	1	47 ft. (14.3 m)
	2	41 ft. (12.5 m)
	3	30 ft. (9.1 m)
	4	22 ft. (6.7 m)

NOTE

- Deduct 6 ft. (1.8 m) for each additional elbow. Do not use more than four 90° elbows.

24 INSTALLATION

- 3** Use the provided tie strap **2** to secure the drain hose in place.

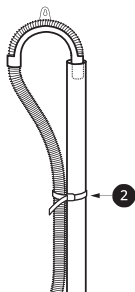

- 4** If the water valves and drain are built into the wall, fasten the drain hose to one of the water hoses with the provided tie strap **3** (ribbed side on inside).

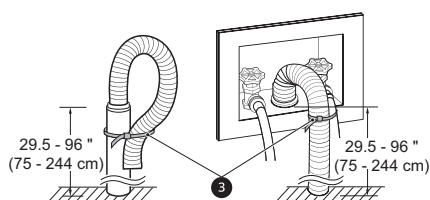

Using the Laundry Tub to Drain

- 1** Clip the end of the hose into the elbow bracket.
- Connect the elbow bracket **1** within **4 inches (10 cm)** of the end of the drain hose. If the drain hose is extended more than **4 inches (10 cm)** beyond the end of the elbow bracket, mold or microorganisms could spread to the inside of the washer.

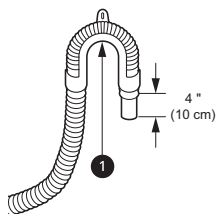

- 2** Hang the end of the drain hose over the side of the laundry tub.

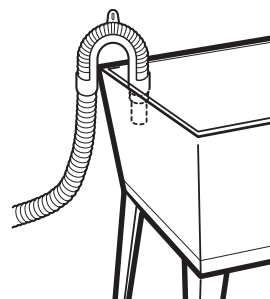

- 3** Use the provided tie strap to secure the drain hose in place.

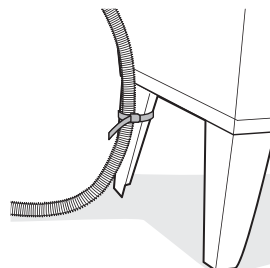

Leveling the Appliance

The drum of the washer spins at very high speeds. To minimize vibration, noise, and unwanted movement, the floor must be a solid, level surface.

CAUTION

- Using the appliance without leveling it may cause excess vibration and noise, leading to an appliance malfunction.
- Adjust the leveling feet only as far as necessary to level the appliance. Extending the leveling feet more than necessary can cause the appliance to vibrate.

NOTE

- Before installing the appliance, make sure that the floor is clean, dry and free of dust, dirt, water and oil so the appliance feet cannot slide easily. Feet that move or slide on the floor can contribute to excessive vibration and noise.

How to Level the Appliance

- 1** Position the appliance in its final location.
- Take special care not to pinch, strain, or crush the water and drain hoses. If you have a carpenter's level **1**, you can use it to check that the appliance is level. The slope